

Pittsburg County, Oklahoma
COUNTY PURCHASING OFFICE
 Pittsburg County Court House
 McAlester, Oklahoma
 Phone: (918) 423-4934

INVITATION TO BID

PLEASE REVIEW TERMS AND CONDITIONS ON REVERSE SIDE RELATING TO SUBMISSION OF THIS BID.

Notarized Affidavit completions and signature required on reverse side.

DATE ISSUED	5-Mar-12
PAGE 1 OF _____	

BID NUMBER Bid # 17	BID CLOSING DATE AND HOUR March 19, 2012 @ 10:00AM	REQUIRED DELIVERY DATE <small>Days after award of Purchase Order</small>
TERMS:		DATE OF DELIVERY:

Item	Quantity	Unit of issue	DESCRIPTION	Unit Price	Total
			<p>Pittsburg County wishes to advertise for the following for the Haywood-Arpelar Volunteer Fire Department, to be purchased with REAP funds and sales tax dollars:</p> <p>One (1) new skid unit</p> <p>See Specifications Attached</p>		

TERMS AND CONDITIONS

1. Sealed bids will be opened in the Commissioner's Conference Room, Pittsburg County Courthouse, McAlester, Oklahoma, at the time and date shown on the invitation to bid form.
2. Late bids will not be considered. Bids must be received in sealed envelopes (one to an envelope) with bid number and closing date written on the outside of the envelope.
3. Unit prices will be guaranteed correct by the bidder.
4. Firm prices will be F.O.B. destination.
5. Purchases by Pittsburg County, Oklahoma, are not subject to state or federal taxes.
6. This bid is submitted as a legal offer and any bid when accepted by the County constitutes a firm contract.
7. Oklahoma laws require each bidder submitting a bid to a county for goods or services to furnish a notarized sworn statement of non-collusion. A form is supplied below.
8. Bids will be firm until delivered.

(DATE)

AFFIDAVIT: I, the undersigned, of lawful age, being first duly sworn on oath say that he (she) is the agent authorized by the bidder to submit the above bid. Affiant further states that the bidder has not been a party to any collusion among bidders in restraint of freedom of competition by agreement to bid at a fixed price or to refrain from bidding; or with any state official or employee as to quantity; quality or price in the prospective contract or any other terms of said prospective contract; or in any discussions between bidders and any state official concerning exchange of money or other thing of value for special consideration in the letting of a contract; that the bidder/contractor has not paid, given or donated or agreed to pay, give or donate to any officer or employee of the State of Oklahoma (or other entity) any money or other thing of value, either directly or indirectly in the procuring of the award of a contract pursuant to this bid.

Subscribed and sworn before this _____ day
of _____ 2011 _____ (seal)

Firm: _____

My commission expires _____ Signed by: _____ Title: _____
(MANUAL SIGNATURE OF UNDERSIGNED)

NOTARY PUBLIC (CLERK OR JUDGE) Address: _____ Phone: _____

City: _____ State _____

Zip _____

NOTE: Other terms and conditions can be added at the discretion of the county officers.

RESOLUTION

To
Advertise

The Board of County Commissioners, Pittsburg County, met in regular session on Monday, March 5, 2012.

WHEREAS, the Board of County Commissioners wishes to advertise for the following for the Haywood-Arpear Volunteer Fire Department, to be purchased with REAP funds and sales tax dollars:

One (1) new skid unit

A bid package containing complete specifications and an "Invitation to Bid" are available at the Pittsburg County Clerk's Office, 115 E. Carl Albert Parkway, Room 103, McAlester, OK 74501 or online at pittsburg.okcounties.org.

THEREFORE, each competitive bid submitted to the county must be accompanied with an affidavit for filing with the competitive bid form, as required by 61 O.S. § 138.

Sealed bids will be received and filed with the Pittsburg County Clerk and opened on Monday, March 19, 2012 at 10:00 a.m. in the conference room of the Board of County Commissioners, Pittsburg County Courthouse, 115 E. Carl Albert Parkway, McAlester, Oklahoma. Contract will be awarded to the lowest or best bidder. The Board of County Commissioners, Pittsburg County, reserves the right to reject all bids and re-advertise.

BOARD OF COUNTY COMMISSIONERS
PITTSBURG COUNTY, OKLAHOMA



GENE ROGERS, Chairman



KEVIN SMITH, Member



RONNIE YOUNG, Vice-Chairman

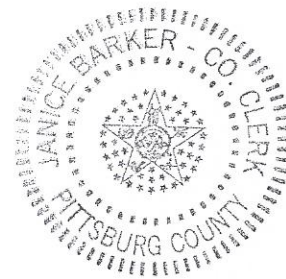

ATTEST:



JANICE BARKER, County Clerk

HAYWOOD-ARPELAR
FIRE DEPARTMENT
SPECIFICATIONS for SKID UNIT

Length available for the skid see attached plan.

Tank

The tank shall have a capacity of 400 gallons manufactured UPF.

The tank shall include the following features:

- 1.Fill Tower with removable screen located on top of the tank.Shall be 8 inches x 8 inches
- 2.Sump with anti-swirl plate and drain fitting.
- 3.Vent and overflow pipe.
4. 1" refill fitting.(MINIMUM)
- 5.3.0" tank suction.
6. Liquid level sight gauge @ left rear.
- 7.NFPA BAFFLES

NOTE:Tank may be constructed to conform to bed ,control panel and skid specifications.
The outside of the tank shall be black.

A 12 gallon integral foam tank shall be provided with the fill tower on the top of tank.
The foam cell shall be provided with a drain valve.

There shall be a FRC Products LED tank level indicator located on the top mount panel.
(Or equivalent to)

The tank shall have a lifetime warranty. A copy of the warranty shall be provided to the Fire Department.

HOSE REEL

ONE HANNAY 1" Hose Reel(EF 24-23-24 RT) with 100FT OF 1"Redline mounted on bed and may be mounted on either side of the bed that best fits the truck.(steel, red in color)
(Or equivalent to)

ONE HANNAY ½" HOSE REEL with 200FT OF ½" SPIRALITE 560 PSI HOSE mounted on bed and my be mounted on either side of the bed that best fits the truck.((steel, red in color)(Or equivalent to)

SKID

The tank shall be mounted to a heavy duty aluminum skid. The tank shall have under tank mounting system allowing the tank to be mounted to the skid at the front and rear of the tank.

The skid shall also incorporate angled cradle supports at the four corners of the skid to eliminate any movement of the tank.

Pump platform shall have a .125 aluminum diamond plate overlay.

PUMP /MOTOR

The pump shall be a Hale HPX100-B18 or equivalent to powered by a 18 hp briggs and Stratton gasoline engine with the following features:

- A.2.5" intake
 - B.2.5" discharge
 - C.Electric start
 - D.2.5" master gauge
 - F. Exhaust Primer
 - G. Low oil pressure light
- Or equivalent to

The pump shall be located at the rear of the apparatus, mounted on the aluminum skid.

The fuel supply shall be a tank (DOT APPROVED) supplied with the skid, plumbed to the engine and mounted with easy access FOR REFUELING.

PUMP PANEL and PLUMBING

The pump panel will contain all the pump controls, will be front mounted in cross-walk. Start/Stop switch, Idle control, Choke, Oil Pressure light and Pump outlet pressure gauge. The pump panel will also contain the foam proportioner controls. The panel will be tilted to provide a direct view of all operations.

All plumbing will be stainless steel pipe or high-pressure hose. All discharges will originate from a manifold made from 2.5 inch stainless pipe.

All pressure valves shall be swing out quarter turn style. Each valve will have a black knob and will be legibly marked and color coded.

All 1.5 inch valves will be located within the pump panel. The pump panel shall contain 6-1.5 inch apparatus style control valves in the following order from passenger's side to driver's side: Passenger side whip line, tank fill, passenger side hose reel, 1.5 inch attack line, driver side hose reel and driver side whip line. The passenger side .5 inch hose reel may be plumbed off of the driver's side hose reel but needs to have quarter turn valve to isolate water flow to the .5 inch reel.

Pump must be plumbed for a 2.5 rear discharge and Pump must be plumbed to allow for drafting operations.

All intakes and discharges must have chrome fittings and chrome caps or plugs with chains.

FOAM SYSTEM

A Foam Pro 1600 Class A foam injection system shall be provided and will be plumbed to the manifold to provide foam to all discharges, excluding the rear discharge.

The unit shall be plumbed in a manner that foam will not enter the water tank.

The control panel will be located on the pump panel.

The foam system shall be mounted on the skid and protected by a aluminum hinged diamond plate cover. May be mounted inside Alum box.(passenger side)

(Or equivalent to)

Storage Compartments

On both sides of the apparatus there will be a compartment approximately 54 inches long x 32 inches tall x 22 inches deep .Driver side box shall come with Aluminum shelf. Passenger side box will not have a shelf. Both box's shall have roll up doors with seals ,be of sweep out design and have Led strip lighting that shall come on when doors are opened. The 1.5 inch hose bed shall be of aluminum construction and mounted on top of box's on truck bed.(May be either side so it can match up with plumbing from manifold.

ELECTRICAL

Wire led lights that are inside the aluminum boxes.

All wiring exposed to weather shall be installed with protective wire womb.

All hose reel's shall be installed with proper manuel circuit breakers and rewind switches.

LED Work lights will be installed in the traverse crosswalk area, the pump area, the pump panel area, and in any working area that is not illuminated otherwise.

WATER LEVEL INDICATOR

A FRC products LED light water level gauge will be installed in the pump panel and an auxiliary LED light gauge will be installed in the cab to monitor the water level in the tank. (Or equivalent to)

AUTO-EJECT AND CHARGING SYSTEM

A Kausmaul Auto-Eject system along with a Kausmaul battery charger shall be installed in the unit to supply battery recharging capabilities and charging for portable radio's and flashlights as needed.(Or equivalent to)

BATTERY DISCONNECT

A master cutoff solenoid controlled by the truck ignition switch will shutoff power to all electrical equipment that was not furnished originally on the cab chassis. This way the driver does not have to remember to turn disconnect on or off. This disconnect does not affect the cab-chassis as delivered from factory.

NOZZLES

3-DQS40P 1INCH TFT NOZZLES

1-WAND TYPE FOR .5 INCH NOZZLE (field repairable with quick disconnect)

1-FQS125P 1.5 INCH TFT NOZZLE

All nozzles shall be American made

(Or equivalent to)

Nerf Bars

Black Stainless Steel Nerf Bars will be installed on the cab to provide access to the cab.

OPTIONS

Price to pick-up truck and deliver BACK to fire dept.

REQUIREMENTS

BUILDER SHALL INCLUDE ALL WARRANTY INFORMATION WITH UNIT.

BUILDER SHALL INCLUDE ALL MAINTENANCE AND PARTS MANUALS WITH UNIT.

INFORMATION

All items listed with brand names are to be used or the equivalent of the same quality.

Date of delivery must be no later than May 15, 2012.

This unit is to be paid with funds from a Reap Grant and County Tax Dollars.

Purchase Orders will be acquired at time of bid awarding, but payment will not be made until all bid requirements have been met and invoices turned in to the purchasing agent of Pittsburg County.

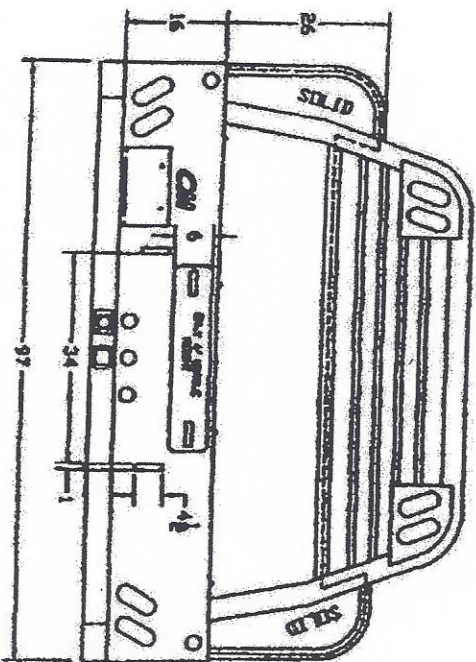
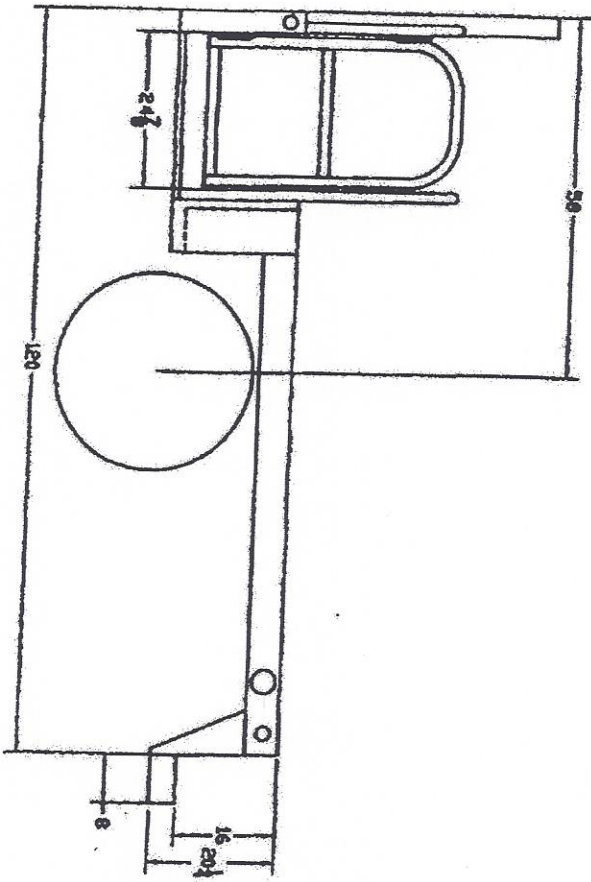
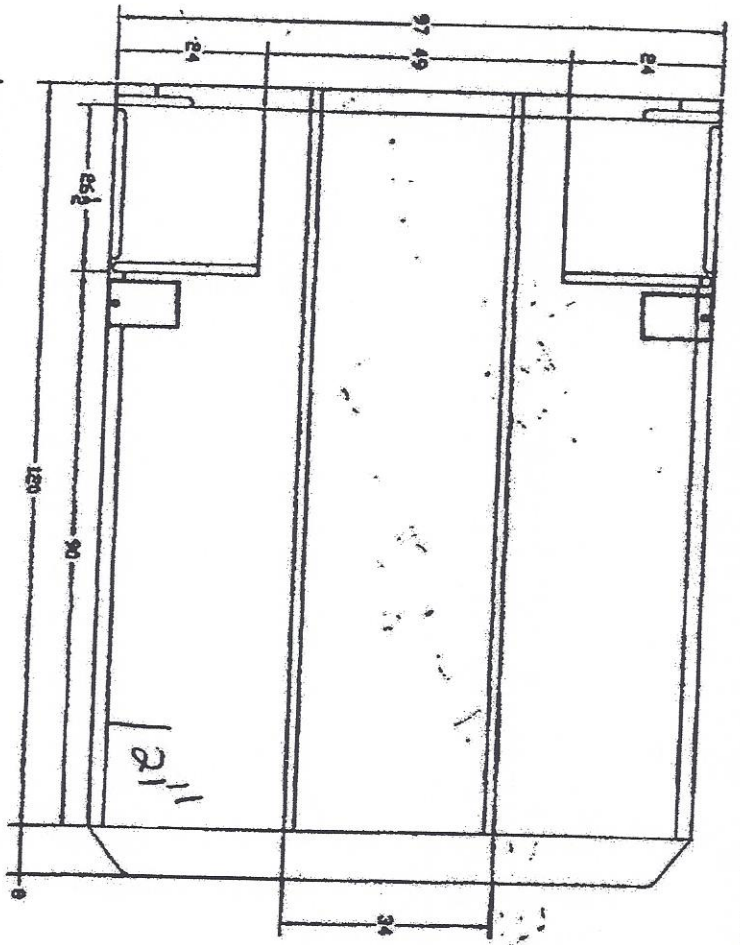

*Handwood - anpelan
Bunah Bed*