

BOARD OF COUNTY COMMISSIONERS
PITTSBURG COUNTY, OKLAHOMA

FILED

DATE: AUGUST 8, 2022

TIME: 9:00 A.M.

PLACE: COUNTY COMMISSIONERS CONFERENCE ROOM
PITTSBURG COUNTY COURTHOUSE
115 EAST CARL ALBERT PARKWAY
MCALESTER, OKLAHOMA

AUG 05 2022

AM
PM

TIME 8:45
HOPE TRAMMELL COUNTY CLERK
PITTSBURG COUNTY

BY _____ DEPUTY

NOTE: FOR COPIES OF ITEMS ON THIS AGENDA, PLEASE CONTACT OUR OFFICE AT 918-423-1338 AND WE WILL BE HAPPY TO EMAIL THEM TO YOU.

****CONSIDERATION, DISCUSSION AND POSSIBLE ACTION TO BE TAKEN ON THE FOLLOWING LISTED ITEMS ON THE AGENDA****

1. CALL MEETING TO ORDER
2. ROLL CALL:
KEVIN SMITH - CHAIRMAN
CHARLIE ROGERS - VICE-CHAIRMAN
ROSS SELMAN - MEMBER
3. APPROVAL OF AGENDA
4. APPROVE/DISAPPROVE MEETING MINUTES
 - A. Regular Meeting Minutes from August 1, 2022
5. RECOGNITION OF GUESTS/PUBLIC COMMENTS
Persons addressing the Board should state their name and address for the record and will be limited in duration at the discretion of the Chairman. Comments are limited to items of the agenda.
6. OFFICIALS - DEPARTMENT REPORTS
 - A. BOCC
 - i. Juvenile Detention Center Report for July, 2022

7. FISCAL TRANSACTIONS

- A. CLAIMS AND PURCHASE ORDERS
- B. TRANSFERS
- C. OFFICIAL'S MONTHLY REPORTS
- D. BLANKET PURCHASE ORDERS
- E. FUEL BIDS

8. UNFINISHED BUSINESS

- A. Approve/Disapprove Pay Application No. 5 to Martin Roofing for the Expo Center Roof Project, Project No. ARPA-21.004

9. AGENDA ITEMS

- A. Resolution 23-020 to Advertise for Bids, Labor and Materials to Install Eight (8) County-supplied, 25 Ton HVAC Units at the Southeast Expo Center
- B. Resolution 23-021 to Cancel Purchase Order – Sheriff
- C. Approve/Disapprove Pay Application No. 06 to Trane US, Inc. for the HVAC Replacement Project at the Pittsburg County Jail, Project No. ARPA-21.002
- D. Re-Award Six Month Bid for Plastic Pipe

10. NEW BUSINESS

- A. Consideration and Possible Action with respect to any other matters not known about or which could not have been foreseen prior to posting this agenda.

II. ROAD CROSSING PERMIT

- A. 23.007, Riverside Midstream Water Resources, LLC (permanent waterline) – District 3
- B. 23.008, Tall Oak Woodford (gas pipeline) – District 3
- C. 23.009, Tall Oak Woodford (gas pipeline) – District 3

12. 10:00 A.M. - BID OPENINGS

None.

13. 10:00 A.M. – PUBLIC HEARINGS

None.

14. RECESS OR ADJOURNMENT



Clerk

**PITTSBURG COUNTY COMMISSIONER
AUGUST 8, 2022
MEETING MINUTES**

The Board of County Commissioners, Pittsburg County, met in regular session on August 8, 2022 at 9:00 A.M., Meeting held in the County Commissioners Conference Room, after proper notice and agenda were posted indicating time and date. Agenda was posted at 8:45 A.M., August 5, 2022.

1. CALL MEETING TO ORDER: The meeting was called to order by Chairman Smith.

2. ROLL CALL: Roll was called.

Kevin Smith	Present
Charlie Rogers	Present
Ross Selman	Present

3. APPROVAL OF AGENDA: Rogers made a motion to approve the agenda; seconded by Smith.

AYE: Kevin Smith
Charlie Rogers
Ross Selman

NAY: None.

Motion Passed.

4. APPROVE/DISAPPROVE MINUTES FROM:

A. REGULAR MEETING MINUTES FROM AUGUST 1, 2022: The minutes from the previous meeting, August 1, 2022 regular meeting were read. Rogers made a motion to approve the minutes; seconded by Smith.

AYE: Kevin Smith
Charlie Rogers
Ross Selman

NAY: None.

Motion Passed.

5. RECOGNITION OF GUESTS/PUBLIC COMMENTS: None.

6. OFFICIALS – DEPARTMENT REPORTS:

A. BOCC:

i. JUVENILE DETENTION CENTER REPORT FOR JULY 2022: The board reviewed the juvenile detention center report.

7. FISCAL TRANSACTIONS:

A. CLAIMS AND PURCHASE ORDERS: Smith made a motion to approve the purchase orders for payment after review and signature; seconded by Selman.

AYE: Kevin Smith
 Charlie Rogers
 Ross Selman

NAY: None.

Motion Passed.

B. TRANSFERS: Rogers made a motion to approve all transfers; seconded by Selman.

AYE: Kevin Smith
 Charlie Rogers
 Ross Selman

NAY: None.

Motion Passed.

C. OFFICIAL'S MONTHLY REPORTS: Smith made a motion to approve the monthly reports of officers; seconded by Rogers.

AYE: Kevin Smith
 Charlie Rogers
 Ross Selman

NAY: None.

Motion Passed.

D. BLANKET PURCHASE ORDERS:

DEPT	PO	AMOUNT	VENDOR
Building Maintenance	1299	\$1,500.00	Bemac
Building Maintenance	1300	\$1,500.00	Locke Supply
District #1	1301	\$3,000.00	Comdata
District #1	1302	\$ 500.00	Weldon Parts
District #1	1303	\$1,000.00	Yellowhouse Machinery
District #1	1304	\$1,000.00	Unifirst
District #3	1305	\$1,000.00	Kiamichi Automotive
District #1	1306	\$ 25.00	H2O Depot
District #3	1307	\$ 300.00	Fastenal

Smith made a motion to approve the blanket purchase orders; seconded by Rogers.

Pittsburg County Commissioners Minutes
August 8, 2022
Page 3

AYE: Kevin Smith
Charlie Rogers
Ross Selman

NAY: None.

Motion Passed.

E. FUEL BIDS: The Following fuel bids were received.

VENDOR	UNLEADED NON ETHANOL	UNDYED LOW S. DIESEL	DYED LOW S. DIESEL	PROPANE
RAM INC.	3.3200	3.8700	3.8700	2.4900
HOOTEN	3.49074	3.85304	3.85674	No Bid
HOPKINS	3.2500	3.7100	3.7100	2.4900

Selman made a motion to award unleaded, undyed low sulfur diesel and dyed low sulfur diesel to Hopkins and propane to Ram and Hopkins with the stipulation that if the vendor cannot deliver, to move to the next lowest bidder and that the fuel bids are for today only; seconded by Smith.

AYE: Kevin Smith
Charlie Rogers
Ross Selman

NAY: None.

Motion Passed.

8. UNFINISHED BUSINESS:

A. APPROVE/DISAPPROVE PAY APPLICATION NO. 5 TO MARTIN ROOFING FOR THE EXPO CENTER ROOF PROJECT, PROJECT NO. ARPA-21.004: Selman made a motion to strike the item from the agenda; seconded by Smith.

AYE: Kevin Smith
Charlie Rogers
Ross Selman

NAY: None.

Motion Passed.

9. AGENDA ITEMS:

A. RESOLUTION 23-020 TO ADVERTISE FOR BIDS, LABOR AND MATERIALS TO INSTALL EIGHT (8) COUNTY-SUPPLIED, 25-TON HVAC UNITS AT THE SOUTHEAST EXPO CENTER: Smith explained the hvac project. Rogers made a motion to approve the resolution; seconded by Selman.

Pittsburg County Commissioners Minutes

August 8, 2022

Page 4

AYE: Kevin Smith
Charlie Rogers
Ross Selman

NAY: None.

Motion Passed.

B. RESOLUTION 23-021 TO CANCEL PURCHASE ORDER - SHERIFF: Smith read the resolution stating purchase order 484. Smith made a motion to cancel the purchase order; seconded by Rogers.

AYE: Kevin Smith
Charlie Rogers
Ross Selman

NAY: None.

Motion Passed.

C. APPROVE/DISAPPROVE PAY APPLICATIN NO. 6 TO TRANE US, INC. FOR THE HVAC REPLACEMENT PROJECT AT THE PITTSBURG COUNTY JAIL, PROJECT NO. ARPA 21-002: Smith stated that the pay application is in the amount of \$79,650.00. Smith made a motion to approve the pay application; seconded by Selman.

AYE: Kevin Smith
Charlie Rogers
Ross Selman

NAY: None.

Motion Passed.

D. RE-AWARD SIX MONTH BID FOR PLASTIC PIPE: Smith stated that Ferguson Water Works cannot honor their bid for the pipe. Selman made a motion to award the bid to the next lowest bidder; seconded by Rogers.

AYE: Kevin Smith
Charlie Rogers
Ross Selman

NAY: None.

Motion Passed.

10. NEW BUSINESS:

A. CONSIDERATION AND POSSIBLE ACTION WITH RESPECT TO ANY OTHER MATTERS NOT KNOWN ABOUT OR WHICH COULD NOT HAVE BEEN FORESEEN PRIOR TO POSTING THIS AGENDA: Pafford Ambulance representative stated that he was present if the board had any questions.

11. ROAD CROSSING PERMIT:

A. 23.007, RIVERSIDE MIDSTREAM WATER RESOURCES, LLC (PERMANENT WATERLINE) – DISTRICT 3: Selman made a motion to approve the road crossing permit; seconded by Rogers.

AYE: Kevin Smith
Charlie Rogers
Ross Selman

NAY: None.

Motion Passed.

B. 23.008, TALL OAK WOODFORD (GAS PIPELINE) – DISTRICT 3: Selman made a motion to approve the road crossing permit; seconded by Rogers.

AYE: Kevin Smith
Charlie Rogers
Ross Selman

NAY: None.

Motion Passed.

C. 23.009, TALL OAK WOODFORD (GAS PIPELINE) – DISTRICT 3: Selman made a motion to approve the road crossing permit; seconded by Smith.

AYE: Kevin Smith
Charlie Rogers
Ross Selman

NAY: None.

Motion Passed.

12. 10:00 A.M. - BID OPENINGS: None.

13. 10:00 A.M. – PUBLIC HEARINGS: None.

14. ADJOURNMENT/RECESS: There being no further business brought before the board; Smith made a motion to sign all approved claims and adjourn; seconded by Selman.

AYE: Kevin Smith
Charlie Rogers
Ross Selman

NAY: None.

Motion Passed. Meeting Adjourned.

Purchase Orders By Account

Fiscal Year : 2021-2022

Date Range: 08/08/2022 to 08/08/2022

PO	Warrant No.	Vendor Name	Purpose	Amount
ARPA 2021				
1566-1-2000-2005				
011436	0C0057	BIZ-TEL	LABOR AND PARTS	\$ 8,796.00
Total:				\$ 8,796.00
Health				
1216-3-5000-2005				
009786	0C0413	ABBOTT RAPID DX NORTH AMERICA L	DRUG TESTING	\$ 115.75
Total:				\$ 115.75
Hwy-ST				
1313-6-8040-2005				
010563	0C3083	H2O DEPOT	WATER & COOLER RENT	\$ 9.20
010639	0C3084	MUSKOGEE SAND COMPANY INC	CLASS A SAND	\$ 3,727.40
011154	0C3085	MUSKOGEE SAND COMPANY INC	CLASS A SAND	\$ 2,986.10
011252	0C3086	DOLESE	#4 SCREENINGS	\$ 1,835.86
011332	0C3087	DOLESE	3/8" #2 COVER CHIPS	\$ 1,074.48
Total:				\$ 9,633.04
1313-6-8041-2005				
008546	0C3088	EMBASSY SUITES NORMAN	LODGING	\$ 400.00
Total:				\$ 400.00
1313-6-8042-2005				
008553	0C3089	EMBASSY SUITES NORMAN	LODGING	\$ 100.00
008554	0C3090	EMBASSY SUITES NORMAN	LODGING	\$ 200.00
Total:				\$ 300.00
1313-6-8043-2005				
008555	0C3091	EMBASSY SUITES NORMAN	LODGING	\$ 200.00
010580	0C3092	FASTENAL	NUTS & BOLTS	\$ 1,990.75
Total:				\$ 2,190.75

PO Warrant No. Vendor Name Purpose Amount

Rural Fire-ST

1321-2-8221-2005
006543 001169 CHIEF FIRE & SAFETY SCBA MASK \$ 3,005.56
Total: \$ 3,005.56

SH Svc Fee

1226-2-3400-2005
009970 001916 BRIGGS PRINTING Jail Supplies \$ 313.00
010060 001917 AMERICAN TEES DEPUTY UNIFORMS \$ 2,149.50
010557 001918 WILLO PRODUCTS COMPANY JAIL MAINTENANCE WOR \$ 5,128.80
Total: \$ 7,591.30

1226-2-3400-2030
010391 001919 LOCKE HEATING & COOLING SUPPLY MAINTENANCE SUPPLIE \$ 37.72
Total: \$ 37.72

1226-2-3400-4110
005755 001920 METRO EMERGENCY UPFITTERS LLC EQUIPMENT \$ 28,601.48
Total: \$ 28,601.48

Grand Total: \$ 60,671.60

Purchase Orders By Account

Fiscal Year : 2022-2023

Date Range: 08/08/2022 to 08/08/2022

PO	Warrant No.	Vendor Name	Purpose	Amount
Animal Shelter				
1316-1-8020-2005				
000593	000054	ZOETIS US LLC	VACCINES	\$ 2,515.20
000595	000055	AVID IDENTIFICATION SYSTEMS INC	MICROCHIPS	\$ 1,237.50
000723	000056	SOUTHEASTERN ALARM LLC	ALARM SERVICE	\$ 110.00
000754	000057	FUSION	MONTHLY SERVICE	\$ 70.55
000761	000058	BIZ-TEL	PHONE REPAIR	\$ 302.50
000833	000059	AMAZON CAPITAL SERVICES INC.	URNS	\$ 424.75
000834	000060	VYVE BROADBAND	MONTHLY SERVICE	\$ 70.82
000870	000061	LOWES	KENNEL SUPPLIES	\$ 163.86
000908	000062	CENTER, EWELL	VET SERVICES	\$ 700.00
000941	000063	UNIFIRST FIRST AID CORP	MEDICINE CABINET RES	\$ 60.87
000970	000064	MWI VET SUPPLY	VET SUPPLIES	\$ 888.40
001094	000065	ACC BUSINESS	MONTHLY INTERNET SE	\$ 250.82
001102	000066	CENTER POINT ENERGY ARKLA	MONTHLY SERVICE	\$ 1,027.50
			Total:	\$ 7,822.77
1316-1-8020-4110				
000616	000067	ADA PAPER COMPANY	KENNEL SUPPLIES	\$ 550.00
			Total:	\$ 550.00
ARPA 2021				
1566-1-2000-2005				
001144	000006	GREEN COUNTRY ELECTRIC	HVAC	\$ 1,498.75
			Total:	\$ 1,498.75
CARES				
1565-1-2000-2005				
000727	000003	DOLESE	#4 SCREENINGS	\$ 391.94
000728	000004	DOLESE	1 1/2" CRUSHER RUN	\$ 244.51
			Total:	\$ 636.45
CBRI				

PO	Warrant No.	Vendor Name	Purpose	Amount
CBRI				
1103-6-4300-2075				
000473	000006	ERAGON ASPHALT & EMULSIONS	ROAD OIL	\$ 6,370.55
			Total:	\$ 6,370.55
Control Substance				
7301-1-0200-1110				
001092	000002	DISTRICT ATTORNEYS COUNCIL	PERSONAL SERVICES	\$ 2,000.00
			Total:	\$ 2,000.00
Drug Court				
7206-1-1900-2005				
001195	000016	REDWOOD TOXICOLOGY LABORATOR	LAB FEES	\$ 659.49
			Total:	\$ 659.49
Econ Dev Trust				
7603-4-0500-2005				
000008	000034	PEPSI-COLA BOTTLING CO.	CONCESSION SUPPLIES	\$ 347.20
000931	000035	WHITES ELECTRIC	A/C PARTS	\$ 83.03
000966	000036	H2O DEPOT	WATER & COOLER RENT	\$ 37.00
001103	000037	ACC BUSINESS	MONTHLY SERVICE	\$ 594.67
001119	000038	PUBLIC SERVICE CO. OF OKLAHOMA	MONTHLY SERVICE	\$ 340.67
001120	000039	PUBLIC SERVICE CO. OF OKLAHOMA	MONTHLY SERVICE	\$ 99.72
001121	000040	PUBLIC SERVICE CO. OF OKLAHOMA	MONTHLY SERVICE	\$ 5,237.42
001122	000041	PUBLIC SERVICE CO. OF OKLAHOMA	MONTHLY SERVICE	\$ 20.63
001123	000042	PUBLIC SERVICE CO. OF OKLAHOMA	MONTHLY SERVICE	\$ 20.84
001124	000043	PUBLIC SERVICE CO. OF OKLAHOMA	MONTHLY SERVICE	\$ 43.27
001199	000044	CITY OF MCALESTER	MONTHLY SERVICE	\$ 861.25
			Total:	\$ 7,685.70
Emergency Mgmt				
1212-2-2700-2005				
000415	000011	EMBLEM ENTERPRISES INC.	UNIFORM PATCHES	\$ 2,068.41
000487	000012	MCCRAYS MANUFACTURING	TRAILER REPAIR	\$ 1,000.00
000623	000013	TECH RESQ	SWIFT WATER TRAINING	\$ 4,410.00
			Total:	\$ 7,478.41

PO	Warrant No. Vendor Name	Purpose	Amount
----	-------------------------	---------	--------

Equitable Sharing - DOJ

1243-1-0200-2005			
001147	000001	COMDATA	
		FUEL	\$ 598.10
Total:			\$ 598.10

General

0001-1-0100-2005			
000025	000325	H2O DEPOT	\$ 61.20
000026	000326	COMDATA	\$ 920.83
000027	000327	OTA PIKEPASS CUSTOMER SERVICE	\$ 22.45
000146	000328	BRIGGS PRINTING	\$ 45.00
001145	000329	VYVE BROADBAND	\$ 196.90
001146	000330	FUSION	\$ 65.17
001269	000331	THOMSON REUTERS WEST	\$ 420.72
001270	000332	US CELLULAR	\$ 434.26
001298	000333	ACCESS	\$ 75.00
Total:			\$ 2,241.53

0001-1-0600-2005			
001074	000334	ACC BUSINESS	\$ 244.06
001076	000335	CANON FINANCIAL SERVICES	\$ 144.00
Total:			\$ 388.06

0001-1-1000-2005			
001072	000336	ACC BUSINESS	\$ 244.06
001238	000337	PITNEY BOWES GLOBAL FINANCIAL S	\$ 371.16
Total:			\$ 615.22

0001-1-1600-2005			
001070	000338	ACC BUSINESS	\$ 244.06
Total:			\$ 244.06

0001-1-1700-2020			
000915	000339	TOTAL ASSESSMENT SOLUTIONS CO	\$ 9,375.00
Total:			\$ 9,375.00

0001-1-2200-2005			
000497	000340	PITTSBURG COUNTY ELECTION BD.	\$ 463.25
001073	000341	ACC BUSINESS	\$ 244.06
001081	000342	PITNEY BOWES INC	\$ 249.01
001142	000343	UNIFIRST FIRST AID CORP	\$ 69.83
		ELECTION EXPENSES	
		MONTHLY INTERNET SE	
		POSTAGE METER SUPPLI	
		FIRST AID SUPPLIES	

PO Warrant No. Vendor Name Purpose Amount

General

0001-1-2200-2005

Total: \$ 1,026.15

0001-1-3300-2005

000021	000344	H2O DEPOT	BOTTLED WATER ETC.	\$ 245.50
000022	000345	CINTAS CORPORATION # 618	UNIFORM SERVICE	\$ 252.58
001079	000346	PRO KILL INC.	MONTHLY SERVICE	\$ 440.00
001237	000347	CENTER POINT ENERGY ARKLA	MONTHLY SERVICE	\$ 312.03
001239	000348	BEMAC SUPPLY	FREON	\$ 511.85
001257	000349	TK ELEVATOR CORPORATION	ELEVATOR MAINTENANC	\$ 2,278.62

Total: \$ 4,040.58

0001-2-2700-2005

000029	000350	OTA PIKEPASS CUSTOMER SERVICE	TOLL	\$ 9.80
000659	000351	ADA PAPER COMPANY	JANITORIAL SUPPLIES	\$ 852.22
001028	000352	PRO KILL INC.	MONTHLY SERVICE	\$ 212.00
001134	000353	ACC BUSINESS	MONTHLY INTERNET SE	\$ 250.82
001243	000354	SECRETARY OF STATE	NOTARY FILING FEE	\$ 25.00
001244	000355	SECRETARY OF STATE	NOTARY FILING FEE	\$ 25.00
001280	000356	CITY OF MCALESTER	MONTHLY SERVICE	\$ 6,101.20

Total: \$ 7,476.04

0001-4-0500-2005

001129	000357	RURAL WATER DIST. #7	MONTHLY SERVICE	\$ 26.45
001130	000358	PUBLIC SERVICE CO. OF OKLAHOMA	MONTHLY SERVICE	\$ 139.47

Total: \$ 165.92

0001-5-0900-1310

001131	000359	OWEN, GREGORY J.	TRAVEL	\$ 699.30
001132	000360	WINKLER, MEGAN	TRAVEL	\$ 503.28

Total: \$ 1,202.58

0001-5-0900-2005

001077	000361	ACC BUSINESS	MONTHLY INTERNET SE	\$ 250.82
--------	--------	--------------	---------------------	-----------

Total: \$ 250.82

0001-6-0800-2005

001071	000362	ACC BUSINESS	MONTHLY INTERNET SE	\$ 244.06
001100	000363	MILLER OFFICE EQUIPMENT	MONTHLY COPIER LEAS	\$ 62.30
001151	000364	QUADIENT LEASING	POSTAGE METER LEASE	\$ 320.82

Total: \$ 627.18

PO	Warrant No.	Vendor Name	Purpose	Amount
Health				
1216-3-5000-1310				
001157	000021	ALLAR, MARIAH	TRAVEL	\$ 32.50
Total:				\$ 32.50
1216-3-5000-2005				
000694	000022	PITNEY BOWES INC	INK PAD	\$ 19.54
001137	000023	PUBLIC SERVICE CO. OF OKLAHOMA	MONTHLY SERVICE	\$ 3,562.48
Total:				\$ 3,582.02
1216-3-5000-4110				
001283	000024	BANCFIRST	LEASE PAYMENT	\$ 25,731.67
Total:				\$ 25,731.67
Highway				
1102-6-4100-2005				
000869	000235	H2O DEPOT	BOTTLE WATER	\$ 137.00
000909	000236	EUFALA AUTO PARTS INC	HOSE & FITTINGS	\$ 105.84
000921	000237	TRUCKPRO-FORT SMITH	COMPRESSOR	\$ 285.53
000969	000238	RAM INC	FUEL	\$ 7,322.76
Total:				\$ 7,851.13
1102-6-4300-2005				
000590	000239	WELDON PARTS INC.	TOOLS & SHOP SUPPLIE	\$ 108.63
000665	000240	PEPSI-COLA BOTTLING CO.	BOTTLED WATER	\$ 279.00
000681	000241	ERGON ASPHALT & EMULSIONS	DEMURRAGE	\$ 315.00
000685	000242	CINTAS CORPORATION # 618	UNIFORM MAINTENANCE	\$ 319.25
000704	000243	RAM INC	FUEL	\$ 6,669.05
000755	000244	P & K EQUIPMENT INC	SOLENOID	\$ 504.62
001009	000245	THE TRACTOR SHOP	A/C REPAIR	\$ 1,043.62
001091	000246	RAM INC	FUEL	\$ 6,014.00
001140	000247	RAM INC	FUEL	\$ 4,185.86
Total:				\$ 19,439.03
Hwy-ST				
1313-6-8040-2005				
000101	000146	MUSKOGEE SAND COMPANY INC	SAND	\$ 3,926.15
000358	000147	H2O DEPOT	WATER & COOLER RENT	\$ 9.20
000630	000148	DOLESE	3/8" #2 COVER CHIPS	\$ 8,140.06
000678	000149	DOLESE	#4 SCREENINGS	\$ 4,880.95

PO Warrant No. Vendor Name Purpose Amount

Hwy-ST

1313-6-8040-2005

000832	000150	DOLESE	3/8" #2 COVER CHIPS	\$ 8,138.91
000939	000151	REPUBLIC SERVICES # 375	WASTE DISPOSAL	\$ 921.14
000965	000152	DOLESE	3/8" #2 COVER CHIPS	\$ 7,996.13
001090	000153	ASPHALT & FUEL SUPPLY	ASPHALT BINDER	\$ 22,695.00
001112	000154	RURAL WATER DIST #6	MONTHLY SERVICE	\$ 115.49
001179	000155	STANDARD MACHINE & WELDING	FABRICATION	\$ 481.18

Total: \$ 57,304.21

1313-6-8040-4130

001215	000156	WELCH STATE BANK	LEASE PAYMENT	\$ 15,723.91
--------	--------	------------------	---------------	--------------

Total: \$ 15,723.91

1313-6-8041-2005

000375	000157	STAPLES ADVANTAGE	OFFICE SUPPLIES	\$ 90.22
000395	000158	STIGLER STONE	1" CRUSHER RUN	\$ 4,867.50
001065	000159	US CELLULAR	MONTHLY SERVICE	\$ 385.02
001066	000160	CANON FINANCIAL SERVICES	MONTHLY COPIER LEAS	\$ 102.00
001167	000161	T & W TIRE	TIRES & SERVICES	\$ 1,141.61
001067	000162	P & K EQUIPMENT	EQUIPMENT PARTS	\$ 548.00
001095	000163	EUFULA AUTO PARTS INC	HOSE & FITTINGS	\$ 141.06
001106	000164	CANADIAN VALLEY TELEPHONE	MONTHLY SERVICE	\$ 40.62
001108	000165	CENTER POINT ENERGY ARKLA	MONTHLY SERVICE	\$ 49.29
001109	000166	CROSS TELEPHONE CO.	MONTHLY SERVICE	\$ 31.94
001110	000167	PUBLIC SERVICE CO. OF OKLAHOMA	MONTHLY SERVICE	\$ 42.34
001111	000168	KIAMICHI ELECTRIC COOPERATIVE	MONTHLY SERVICE	\$ 60.21
001117	000169	PUBLIC SERVICE CO. OF OKLAHOMA	MONTHLY SERVICE	\$ 101.54
001128	000170	DISCOUNT STEEL	JACK	\$ 312.00
001148	000171	UNIFIRST FIRST AID CORP	MEDICINE CABINET RES	\$ 137.00
001149	000172	PREMIER TRUCK GROUP	FILTERS	\$ 247.41
001150	000173	HAILEYVILLE WATER DEPT.	MONTHLY SERVICE	\$ 306.98
001192	000174	H2O DEPOT	COOLER RENTAL	\$ 18.40

Total: \$ 8,623.14

1313-6-8041-4130

001205	000175	CATERPILLAR FINANCIAL	LEASE PAYMENT	\$ 2,981.97
001206	000176	OKLA. DEPT OF TRANSPORTATION	LEASE PAYMENT	\$ 5,259.17
001211	000177	SECURITY NATIONAL BANK	LEASE PAYMENT	\$ 6,844.59
001221	000178	ARMSTRONG BANK	LEASE PAYMENT	\$ 10,679.43
001222	000179	WELCH STATE BANK	LEASE PAYMENT	\$ 16,865.46
001224	000180	MERCEDES-BENZ FINANCIAL SVCS	LEASE PAYMENT	\$ 5,482.73
001225	000181	SECURITY STATE BANK	LEASE PAYMENT	\$ 5,827.71

Total: \$ 53,941.06

PO Warrant No. Vendor Name Purpose Amount

Hwy-ST

1313-6-8042-2005

000394	000182	BELSHE INDUSTRIES INC	WHEELS ETC.	\$ 1,590.48
000530	000183	KIRBY SMITH INC.	EQUIPMENT PARTS	\$ 168.56
000868	000184	RAM INC	FUEL	\$ 8,602.00
000952	000185	CINTAS CORPORATION # 618	UNIFORM MAINTENANCE	\$ 865.65
001107	000186	CENTER POINT ENERGY ARKLA	MONTHLY SERVICE	\$ 57.63
001118	000187	PITTSBURG PUBLIC WORKS AUTH.	MONTHLY SERVICE	\$ 758.62
001173	000188	G.W. VAN KEPPEL	MANIFOLD	\$ 4,624.98

Total: \$ 16,667.92

1313-6-8042-4130

001207	000189	OKLA. DEPT OF TRANSPORTATION	LEASE PAYMENT	\$ 6,497.33
001208	000190	SNB BANK NA	LEASE PAYMENT	\$ 5,774.64
001209	000191	ARMSTRONG BANK	LEASE PAYMENT	\$ 5,510.35
001210	000192	WELCH STATE BANK	LEASE PAYMENT	\$ 26,101.87

Total: \$ 43,884.19

1313-6-8043-2005

000082	000193	KIAMICHI AUTOMOTIVE WAREHOUSE	AUTO PARTS	\$ 726.02
000084	000194	T & W TIRE	TIRES & SERVICES	\$ 1,234.70
000087	000195	UNIFIRST FIRST AID CORP	MEDICINE CABINET RES	\$ 199.75
000252	000196	STEWART MARTIN EQUIPMENT	PARTS	\$ 800.61
000410	000197	FLEET PRIDE	EQUIPMENT PARTS	\$ 207.00
000516	000198	P & K EQUIPMENT INC	EQUIPMENT PARTS	\$ 732.92
000518	000199	P & K EQUIPMENT INC	EQUIPMENT PARTS	\$ 14.90
000519	000200	CINTAS CORPORATION # 618	UNIFORM MAINTENANCE	\$ 319.25
000824	000201	WELDON PARTS INC.	BRAKE SHOES	\$ 98.33
000837	000202	JIM S TIRE & BRAKE	TIRES & SERVICES	\$ 424.98
000852	000203	P & K EQUIPMENT INC	FILTERS	\$ 110.69
000898	000204	YELLOW HOUSE MACHINE	CONTROL HANDLE	\$ 573.74
000906	000205	LOWES	MAILBOX REPLACEMENT	\$ 71.63
000911	000206	P & K EQUIPMENT INC	VALVE ETC.	\$ 250.00
000943	000207	CINTAS CORPORATION # 618	UNIFORM MAINTENANCE	\$ 319.25
000944	000208	T & W TIRE	TIRES & SERVICES	\$ 278.85
000978	000209	P & K EQUIPMENT INC	WEED EATER PARTS	\$ 75.29
001101	000210	CENTER POINT ENERGY ARKLA	MONTHLY SERVICE	\$ 96.54
001104	000211	CANON FINANCIAL SERVICES	MONTHLY COPIER LEAS	\$ 102.00
001180	000212	OTA PIKEPASS	TOLL	\$ 39.05
001202	000213	CITY OF MCALESTER	MONTHLY SERVICE	\$ 20.35
001203	000214	CITY OF MCALESTER	MONTHLY SERVICE	\$ 434.44
001204	000215	CITY OF MCALESTER	MONTHLY SERVICE	\$ 466.41

Total: \$ 7,596.70

PO Warrant No. Vendor Name Purpose Amount

Hwy-ST

1313-6-8043-4130

001212	000216	ARMSTRONG BANK	LEASE PAYMENT	\$ 1,196.72
001213	000217	WARREN POWER & MACHINERY INC.	LEASE PAYMENT	\$ 2,395.00
001214	000218	WELCH STATE BANK	LEASE PAYMENT	\$ 22,616.52
001216	000219	WARREN POWER & MACHINERY INC.	LEASE PAYMENT	\$ 2,395.00
001217	000220	CATERPILLAR FINANCIAL	LEASE PAYMENT	\$ 3,437.99
001218	000221	WARREN POWER & MACHINERY INC.	LEASE PAYMENT	\$ 2,395.00
001219	000222	OKLA. DEPT OF TRANSPORTATION	LEASE PAYMENT	\$ 5,340.42
001220	000223	WARREN POWER & MACHINERY INC.	LEASE PAYMENT	\$ 2,395.00
001228	000224	WARREN POWER & MACHINERY INC.	LEASE PAYMENT	\$ 2,395.00

Total: \$ 44,566.65

Jail-ST

1315-2-8034-2005

001075	000087	CENTER POINT ENERGY ARKLA	MONTHLY SERVICE	\$ 1,158.13
001158	000088	US FOODS	JAIL KITCHEN SUPPLIES	\$ 240.53
001241	000089	CITY OF MCALESTER	MONTHLY SERVICE	\$ 3,642.56
001245	000090	US FOODS	DISHWASHER LEASE	\$ 93.19

Total: \$ 5,134.41

1315-2-8034-2011

000671	000091	CHRISTOPHER BEEENE M.D.	INMATE MEDICAL	\$ 1,500.00
--------	--------	-------------------------	----------------	-------------

Total: \$ 1,500.00

1315-2-8034-2012

001159	000092	US FOODS	INMATE GROCERIES	\$ 3,587.95
001227	000093	PERFORMANCE FOODSERVICE - LITT	INMATE GROCERIES	\$ 1,661.45

Total: \$ 5,249.40

Rural Fire-ST

1321-2-8201-2005

001297	000071	ADT SECURITY SERVICES	MONTHLY SERVICE	\$ 71.26
--------	--------	-----------------------	-----------------	----------

Total: \$ 71.26

1321-2-8202-2005

001080	000072	RLI	SURETY BOND	\$ 245.00
--------	--------	-----	-------------	-----------

Total: \$ 245.00

PO	Warrant No.	Vendor Name	Purpose	Amount
Rural Fire-ST				
1321-2-8204-2005				
000045	000073	COMDATA	FUEL	\$ 256.98
Total:				\$ 256.98
1321-2-8204-4130				
001248	000074	WELCH STATE BANK	LEASE PAYMENT	\$ 1,018.50
Total:				\$ 1,018.50
1321-2-8205-4130				
001247	000075	ARMSTRONG BANK	LEASE PAYMENT	\$ 723.53
Total:				\$ 723.53
1321-2-8206-2005				
000043	000076	SNOW, TITUS	LAWN CARE	\$ 500.00
000980	000077	DEFRANGE AUTO	TIRES	\$ 690.00
001175	000078	KIAMICHI ELECTRIC COOPERATIVE	MONTHLY SERVICE	\$ 44.00
Total:				\$ 1,234.00
1321-2-8207-2005				
000048	000079	EUFAULA AUTO PARTS INC	AUTO PARTS	\$ 19.46
000762	000080	COMDATA	FUEL	\$ 527.58
Total:				\$ 547.04
1321-2-8207-4130				
001249	000081	OKLAHOMA STATE BANK	LEASE PAYMENT	\$ 2,675.35
Total:				\$ 2,675.35
1321-2-8210-4130				
001250	000082	WELCH STATE BANK	LEASE PAYMENT	\$ 3,092.21
Total:				\$ 3,092.21
1321-2-8212-2005				
001236	000083	PUBLIC SERVICE CO. OF OKLAHOMA	MONTHLY SERVICE	\$ 104.34
Total:				\$ 104.34
1321-2-8214-2005				
001105	000084	KIAMICHI ELECTRIC COOPERATIVE	MONTHLY SERVICE	\$ 141.06
Total:				\$ 141.06

PO	Warrant No.	Vendor Name	Purpose	Amount
Rural Fire-ST				
1321-2-8215-2005				
001260	000085	WILSON TRUCK AND TIRE SERVICE	TRUCK REPAIR	\$ 360.00
001261	000086	ADT SECURITY SERVICES	MONTHLY SERVICE	\$ 113.03
			Total:	\$ 473.03
1321-2-8217-2005				
000054	000087	COMDATA	FUEL	\$ 729.20
001291	000088	KIAMICHI ELECTRIC COOPERATIVE	MONTHLY SERVICE	\$ 414.51
001292	000089	KIAMICHI ELECTRIC COOPERATIVE	MONTHLY SERVICE	\$ 53.33
001293	000090	CROSS TELEPHONE CO.	MONTHLY SERVICE	\$ 61.56
			Total:	\$ 1,258.60
1321-2-8218-2005				
001181	000091	RURAL WATER DIST #18	MONTHLY SERVICE	\$ 200.00
			Total:	\$ 200.00
1321-2-8219-4130				
001251	000092	WELCH STATE BANK	LEASE PAYMENT	\$ 1,255.55
			Total:	\$ 1,255.55
1321-2-8221-4110				
000125	000093	CHIEF FIRE & SAFETY	FACE MASK	\$ 4,000.56
			Total:	\$ 4,000.56
1321-2-8223-4130				
001252	000094	SECURITY NATIONAL BANK	LEASE PAYMENT	\$ 1,660.39
			Total:	\$ 1,660.39
1321-2-8225-2005				
000954	000095	GENERATOR SUPERCENTER OF OKLA	GENERATOR REPAIR	\$ 1,150.00
000957	000096	METROPOLITAN COMPOUNDS INC	SHOP/MAINTENANCE SU	\$ 5,806.36
001255	000097	KIAMICHI ELECTRIC COOPERATIVE	MONTHLY SERVICE	\$ 143.73
001256	000098	CANADIAN VALLEY TELEPHONE	MONTHLY SERVICE	\$ 137.14
001258	000099	RURAL WATER DIST #18	MONTHLY SERVICE	\$ 200.00
			Total:	\$ 7,437.23
1321-2-8225-4130				
001253	000100	K & B GENERAL CONSTRUCTION INC.	LEASE PAYMENT	\$ 1,375.19
			Total:	\$ 1,375.19

PO	Warrant No.	Vendor Name	Purpose	Amount
		Rural Fire-ST		
	1321-2-8227-4130			
001254	000101	WELCH STATE BANK	LEASE PAYMENT	\$ 690.08
		Total:	\$ 690.08	

SH Commissary

1223-2-0400-2005				
000771	000014	COMMISSARY EXPRESS	KIOSK FEES	\$ 55.25
000831	000015	COMMISSARY EXPRESS	INMATE COMMISSARY	\$ 3,223.87
000835	000016	CUSTOM TECHNOLOGIES LLC	INMATE COMMISSARY	\$ 626.52
000999	000017	BANCFIRST	CHECKS	\$ 58.15
001141	000018	COMMISSARY EXPRESS	DEBIT PHONE TIME FEE	\$ 104.00
001161	000019	US FOODS	COMMISSARY SUPPLIES	\$ 695.34
001163	000020	COMMISSARY EXPRESS	COMMISSARY SUPPLIES	\$ 2,914.24
001164	000021	COMMISSARY EXPRESS	COMMISSARY SUPPLIES	\$ 2,889.73
		Total:	\$ 10,567.10	

SH Svc Fee

1226-2-0400-2005				
001114	000097	CANON FINANCIAL SERVICES	MONTHLY COPIER LEAS	\$ 110.00
		Total:	\$ 110.00	

1226-2-3400-2005

000066	000098	LOWES	JAIL MAINTENANCE SUP	\$ 286.97
000069	000099	HOLMANS FAST LUBE	OIL CHANGE ETC	\$ 213.19
000074	000100	O REILLY AUTO PARTS	AUTO PARTS	\$ 462.34
000349	000101	ABOVE THE GRILL	JAIL MAINTENANCE WOR	\$ 800.00
000820	000102	MIRA SAFEETY	RESPIRATOR MASK	\$ 3,299.60
000823	000103	STAPLES CREDIT PLAN	OFFICE SUPPLIES	\$ 189.90
000971	000104	TRAMMELLS AUTOMOTIVE	AUTO REPAIR	\$ 240.00
000972	000105	O REILLY AUTO PARTS	AUTO PARTS	\$ 110.31
000982	000106	WALMART COMMUNITY CARD	INMATE WORK CREW	\$ 66.17
000983	000107	WALMART COMMUNITY CARD	INMATE BILLED VIDEO VI	\$ 133.26
001087	000108	WAV 11	COMPUTER SOFTWARE	\$ 25.50
001089	000109	ACC BUSINESS	MONTHLY INTERNET SE	\$ 250.81
001113	000110	HARTSHORNE BODY SHOP	AUTO REPAIR	\$ 1,549.96
001116	000111	PITNEY BOWES GLOBAL FINANCIAL S	POSTAGE METER LEASE	\$ 159.06
001160	000112	JAMESCO ENTERPRISES LLC	JANITORIAL SUPPLIES	\$ 695.42
001162	000113	US FOODS	KITCHEN SUPPLIES	\$ 78.95
001188	000114	INKED AND THREADED LLC	UNIFORMS	\$ 1,248.00
001189	000115	ATWOODS	MAINTENANCE SUPPLIE	\$ 94.43
001190	000116	TRAMMELLS AUTOMOTIVE	AUTO REPAIR	\$ 190.00

PO Warrant No. Vendor Name Purpose Amount

SH Svc Fee

1226-2-3400-2005

001230	000117	PERFORMANCE FOODSERVICE - LITT	KITCHEN SUPPLIES	\$ 153.57
001232	000118	INDIAN NATION WHOLESALE CO.	JANITORIAL SUPPLIES	\$ 332.00

Total: \$ 10,579.44

1226-2-3400-2011

000984	000119	WALMART COMMUNITY CARD	INMATE MEDICAL	\$ 15.52
001098	000120	RECEIVABLE MANAGEMENT GROUP I	INMATE MEDICAL	\$ 35.00

Total: \$ 50.52

1226-2-3400-2030

000064	000121	O REILLY AUTO PARTS	AUTO PARTS ETC.	\$ 281.32
000644	000122	COMMISSARY EXPRESS	KIOSK FEES	\$ 39.00
000646	000123	COMMISSARY EXPRESS	DEBIT PHONE TIME FEE	\$ 142.00
000760	000124	COMMISSARY EXPRESS	DEBIT PHONE TIME FEE	\$ 140.00
001001	000125	COMMISSARY EXPRESS	KIOSK FEES	\$ 81.25
001002	000126	COMMISSARY EXPRESS	DEBIT PHONE TIME FEE	\$ 130.00
001115	000127	ADAMS TRUE VALUE	WEED EATER PARTS	\$ 140.00

Total: \$ 953.57

Grand Total: \$ 430,501.83

Pittsburg County Juvenile Detention Center

1208 N. West Street
McAlester, Ok. 74501
(918) 426-1585

Monthly Report

To

Pittsburg County Commissioners

For

July 2022

July Total Population	15
Total Days of Care	295
Average Daily Population	9.8
Average Length of Stay	23.0
Counties under Contract	59

During the month of July we did not make any new purchases.

PITTSBURG COUNTY REGIONAL
JUVENILE DETENTION
July 2022

County	# of Juveniles	Total Days of Care	Amount Due
Atoka	2	62	\$2416.14
Choctaw	3	79	\$ 3078.63
Haskell	1	3	\$ 116.91
Leflore	2	56	\$ 2182.32
Lincoln	1	5	\$ 194.85
Okmulgee	1	28	\$ 1091.16
Pittsburg	3	41	\$ 1597.77
Pontotoc	2	21	\$ 818.37
Grand Total	15	295	\$ 11,496.15

Detention Maintenance Fund

During the month of July, The Detention Maintenance Fund was not used.
Therefore, the balance remains at \$ 20,004.85 plus any interest earned.

Ram, Inc. submits the following fuel bids for the week: August 8th, 2022.

UL	CLEAR	DYED	LP
3.3200	3.8700	3.8700	2.4900

FILED
AUG 08 2022
TIME 8:26 AM
HOPE TRAMMELL, COUNTY CLERK
PITTSBURG COUNTY
BY [Signature] DEPUTY

****** This bid is for today only ******

18 cents per gallon will be added if truck goes to new location.

If you can't read this bid, call me immediately.

Thank you,

Twilah Monroe

RAM, Inc.

918-424-2097

RESOLUTION
23-020
To Advertise

The Board of County Commissioners, Pittsburg County, met in regular session on Monday, August 8, 2022.

WHEREAS, the Pittsburg County wishes to advertise for the following for the Southeast Expo Center:

Labor and Materials to Install Eight (8), County Supplied, 25 Ton HVAC Units

A bid package containing complete specifications and an "Invitation to Bid" are available at the Pittsburg County Clerk's Office, 115 E. Carl Albert Pkwy, Room 103, McAlester, Oklahoma 74501 or online at pittsburg.okcounties.org.

THEREFORE, each competitive bid submitted to the County must be accompanied with an affidavit for filing with the competitive bid form, as required by Title 61 O.S. § 101-138.

Sealed bids will be received and filed with the Pittsburg County Clerk until Friday, September 2, 2022 at 4:00 p.m. All bids received after 4:00 p.m. on Friday, September 2, 2022 WILL NOT BE OPENED. Bids will be opened on Tuesday, September 6, 2022 at 10:00 a.m. in the Board of County Commissioners Conference Room, 115 E. Carl Albert Pkwy, McAlester, Oklahoma. The Board of County Commissioners, Pittsburg County, reserves the right to reject any and all bids and re-advertise.

BOARD OF COUNTY COMMISSIONERS
PITTSBURG COUNTY, OKLAHOMA

ATTEST:

CHAIRMAN



VICE CHAIRMAN



MEMBER



COUNTY CLERK

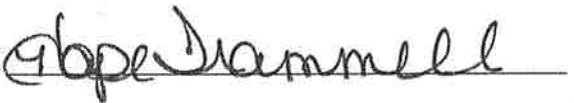

BID SPECIFICATIONS

Pittsburg County will supply Eight (8) 25 Ton HVAC units and Concrete Pads for all eight (8) units, Control System

Award bidder will be responsible for:

1. Removing Chiller, Boiler, Cooling Tower, Pumps associated with chiller/boiler system, gas furnaces.
2. Removing all 19 water cooled heat pumps/AHU's.
3. Removing any water piping necessary to accommodate installation of new VRF AHU's.
4. Installation of county supplied VRF equipment in place of existing water cooled heat pump/AHU's. Installation of new VRF condensing units on supplied concrete pads.
5. Installation of county supplied control system.
6. Provide and install all refrigerant piping, refrigerant, necessary ductwork and/or connections to accommodate new AHU's, control wiring, necessary electrical conduits, wire, labor and materials, to new AHU's and condensers, for a complete job.
7. Remove gas furnaces in arena and cap flues through roof.
8. Set county supplied 8 (qty) 25 ton gas package units on supplied curbs, on supplied concrete pads.
9. Supply and install new gas piping to new package units
10. Provide and install, internally insulated with 1" duct liner, glue and welded pins, galvanized rectangular ducts as per drawing. Supply and return duct work, any and all grills or registers to be included.
11. Provide and install with any and all necessary materials to do complete job, 6 (qty) duct socks as per drawing.
12. 1 (one) year labor to be included, with owner training on operation and maintenance.
13. All labor, material, lifts, or anything else needed to do a complete turn-key job to be included. Anything not listed as supplied by the county, but necessary to do a complete job, is to be included.
14. Any and all material or equipment removed, must be left at county specified location onsite and shall remain property of the county
15. Must have previous experience in installing and maintaining VRF systems.

16. Toshiba/Carrier VRF training mandatory.
17. A list of county-supplied equipment and drawings will be given at mandatory site visit. You must visit job site and sign in on the provided sign-in sheet to be an accepted bidder. Contact Sandra Crenshaw, 1st Deputy, Board of County Commissioners at 918-423-1338 to schedule on or before Friday, August 26, 2022 during regularly schedule county operating hours of 8:00 a.m. and 4:00 p.m.

Job Site Address: Southeast Expo Center
4500 W US Hwy 270
McAlester, Oklahoma

RESOLUTION

NO. 23-021

The Board of County Commissioners, Pittsburg County, Met in regular session Monday, August 8TH, 2022.

WHEREAS, the **SHERIFF'S OFFICE** wishes to cancel the following Purchase Order 484 to Bank of America dated July 13th, 2022 in the amount of \$269.00 for Milwaukee 3/8 Impact Wrench Kit.

WHEREAS, the purchase order was not used, therefore it is no longer needed.

THEREFORE BE IT RESOLVED, Pittsburg County Commissioners do hereby cancel Purchase Order 484 for FY 2022-2023.

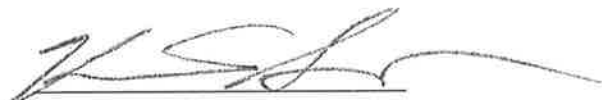
CHAIRMAN

MEMBER

MEMBER



ATTEST:

COUNTY CLERK



Trane U.S. Inc.
3600 Pammel Creek Road
La Crosse, WI 54601-7599
United States

Invoice

Invoice Number **312828131**

For questions please contact:

Oklahoma City TCS SO, OK
Tel: 405-943-6600
Fax: 405-789-5681

Remit Payment To

Trane U.S. Inc.
P. O. Box 845053
DALLAS, TX 75284-5053

Invoice Date **28-JUL-2022**
Customer No. **726304**
Reference No. **L250148**
Internal Account **4158426**
Payment Terms **.5%10 NET30**
Payment Due Date **27-Aug-2022**
Discount Date **07-Aug-2022**

Bill To

PITTSBURG COUNTY SHERIFFS OFFICE
115 E CARL ALBERT PARKWAY
MCALESTER, OK 74501
UNITED STATES

Customer Tax ID

Inco Terms	
Supply Location	Oklahoma City TCS SO, OK
Shipping Method	
Tracking No.	
Freight Terms	
Bill of Lading	

Sold To

PITTSBURG COUNTY SHERIFFS OFFI
115 E CARL ALBERT PARKWAY
MCALESTER, OK 74501
UNITED STATES

Ship To

115 E CARL ALBERT PARKWAY
MCALESTER, OK 74501

<https://www.tranetechnologies.com/customer>

CERTifyTax - for submittal of tax exemption certificates.

iReceivables - access invoice copies, account balances & make payments.

846310011

Tax/GST ID: 25-0900465	State Tax: 0.00 0.0000%	County Tax: 0.00 0.0000%	City Tax: 0.00 0.0000%	District Tax: 0.00 0.0000%
PST/QST ID:	OK	PITTSBURG	MCALESTER	

Currency	Subtotal	Special Charges	Tax	Freight	Total
USD	79650.00	0.00	0.00	0.00	79650.00

Special Instructions Pittsburg County Jail

Contract No.	Contract Date	Ship Date	Purchase Order
CID00097752	27-DEC-2021	31-JUL-2022	Signed Proposal

Application No. 06 for work completed thru 31-JUL-2022

- | | | | |
|---------------------------------|--------------|--|--------------|
| 1. ORIGINAL CONTRACT SUM: | \$280,629.00 | 4. TOTAL COMPLETED & STORED TO DATE: | \$136,500.00 |
| 2. NET CHANGE BY CHANGE ORDERS: | \$0.00 | a. Percentage Completed: | 48.64% |
| 3. CONTRACT SUM TO DATE: | \$280,629.00 | 5. RETAINAGE: | |
| | | a. 0.00% of Completed Work: | \$0.00 |
| | | b. 0.00% of Stored Material: | \$0.00 |
| | | Total Retainage: | \$0.00 |
| | | 6. TOTAL EARNED LESS RETAINAGE: | \$136,500.00 |
| | | 7. LESS PREVIOUS REQUESTS FOR PAYMENT: | \$56,850.00 |

Sections Included: Summary Sheet and Detail Sheet(s)

- | | |
|---|--------------------|
| 8. CURRENT PROJECT PAYMENT DUE: | \$79,650.00 |
| (Before Applicable Sales Taxes) | |
| 9. Applicable Sales Taxes: | \$0.00 |
| 10. Amount Due This Requisition: | \$79,650.00 |
| Currency: USD | |

PLEASE REFERENCE NUMBER 312828131 WITH YOUR PAYMENT

APPLICATION AND CERTIFICATION FOR PAYMENT (SUMMARY SHEET)

846310011

Invoice: 312828131

To: PITTSBURG COUNTY SHERIFFS OFFICE

CONTRACT NAME: PITTSBURG COUNTY JAIL

APPLICATION NO: 06
 APPLICATION DATE: 28-JUL-2022
 PERIOD TO: 31-JUL-2022
 CUST PO NO: Signed Proposal

From: Trane
 305 HUDIBURG CIRCLE
 OKLAHOMA CITY, OK 73108

CONTRACT LOCATION: 115 E CARL ALBERT PARKWAY
 MCALESTER, OK 74501

CONTRACT DATE: 27-DEC-2021
 CONTRACT NO: CID00097752

APPLICATION FOR PAYMENT

Application is made for payment, as shown below, in connection with the Contract:

The undersigned Company Certifies that to the best of the Company's knowledge, information and belief, the work covered by this Application For Payment has been completed in accordance with the Contract Documents, and that current payment shown herein is now due

1 ORIGINAL CONTRACT SUM: \$280,629.00

2 NET CHANGE BY CHANGE ORDERS: \$0.00

3 CONTRACT SUM TO DATE (Line 1 +/- 2) \$280,629.00

4 TOTAL COMPLETED & STORED TO DATE: \$136,500.00
 (Column G on Detail Sheet)

5 RETAINAGE: \$0.00

a. 0.00% of Completed Work: \$0.00
 (Columns D + E on Detail Sheet)
 b. 0.00% of Stored Material: \$0.00
 (Column F on Detail Sheet)

Total Retainage: \$0.00
 (Line 5a+5b or Total in Column I of Detail Sheet)

6 TOTAL EARNED LESS RETAINAGE: \$136,500.00
 (Line 4 less Line 5 Total)

7 LESS PREVIOUS CERTIFICATES FOR PAYMENT: \$56,850.00
 (Line 6 from prior Certificate)

8 CURRENT PAYMENT DUE: \$79,650.00
 (Before Applicable Sales Taxes)

9 BALANCE TO FINISH, INCLUDING RETAINAGE: \$144,129.00
 (Line 3 less line 6)

CHANGE ORDER SUMMARY	ADDITIONS	DEDUCTIONS
Total changes approved in previous months	\$0.00	\$0.00
Total approved this Month	\$0.00	\$0.00
TOTALS	\$0.00	\$0.00
NET CHANGE BY CHANGE ORDERS:	\$0.00	

COMPANY: Trane
 BY: _____ Date: _____
 State of: _____
 County of: _____
 Subscribed and sworn to before
 Me this _____ day of _____
 My Commission expires: _____

CERTIFICATE FOR PAYMENT

In accordance with the Contract Documents, based on on-site observations and the data comprising this application, the undersigned company Certifies that to the best of their knowledge, information and belief, the Work has progressed as indicated, the quality of the Work is in accordance with the Contract Documents, and the company indicated above is entitled to payment of the AMOUNT CERTIFIED.

AMOUNT CERTIFIED \$79,650.00

(Attach explanation if amount certified differs from the amount applied for. Initial all figures on this Application and on the Detail Sheet that are changed to conform to the amount certified.)

CERTIFIER: _____ Date: _____
 BY: _____
 ACCEPTANCE: _____ Date: _____
 BY: _____

This Certificate is not negotiable. The AMOUNT CERTIFIED is payable only to the company named herein. Issuance, payment and acceptance of payment are without prejudice to any rights of the party under this Contract.

DETAIL SHEET

846310011

Invoice: 312828131

APPLICATION AND CERTIFICATE FOR PAYMENT,
Containing Certification is attached

APPLICATION NO: 06
APPLICATION DATE: 28-JUL-2022
PERIOD TO: 31-JUL-2022

CUST PO NO:
CONTRACT DATE:
CONTRACT NO:

Signed Proposal
27-DEC-2021
CID000097752

A No.	B DESCRIPTION OF WORK	C SCHEDULED VALUE	D WORK COMPLETED		E THIS PERIOD	F MATERIALS PRESENTLY STORED (NOT IN D OR E)	G TOTAL COMPLETED AND STORED TO DATE (D+E+F)	H % (G/C)	I BALANCE TO FINISH (C-G)	J RETAINAGE
			FROM PREVIOUS APPLICATION (D+E)	THIS PERIOD						
1	HVAC	141,000.00	0.00	79,650.00	0.00	79,650.00	56.49%	61,350.00	0.00	
2	Engineering a Submittals	7,955.00	2,270.00	0.00	0.00	2,270.00	28.54%	5,685.00	0.00	
3	Controls Installation Labor	79,024.00	9,580.00	0.00	0.00	9,580.00	12.12%	69,444.00	0.00	
4	Controls Material	52,650.00	45,000.00	0.00	0.00	45,000.00	85.47%	7,650.00	0.00	
TOTAL		280,629.00	56,850.00	79,650.00	0.00	136,500.00	48.64%	144,129.00	0.00	

From: Leslie.Salsbury@Ferguson.com
Sent: Thursday, August 4, 2022 1:14 PM
To: pittsburgcounty@hotmail.com
Subject: 6 month bid

Hi Sandra,

Unfortunately we will have to withdraw our bid as we bid the wrong pipe.

Thank you for your understanding in this.

THANK YOU

Leslie Salsbury

Outside Muncipal/Rural Sales

RuralWater.MunicipalSales@ferguson.com

leslie.salsbury@ferguson.com

O: 405-672-3828



Credit Application: [Customer Application](#)

Due to COVID-19, we ask that you look at using [ferguson.com](https://www.ferguson.com) as a tool to help make purchases and monitor your Ferguson account while adhering to the social distancing recommendations.

If you do not already have an account with [ferguson.com](https://www.ferguson.com), click [here](#) to register.

SMS/MMS

Wednesday, August 3, 2022



Leslie Salsbury: Hi Tammy
This is Leslie @ Ferguson
Waterworks

We need to see if we can
withdraw our bid, the type
of pipe was overlooked and
we bid the wrong pipe.

MMS

3:31 PM

You will have to contact
the court house ... Sandra
in County Commissioners
office 19184231338

4:34 PM



STATE OF OKLAHOMA
 COUNTY OF PITTSBURG
 APPLICATION FOR PERMIT
 PUBLIC SERVICE/PIPELINE CROSSING

We, the under-signed, hereby petition the Board of County Commissioners, Pittsburg County, to grant a permit for a public service, pipeline crossing, ingress and egress, or line installation as described below and in accordance with the provisions as listed.

PLEASE PRINT
 PUBLIC SERVICE/PIPELINE OWNER NAME: Riverside Midstream Water Resources, LLC

CONTACT: Kristina Garmon EMAIL: kgarmon@calyxenergy.com

ADDRESS: 6120 S Yale Ave Ste 1480 PHONE: 918-949-4224

CITY: Tulsa STATE: OK ZIP CODE: 74136

CONSTRUCTION COMPANY NAME: DeWitt Trucking and Excavation

CONTACT: David DeWitt EMAIL: david@dewittok.com

ADDRESS: 4601 N Westpoint Road PHONE: 580-669-2534

CITY: Glencoe STATE: OK ZIP CODE: 74032

TYPE OF INSTALLATION (Please mark all boxes that apply)				
<input type="checkbox"/> Electric	<input checked="" type="checkbox"/> Permanent Line	<input checked="" type="checkbox"/> Salt Water	<input type="checkbox"/> Residential	<input checked="" type="checkbox"/> Boring
<input type="checkbox"/> Gas	<input type="checkbox"/> Temporary Line	<input type="checkbox"/> Fresh Water	<input checked="" type="checkbox"/> Commercial	<input type="checkbox"/> Trenching
<input type="checkbox"/> Oil		<input type="checkbox"/> Other	<input type="checkbox"/> Agricultural	<input type="checkbox"/> In/Through existing culvert
<input checked="" type="checkbox"/> Water			<input checked="" type="checkbox"/> Oil/Gas Service Road	<input type="checkbox"/> Temporary Road Cross Bridge
<input type="checkbox"/> Telephone			<input type="checkbox"/> Other	<input type="checkbox"/> Other:
<input type="checkbox"/> Sewer				
<input type="checkbox"/> Other				

This permit is to erect, construct and maintain a pipeline along, upon and across the hereinafter said county highway/road for the purpose of transporting, selling, and using water.

LOCATION

Beginning at 35.0983861, -95.9899417 and cross freeway route Lott Bottom Rd
GPS Location (in decimals) Cross or Parallel County Road Name

Approximately .34 miles West of High Low Rd and ending at
North, South, East, West Name of Closest Intersecting Road or Highway

35.0973250, -095.9894000 Embraced in Section 12 Township 7E Range 12N
GPS Location (in decimals)

PIPELINES	ELECTRIC
SIZE <u>10"</u> ALLOY/MATERIAL <u>SDR11 HDPE Poly</u> WALL THICKNESS <u>1 5/8"</u> CONTENTS <u>Water</u> MFG. TEST PRESSURE <u>200 PSI</u> MAX. OPERATING PRESSURE <u>160 PSI</u> WORKING PRESSURE <u>160 PSI</u>	VOLTAGE _____ CONDUCTOR SIZE _____ TYPE OF STRUCTURE _____ RULING SPAN _____
COMMUNICATIONS	SERVICE ENTRANCE
WIRES/PAIRS/STRANDS _____ GAUGE _____ CABLE TYPE _____	DIAMETER OF CULVERT PIPE _____ LENGTH OF CULVERT PIPE _____

CASING
 SIZE _____ ALLOY/MATERIAL _____ WALL THICKNESS _____

FLOODPLAIN ADMINISTRATOR'S REVIEW

Upon review, I, Tawanna Cathey, a Floodplain Administrator for Pittsburg County, have determined that the above-referenced public service/pipeline crossing permit:

_____ Does Does Not

fall within any floodplain.

Tawanna Cathey
 Signature, Pittsburg County Floodplain Administrator

(Administrator: Please attach a copy of the floodplain permit and receipt where permit was paid if road crossing is within a floodplain)

If granted, this permit is subject to the following conditions, requirements and covenants, to-wit, please initial that you have read each condition, requirement or covenant:

1. Applicant/contractor is aware that all road crossing permits for PITTSBURG COUNTY shall require approval from the Pittsburg County Floodplain Administrator's Office and that all permits and fees owed to the Floodplain Administrator's Office will be paid in full before approval is given by the Board of County Commissioners.

Initial: KG

2. Application for road crossing must be submitted **no later than 5 days before a meeting** of the Board of County Commissioners with a check for the amount of permit made payable to the Pittsburg County Commissioners. The petitioner/contractor shall contact the County Commissioners Office at the completion of crossing for an onsite inspection.

Initial: KG

3. The applicant must agree to hold Pittsburg County harmless for any damage or injury to persons or property caused by or resulting from the construction, maintenance, operation, or repair of the facilities on, under, or over the County right-of-way. The petitioner/contractor will be responsible for any damage resulting from deviation of the plat.

Initial: KG

4. All crossings shall be bored on blacktop/asphalt roads. Cutting may be permitted on dirt roads, ditches, or other surfaces with approval from the Board of County Commissioners. Blasting is not permitted.

Initial: KG

5. In construction pipelines or utility routes that cross county highways or roads, NO DITCH, TRENCH, OR BORING, shall be done by the applicant/contractor until approved by the Board of County Commissioners. All ditching and trenching shall be completed to the County Commissioner's specifications. Applicants, contractors or owners shall maintain crossing. (Signs, grass, brush control, etc.)

Initial: KG

6. The petitioner/contractor shall furnish all flag men, lights, barricades, and warning signs meeting all laws and regulations, including those in the "Manual on Uniform Traffic Control Devices" appropriate for the construction project. The petitioner/contractor agrees to keep the road open to traffic unless approved by the Board of County Commissioners. At the conclusion of such work, the right-of-way must be in a presentable condition.

Initial: KG

7. When notified to do so by the Board of County Commissioners, the petitioner/contractor agrees at their expense to make all changes in the facility on County right-of-way.

Initial: KG

8. Relocation – Applicant, upon 30 days written notice, agrees to relocate utilities at their expense should it interfere with County construction and/or maintenance.

Initial: KG

9. Aerial facilities – Clearance above the traffic lanes of the road at all aerial pole line crossings shall comply with applicable safety codes and will not be less than 20 feet. All poles, posts, stubs, fixtures, down guys, wires, and other appurtenances must be kept in good repair at all times and free from weeds and brush within a 5-foot area of the installation. These facilities, when paralleling the roadway, shall be single pole construction and located within 3 feet of the fence line, if a fence exists. If no fence exists, the right-of-way shall be located by an Oklahoma Registered Land Surveyor at the petitioner's expense and a copy provided to the Board prior to construction. All crossings shall be as nearly perpendicular as possible. Facility shall not interfere with the natural flow of waters or ditch.

Initial: KG

10. Underground facilities – All shall be a minimum of 5 feet below the elevation of the center line of the road, but not less than 4 feet below the bottom of the ditch. Crossings shall be encased from right-of-way line to right-of-way line and be vented off the right-of-way lines. Concrete caps of 4' wide and 6" deep may be required from edge of road to fence line. Identification markers shall be installed at each right-of-way line directly above the facility. The markers must identify the owner's name, address and telephone

number, size of facility, and emergency contact number in black with a yellow background. Marker must be at least 130 sq. inches in area and erected at a height plainly visible from the road right-of-way.

All underground electric cable crossings must be placed in a conduit and be a minimum of 4 feet below the ditch flow lines. Conduit placed beneath a roadway must be steel, HDPE, heavy-duty PVC, or fiberglass if it is designed to withstand roadway loading and is properly protected.

Steel pipelines crossing the right-of-way may be, upon approve of the Commissioner, installed without encasement if the carrier pipe material within the right-of-way is superior to the carrier pipe material outside the right-of-way by being of steel at least one grade better and of the same wall thickness, or a minimum of one wall thickness greater and of the same alloy. Pipe must be properly protected from corrosion.

Facilities such as water and sanitary sewer lines crossing the county right-of-way shall be encased. Maintenance will be performed by a method that will not disturb the through lanes or interfere with traffic. All conduits shall be sufficient to withstand roadway loadings.

Initial: KG

11. All section corners and ¼ section corners shall be protected. No pipeline or utility line shall cross an intersection diagonally. No liens shall cross within 50 feet of a ¼ section corner or 100' of a bridge.

Initial: KG

12. Owners of all facilities shall be responsible, at their own expense, for decommissioning of sites. Roads and right-of-way shall be restored to the original condition or better.

Initial: KG

13. All road crossings shall comply with all Department of Transportation and/or Oklahoma Corporation Commission pipeline safety standards rules and regulations in effect at the time of the permit.

Initial: KG

14. All pipelines made of non-metallic materials must have a tracer wire installed so the pipeline can be located from above the ground.

Initial: KG

15. Above ground water lines are temporary and shall be placed within three (3) feet of fence line or county right-of-way as not to disrupt road maintenance. All temporary water lines shall be marked or identified with a company contact number or sign at every county road crossing.

The type of temporary road crossing, either above the road surface or trenched, are at the discretion of the individual commissioner. Trenched lines shall be at sufficient depth as to not interfere with normal maintenance and shall be removed at applicant's expense. The owner, firm or company requesting the permit for temporary or permanent line(s) shall be responsible for all damages to county roads or right-of-way caused by such installation. Temporary installation permits are for a period of thirty (30) days. A new permit will be required for each thirty (30) day time period.

Initial: KG

16. Any pipe or tin horns to be installed shall be a beveled end at a 45° angle with concrete end treatments. The commissioner shall approve proper diameter of pipe.

Initial: KG

FEE SCHEDULE
(Check must accompany permit)

Floodplain Inspection Fee (if necessary).....	\$50.00 each
Floodplain Oil & Gas Pipeline Burial Permit Fee	\$300.00 each
Floodplain Permit extension	1/2 of permit fee each
(all floodplain permits expire 6 months for original permit date)	
Road Bore – Permanent	\$1,000.00 each
Domestic or livestock water 3" diameter or less	N/C
Cut or trenched permanent.....	\$1,500.00 each
Temporary lines through culverts/bridges	\$1,500.00 each
Temporary buried line, cut or trenched	\$1,500.00 each
Temporary Road Crossing Bridge	\$1,500.00 each

NOTE: FAILURE TO NOTIFY COMMISSIONERS OF HEAVY LOAD MOVEMENT OR IF A LINE OR SERVICE ENTRANCE IS PLACED IN COUNTY RIGHT-OF-WAY WITHOUT THE PROPER PERMIT(S) MAY RESULT IN A FINE UP TO \$5,000 PLUS COURT COSTS

PETITIONER/CONTRACTOR'S ATTESTMENT

I hereby attest to the accuracy of the information contained on this application. I further certify that, in my professional opinion, the facility line is installed; the drawings, plans and specifications therefore comply in all respects with the requirement of said permit.

Hester Adam
Petitioner/Contractor Signature

07/19/2022
Date

Production Technician
Title

918-949-4224
Phone Number

PERMIT APPROVAL

The undersigned Board of County Commissioners, Pittsburg County, do hereby grant the crossing described in the application hereinabove set forth; provided that, the same shall be subject to the terms and conditions of the application incorporated herein by this reference.

Approved on the 5th day of August, 20 22.

Pittsburg County District # 3

Company Check# _____ Date of Check _____ Amount of Check _____

COMMISSIONERS COMMENTS/CHANGES:

BOARD OF COUNTY COMMISSIONERS
PITTSBURG COUNTY, OKLAHOMA

ATTEST:



[Signature]
District 1 Commissioner

[Signature]
District 2 Commissioner

[Signature]
District 3 Commissioner

[Signature]
County Clerk

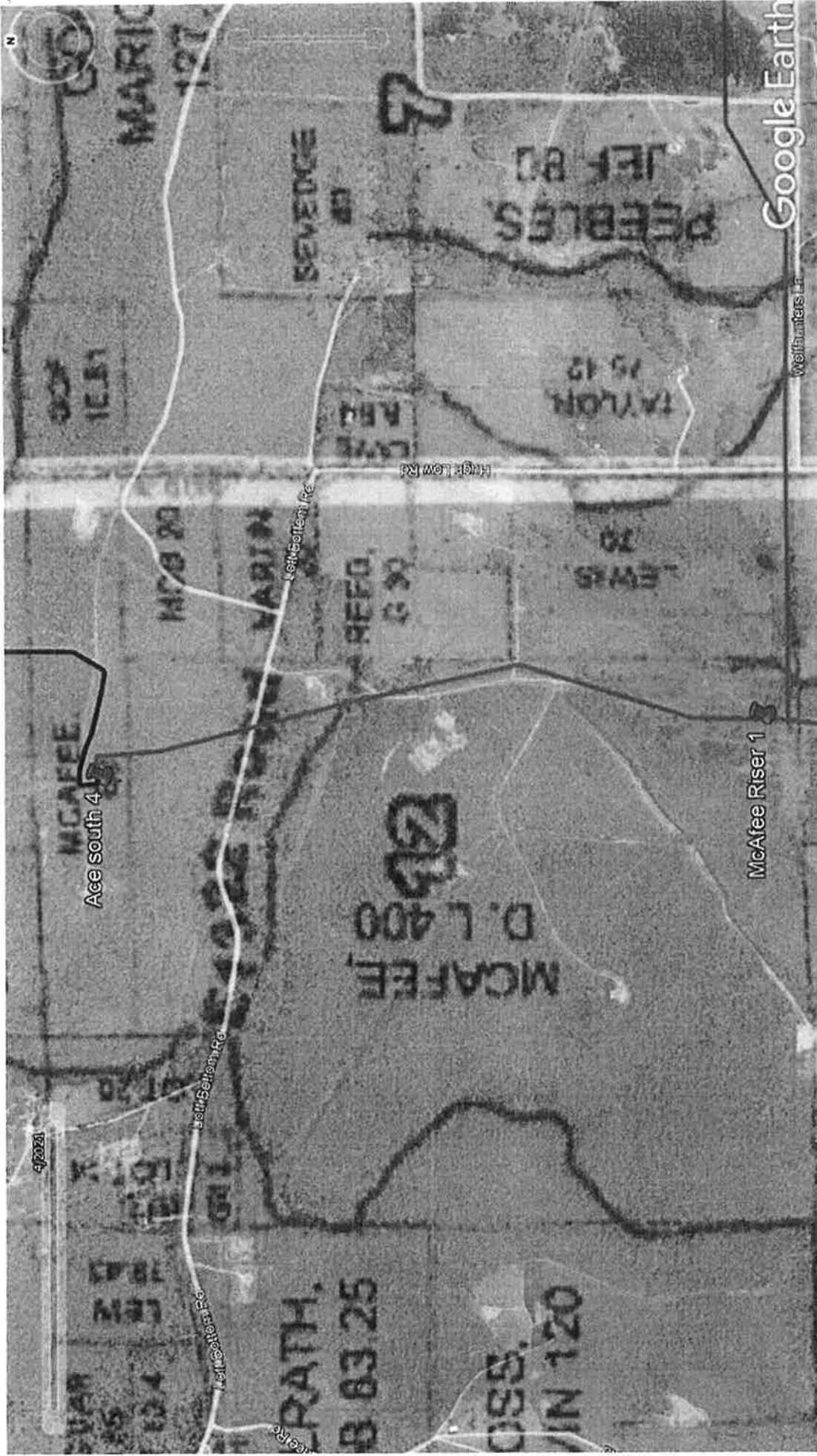

STATE OF OKLAHOMA
 COUNTY OF PITTSBURG
 APPLICATION FOR PERMIT
 PUBLIC SERVICE/PIPELINE CROSSING

We, the undersigned, hereby petition the Board of County Commissioners, Pittsburg County, to grant a permit for a public service, pipeline crossing, ingress and egress, or line installation as described below and in accordance with the provisions as listed.

PLEASE PRINT

PUBLIC SERVICE/PIPELINE OWNER NAME: Tall Oak Woodford, LLC

CONTACT: Brandon Burr EMAIL: bburr@talloakmidstream.com

ADDRESS: 2575 Kelley Pointe Parkway Ste. 340 PHONE: _____

CITY: Edmond STATE: OK ZIP CODE: 73013

CONSTRUCTION COMPANY NAME: TBD

CONTACT: _____ EMAIL: _____

ADDRESS: _____ PHONE: _____

CITY: _____ STATE: _____ ZIP CODE: _____

TYPE OF INSTALLATION (Please mark all boxes that apply)				
<input type="checkbox"/> Electric	<input checked="" type="checkbox"/> Permanent Line	<input type="checkbox"/> Salt Water	<input type="checkbox"/> Residential	<input checked="" type="checkbox"/> Boring
<input checked="" type="checkbox"/> Gas	<input type="checkbox"/> Temporary Line	<input type="checkbox"/> Fresh Water	<input type="checkbox"/> Commercial	<input type="checkbox"/> Trenching
<input type="checkbox"/> Oil		<input type="checkbox"/> Other	<input type="checkbox"/> Agricultural	<input type="checkbox"/> In/Through existing culvert
<input type="checkbox"/> Water			<input type="checkbox"/> Oil/Gas Service Road	<input type="checkbox"/> Temporary Road Cross Bridge
<input type="checkbox"/> Telephone			<input type="checkbox"/> Other	<input type="checkbox"/> Other:
<input type="checkbox"/> Sewer				
<input type="checkbox"/> Other				

This permit is to erect, construct and maintain a Pipeline along, upon and across the hereinafter said county highway/road for the purpose of transporting, selling, and using natural gas.

LOCATION

Beginning at 35.101496, -95.948294 and cross freeway route Ragan Road
GPS Location (in decimals) Cross or Parallel County Road Name

Approximately 5178 FT miles North of Ragan and Wolfhunters Jct and ending at
North, South, East, West Name of Closest Intersecting Road or Highway

35.101497, -95.947862 Embraced in Section 8 Township 7N Range 13E
GPS Location (in decimals)

PIPELINES	ELECTRIC
SIZE <u>12"</u> ALLOY/MATERIAL <u>Carbon Steel</u> WALL THICKNESS <u>.375</u> CONTENTS <u>Natural Gas</u> MFG. TEST PRESSURE <u>2610 psig</u> MAX. OPERATING PRESSURE <u>1440 psig</u> WORKING PRESSURE <u>1300 psig</u>	VOLTAGE _____ CONDUCTOR SIZE _____ TYPE OF STRUCTURE _____ RULING SPAN _____
COMMUNICATIONS	SERVICE ENTRANCE
WIRES/PAIRS/STRANDS _____ GAUGE _____ CABLE TYPE _____	DIAMETER OF CULVERT PIPE _____ LENGTH OF CULVERT PIPE _____

CASING
 SIZE N/A ALLOY/MATERIAL _____ WALL THICKNESS _____

FLOODPLAIN ADMINISTRATOR'S REVIEW

Upon review, I, Tawana Cathey, a Floodplain Administrator for Pittsburg County, have determined that the above-referenced public service/pipeline crossing permit:

_____ Does X Does Not

fall within any floodplain.

Tawana Cathey
 Signature, Pittsburg County Floodplain Administrator

(Administrator: Please attach a copy of the floodplain permit and receipt where permit was paid if road crossing is within a floodplain)

If granted, this permit is subject to the following conditions, requirements and covenants, to-wit, please initial that you have read each condition, requirement or covenant:

1. Applicant/contractor is aware that all road crossing permits for PITTSBURG COUNTY shall require approval from the Pittsburg County Floodplain Administrator's Office and that all permits and fees owed to the Floodplain Administrator's Office will be paid in full before approval is given by the Board of County Commissioners.

Initial: BB

2. Application for road crossing must be submitted **no later than 5 days before a meeting** of the Board of County Commissioners with a check for the amount of permit made payable to the Pittsburg County Commissioners. The petitioner/contractor shall contact the County Commissioners Office at the completion of crossing for an onsite inspection.

Initial: BB

3. The applicant must agree to hold Pittsburg County harmless for any damage or injury to persons or property caused by or resulting from the construction, maintenance, operation, or repair of the facilities on, under, or over the County right-of-way. The petitioner/contractor will be responsible for any damage resulting from deviation of the plat.

Initial: BB

4. All crossings shall be bored on blacktop/asphalt roads. Cutting may be permitted on dirt roads, ditches, or other surfaces with approval from the Board of County Commissioners. Blasting is not permitted.

Initial: BB

5. In construction pipelines or utility routes that cross county highways or roads, NO DITCH, TRENCH, OR BORING, shall be done by the applicant/contractor until approved by the Board of County Commissioners. All ditching and trenching shall be completed to the County Commissioner's specifications. Applicants, contractors or owners shall maintain crossing. (Signs, grass, brush control, etc.)

Initial: BB

6. The petitioner/contractor shall furnish all flag men, lights, barricades, and warning signs meeting all laws and regulations, including those in the "Manual on Uniform Traffic Control Devices" appropriate for the construction project. The petitioner/contractor agrees to keep the road open to traffic unless approved by the Board of County Commissioners. At the conclusion of such work, the right-of-way must be in a presentable condition.

Initial: BB

7. When notified to do so by the Board of County Commissioners, the petitioner/contractor agrees at their expense to make all changes in the facility on County right-of-way.

Initial: BB

8. Relocation - Applicant, upon 30 days written notice, agrees to relocate utilities at their expense should it interfere with County construction and/or maintenance.

Initial: BB

9. Aerial facilities - Clearance above the traffic lanes of the road at all aerial pole line crossings shall comply with applicable safety codes and will not be less than 20 feet. All poles, posts, stubs, fixtures, down guys, wires, and other appurtenances must be kept in good repair at all times and free from weeds and brush within a 5-foot area of the installation. These facilities, when paralleling the roadway, shall be single pole construction and located within 3 feet of the fence line, if a fence exists. If no fence exists, the right-of-way shall be located by an Oklahoma Registered Land Surveyor at the petitioner's expense and a copy provided to the Board prior to construction. All crossings shall be as nearly perpendicular as possible. Facility shall not interfere with the natural flow of waters or ditch.

Initial: BB

10. Underground facilities - All shall be a minimum of 5 feet below the elevation of the center line of the road, but not less than 4 feet below the bottom of the ditch. Crossings shall be encased from right-of-way line to right-of-way line and be vented off the right-of-way lines. Concrete caps of 4' wide and 6" deep may be required from edge of road to fence line. Identification markers shall be installed at each right-of-way line directly above the facility. The markers must identify the owner's name, address and telephone

number, size of facility, and emergency contact number in black with a yellow background. Marker must be at least 130 sq. inches in area and erected at a height plainly visible from the road right-of-way.

All underground electric cable crossings must be placed in a conduit and be a minimum of 4 feet below the ditch flow lines. Conduit placed beneath a roadway must be steel, HDPE, heavy-duty PVC, or fiberglass if it is designed to withstand roadway loading and is properly protected.

Steel pipelines crossing the right-of-way may be, upon approve of the Commissioner, installed without encasement if the carrier pipe material within the right-of-way is superior to the carrier pipe material outside the right-of-way by being of steel at least one grade better and of the same wall thickness, or a minimum of one wall thickness greater and of the same alloy. Pipe must be properly protected from corrosion.

Facilities such as water and sanitary sewer lines crossing the county right-of-way shall be encased. Maintenance will be performed by a method that will not disturb the through lanes or interfere with traffic. All conduits shall be sufficient to withstand roadway loadings.

Initial: BB

11. All section corners and ¼ section corners shall be protected. No pipeline or utility line shall cross an intersection diagonally. No liens shall cross within 50 feet of a ¼ section corner or 100' of a bridge.

Initial: BB

12. Owners of all facilities shall be responsible, at their own expense, for decommissioning of sites. Roads and right-of-way shall be restored to the original condition or better.

Initial: BB

13. All road crossings shall comply with all Department of Transportation and/or Oklahoma Corporation Commission pipeline safety standards rules and regulations in effect at the time of the permit.

Initial: BB

14. All pipelines made of non-metallic materials must have a tracer wire installed so the pipeline can be located from above the ground.

Initial: BB

15. Above ground water lines are temporary and shall be placed within three (3) feet of fence line or county right-of-way as not to disrupt road maintenance. All temporary water lines shall be marked or identified with a company contact number or sign at every county road crossing.

The type of temporary road crossing, either above the road surface or trenched, are at the discretion of the individual commissioner. Trenched lines shall be at sufficient depth as to not interfere with normal maintenance and shall be removed at applicant's expense. The owner, firm or company requesting the permit for temporary or permanent line(s) shall be responsible for all damages to county roads or right-of-way caused by such installation. Temporary installation permits are for a period of thirty (30) days. A new permit will be required for each thirty (30) day time period.

Initial: BB

16. Any pipe or tin horns to be installed shall be a beveled end at a 45° angle with concrete end treatments. The commissioner shall approve proper diameter of pipe.

Initial: BB

FEE SCHEDULE
(Check must accompany permit)

Floodplain Inspection Fee (if necessary).....	\$50.00 each
Floodplain Oil & Gas Pipeline Burial Permit Fee	\$300.00 each
Floodplain Permit extension	1/2 of permit fee each
(all floodplain permits expire 6 months for original permit date)	
Road Bore - Permanent	\$1,000.00 each
Domestic or livestock water 3" diameter or less	N/C
Cut or trenched permanent.....	\$1,500.00 each
Temporary lines through culverts/bridges	\$1,500.00 each
Temporary buried line, cut or trenched	\$1,500.00 each
Temporary Road Crossing Bridge	\$1,500.00 each

NOTE: FAILURE TO NOTIFY COMMISSIONERS OF HEAVY LOAD MOVEMENT OR IF A LINE OR SERVICE ENTRANCE IS PLACED IN COUNTY RIGHT-OF-WAY WITHOUT THE PROPER PERMIT(S) MAY RESULT IN A FINE UP TO \$5,000 PLUS COURT COSTS

PETITIONER/CONTRACTOR'S ATTESTMENT

I hereby attest to the accuracy of the information contained on this application. I further certify that, in my professional opinion, the facility line is installed; the drawings, plans and specifications therefore comply in all respects with the requirement of said permit.



Petitioner/Contractor Signature

7/25/2022

Date

Project Coordinator

Title

405-562-9434

Phone Number

PERMIT APPROVAL

The undersigned Board of County Commissioners, Pittsburg County, do hereby grant the crossing described in the application hereinabove set forth; provided that, the same shall be subject to the terms and conditions of the application incorporated herein by this reference.

Approved on the 8th day of August, 2022.

Pittsburg County District # _____

Company Check# 1196 Date of Check 7/19/2022 Amount of Check 1,000.00

COMMISSIONERS COMMENTS/CHANGES:

BOARD OF COUNTY COMMISSIONERS
PITTSBURG COUNTY, OKLAHOMA

ATTEST:



[Signature]
District 1 Commissioner

[Signature]
District 2 Commissioner

[Signature]
District 3 Commissioner

[Signature]
County Clerk

Exhibit A

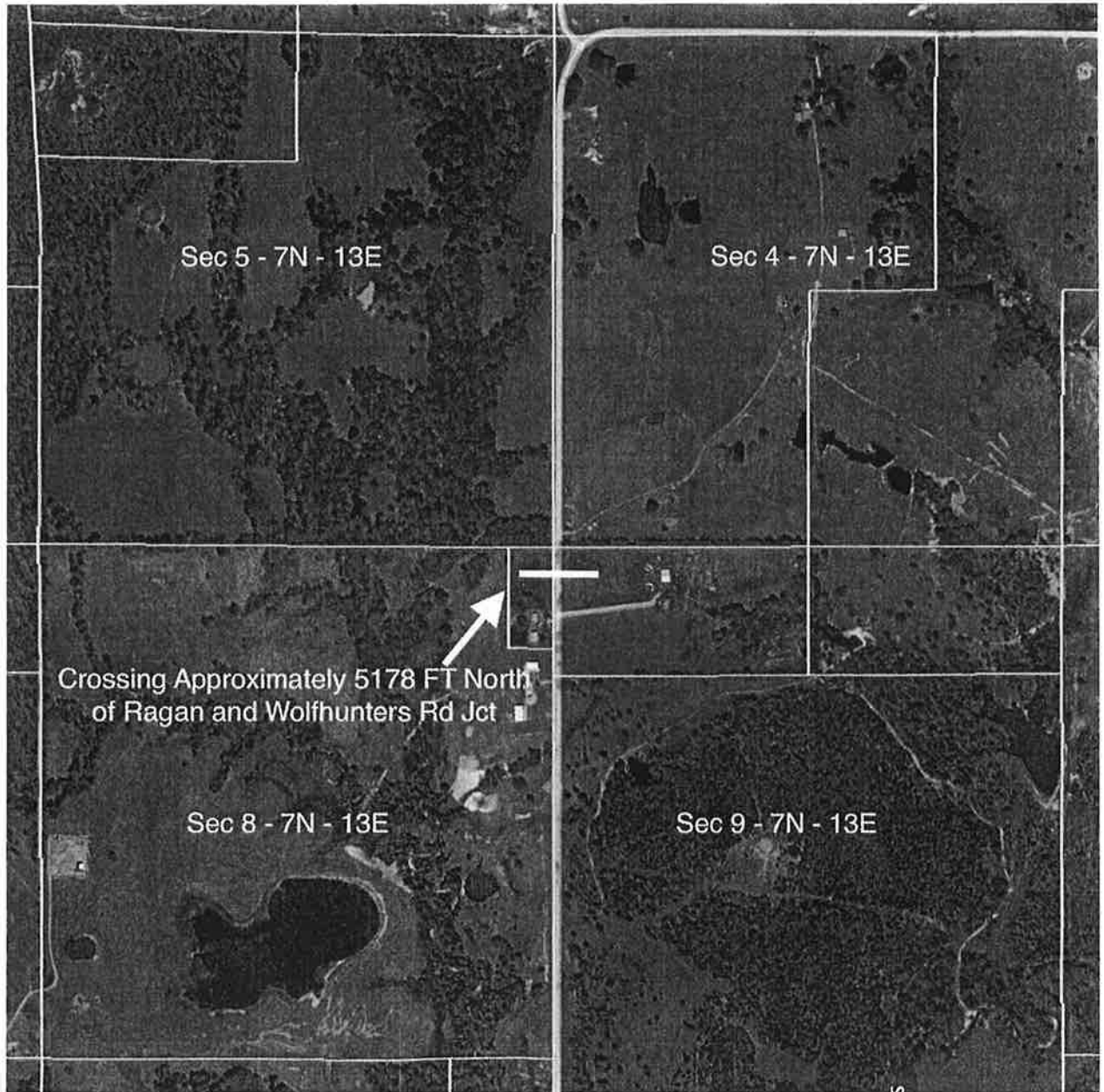

Bore Profile

SECTIONS 9 & 8,
T 07 N - R 13 E, I.M.,
PITTSBURG COUNTY, OKLAHOMA

BEARINGS ARE GRID
SPC, NAD 83, OKLAHOMA SOUTH

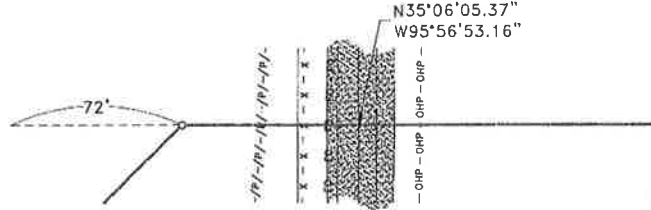

PLAN

HORIZ. SCALE: 1" = 60'

VICINITY MAP: N.T.S.

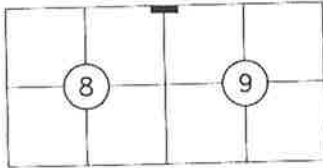

PLAN AND PROFILE SHOWING A PROPOSED TALL OAK PIPELINE CROSSING RAGAN RD. BEING 5178 FEET NORTH OF RAGAN RD. AND WOLFHUNTERS RD. JCT. AND 104 FEET SOUTH OF THE APPROX. NE COR. SEC. 8, BETWEEN SECTIONS 9 AND 8, TWP 7N, RNG 13E, PITTSBURG COUNTY, OKLAHOMA

PROFILE

HORIZ. SCALE: 1" = 60'
VERT. SCALE: 1" = 12'

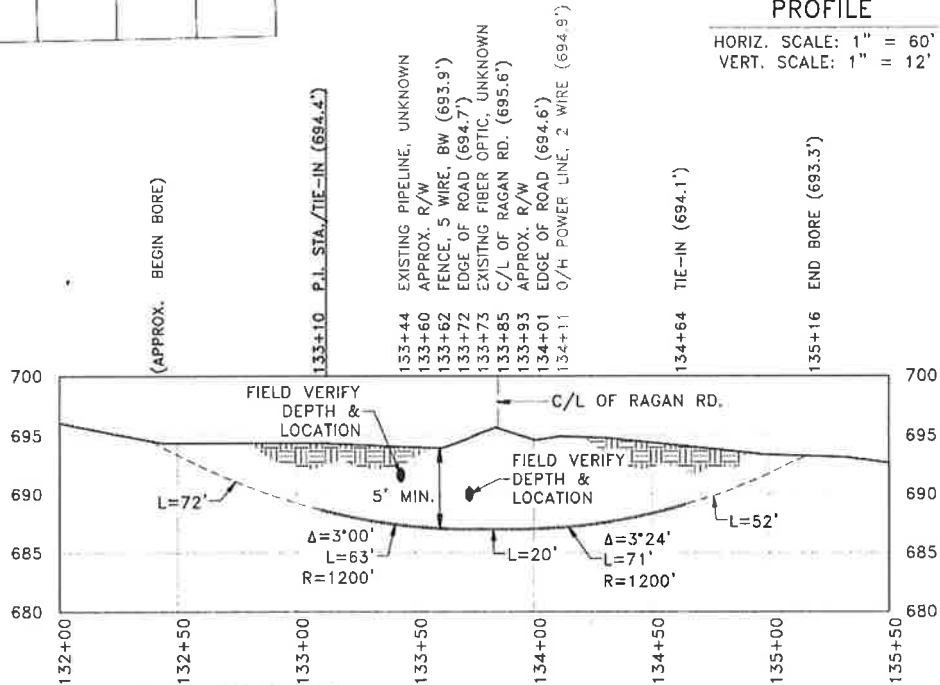

SOLERA OF DISCHARGE

12" O.D. X 0.375 W.T.,
ARO

ENTRY TO TIE-IN TO TIE-IN
= 278' = 154'

NOTE:

This exhibit represents a proposed pipeline route for eventual easement acquisition. The footages and lines shown hereon are from lines of occupation and do not reflect actual property lines. This exhibit does not comply with the O.B.P.E.L.S. minimum standards for land boundary surveys. Any monumentation shown hereon has not been verified as being actual section, quarter section or property corners. All ownership and little information shown hereon has been provided and/or verified by others.

The location of pipeline facilities as shown hereon must be considered as approximate only. Before digging or for an exact location, please contact your state's underground utility location service.



LEGEND

C/L PROPOSED R/W	-P/-P/-P/-P/-
EXISTING PIPELINE	-P/-P/-P/-P/-
O/H POWER	-E - E - E - E -
OVERHEAD POWER	-CHP - CHP - CHP - CHP -
FENCE	-X - X - X - X -

Tall Oak Midstream
2575 Kelley Pointe Parkway, Suite 340
Edmond, OK 73013

TALL OAK
Midstream

Gateway
Gateway Services Group, LLC

80 E. 5TH ST., STE 400
EDMOND, OK 73034
OFF: (405) 285-5884
FAX: (405) 285-5886
C.A. NO. 4091 (15)
EXP. DATE 6-30-2024

EXHIBIT "A" PRELIMINARY
SOLERA OF DISCHARGE
SECTIONS 9 & 8,
T 07 N - R 13 E, I.M.,
PITTSBURG COUNTY, OKLAHOMA
RAGAN RD. (133+85) CROSSING

DRAWN BY: KMC	DATE: 06/28/22	CHK'D: CLC
GATEWAY NO.: 22-0146-P02	SCALE: AS NOTED	
LINE NO.:	DATE:	
REV. DEN.	DESCRIPTION	DATE

STATE OF OKLAHOMA
 COUNTY OF PITTSBURG
 APPLICATION FOR PERMIT
 PUBLIC SERVICE/PIPELINE CROSSING

We, the undersigned, hereby petition the Board of County Commissioners, Pittsburg County, to grant a permit for a public service, pipeline crossing, ingress and egress, or line installation as described below and in accordance with the provisions as listed.

PLEASE PRINT

PUBLIC SERVICE/PIPELINE OWNER NAME: Tall Oak Woodford, LLC

CONTACT: Brandon Burr EMAIL: bburr@talloakmidstream.com

ADDRESS: 2575 Kelley Pointe Parkway Ste. 340 PHONE: 405-562-9434

CITY: Edmond STATE: OK ZIP CODE: 73013

CONSTRUCTION COMPANY NAME: TBD

CONTACT: _____ EMAIL: _____

ADDRESS: _____ PHONE: _____

CITY: _____ STATE: _____ ZIP CODE: _____

TYPE OF INSTALLATION (Please mark all boxes that apply)				
<input type="checkbox"/> Electric	<input checked="" type="checkbox"/> Permanent Line	<input type="checkbox"/> Salt Water	<input type="checkbox"/> Residential	<input checked="" type="checkbox"/> Boring
<input checked="" type="checkbox"/> Gas	<input type="checkbox"/> Temporary Line	<input type="checkbox"/> Fresh Water	<input type="checkbox"/> Commercial	<input type="checkbox"/> Trenching
<input type="checkbox"/> Oil		<input type="checkbox"/> Other	<input type="checkbox"/> Agricultural	<input type="checkbox"/> In/Through existing culvert
<input type="checkbox"/> Water			<input type="checkbox"/> Oil/Gas Service	<input type="checkbox"/> Temporary Road
<input type="checkbox"/> Telephone			Road	<input type="checkbox"/> Cross Bridge
<input type="checkbox"/> Sewer			<input type="checkbox"/> Other	<input type="checkbox"/> Other:
<input type="checkbox"/> Other				

This permit is to erect, construct and maintain a Pipeline along, upon and across the hereinafter said county highway/road for the purpose of transporting, selling, and using natural gas.

LOCATION

Beginning at 35.110692, -95.948178 and cross freeway route Byington School Road
GPS Location (in decimals) Cross or Parallel County Road Name

Approximately 695 feet miles Northwest of Ragan Road and ending at
North, South, East, West Name of Closest Intersecting Road or Highway

35.110698 -95.947945. Embraced in Section 5 Township 7N Range 13E
GPS Location (in decimals)

PIPELINES	ELECTRIC
SIZE <u>16"</u> ALLOY/MATERIAL <u>Steel</u> WALL THICKNESS <u>.312</u> CONTENTS <u>Natural Gas</u> MFG. TEST PRESSURE <u>2610 psig</u> MAX. OPERATING PRESSURE <u>200 psig</u> WORKING PRESSURE <u>100 psig</u>	VOLTAGE _____ CONDUCTOR SIZE _____ TYPE OF STRUCTURE _____ RULING SPAN _____
COMMUNICATIONS	SERVICE ENTRANCE
WIRES/PAIRS/STRANDS _____ GAUGE _____ CABLE TYPE _____	DIAMETER OF CULVERT PIPE _____ LENGTH OF CULVERT PIPE _____

CASING
 SIZE N/A ALLOY/MATERIAL _____ WALL THICKNESS _____

FLOODPLAIN ADMINISTRATOR'S REVIEW

Upon review, I, Tawanna Cathey, Floodplain Administrator for Pittsburg County, have determined that the above-referenced public service/pipeline crossing permit:

_____ Does Does Not

fall within any floodplain.

Tawanna Cathey
 Signature, Pittsburg County Floodplain Administrator

(Administrator: Please attach a copy of the floodplain permit and receipt where permit was paid if road crossing is within a floodplain)

If granted, this permit is subject to the following conditions, requirements and covenants, to-wit, please initial that you have read each condition, requirement or covenant:

1. Applicant/contractor is aware that all road crossing permits for PITTSBURG COUNTY shall require approval from the Pittsburg County Floodplain Administrator's Office and that all permits and fees owed to the Floodplain Administrator's Office will be paid in full before approval is given by the Board of County Commissioners.

Initial: BB

2. Application for road crossing must be submitted **no later than 5 days before a meeting** of the Board of County Commissioners with a check for the amount of permit made payable to the Pittsburg County Commissioners. The petitioner/contractor shall contact the County Commissioners Office at the completion of crossing for an onsite inspection.

Initial: BB

3. The applicant must agree to hold Pittsburg County harmless for any damage or injury to persons or property caused by or resulting from the construction, maintenance, operation, or repair of the facilities on, under, or over the County right-of-way. The petitioner/contractor will be responsible for any damage resulting from deviation of the plat.

Initial: BB

4. All crossings shall be bored on blacktop/asphalt roads. Cutting may be permitted on dirt roads, ditches, or other surfaces with approval from the Board of County Commissioners. Blasting is not permitted.

Initial: BB

5. In construction pipelines or utility routes that cross county highways or roads, NO DITCH, TRENCH, OR BORING, shall be done by the applicant/contractor until approved by the Board of County Commissioners. All ditching and trenching shall be completed to the County Commissioner's specifications. Applicants, contractors or owners shall maintain crossing. (Signs, grass, brush control, etc.)

Initial: BB

6. The petitioner/contractor shall furnish all flag men, lights, barricades, and warning signs meeting all laws and regulations, including those in the "Manual on Uniform Traffic Control Devices" appropriate for the construction project. The petitioner/contractor agrees to keep the road open to traffic unless approved by the Board of County Commissioners. At the conclusion of such work, the right-of-way must be in a presentable condition.

Initial: BB

7. When notified to do so by the Board of County Commissioners, the petitioner/contractor agrees at their expense to make all changes in the facility on County right-of-way.

Initial: BB

8. Relocation – Applicant, upon 30 days written notice, agrees to relocate utilities at their expense should it interfere with County construction and/or maintenance.

Initial: BB

9. Aerial facilities – Clearance above the traffic lanes of the road at all aerial pole line crossings shall comply with applicable safety codes and will not be less than 20 feet. All poles, posts, stubs, fixtures, down guys, wires, and other appurtenances must be kept in good repair at all times and free from weeds and brush within a 5-foot area of the installation. These facilities, when paralleling the roadway, shall be single pole construction and located within 3 feet of the fence line, if a fence exists. If no fence exists, the right-of-way shall be located by an Oklahoma Registered Land Surveyor at the petitioner's expense and a copy provided to the Board prior to construction. All crossings shall be as nearly perpendicular as possible. Facility shall not interfere with the natural flow of waters or ditch.

Initial: BB

10. Underground facilities – All shall be a minimum of 5 feet below the elevation of the center line of the road, but not less than 4 feet below the bottom of the ditch. Crossings shall be encased from right-of-way line to right-of-way line and be vented off the right-of-way lines. Concrete caps of 4' wide and 6" deep may be required from edge of road to fence line. Identification markers shall be installed at each right-of-way line directly above the facility. The markers must identify the owner's name, address and telephone

number, size of facility, and emergency contact number in black with a yellow background. Marker must be at least 130 sq. inches in area and erected at a height plainly visible from the road right-of-way.

All underground electric cable crossings must be placed in a conduit and be a minimum of 4 feet below the ditch flow lines. Conduit placed beneath a roadway must be steel, HDPE, heavy-duty PVC, or fiberglass if it is designed to withstand roadway loading and is properly protected.

Steel pipelines crossing the right-of-way may be, upon approve of the Commissioner, installed without encasement if the carrier pipe material within the right-of-way is superior to the carrier pipe material outside the right-of-way by being of steel at least one grade better and of the same wall thickness, or a minimum of one wall thickness greater and of the same alloy. Pipe must be properly protected from corrosion.

Facilities such as water and sanitary sewer lines crossing the county right-of-way shall be encased. Maintenance will be performed by a method that will not disturb the through lanes or interfere with traffic. All conduits shall be sufficient to withstand roadway loadings.

Initial: BB

11. All section corners and ¼ section corners shall be protected. No pipeline or utility line shall cross an intersection diagonally. No liens shall cross within 50 feet of a ¼ section corner or 100' of a bridge.

Initial: BB

12. Owners of all facilities shall be responsible, at their own expense, for decommissioning of sites. Roads and right-of-way shall be restored to the original condition or better.

Initial: BB

13. All road crossings shall comply with all Department of Transportation and/or Oklahoma Corporation Commission pipeline safety standards rules and regulations in effect at the time of the permit.

Initial: BB

14. All pipelines made of non-metallic materials must have a tracer wire installed so the pipeline can be located from above the ground.

Initial: BB

15. Above ground water lines are temporary and shall be placed within three (3) feet of fence line or county right-of-way as not to disrupt road maintenance. All temporary water lines shall be marked or identified with a company contact number or sign at every county road crossing.

The type of temporary road crossing, either above the road surface or trenched, are at the discretion of the individual commissioner. Trenched lines shall be at sufficient depth as to not interfere with normal maintenance and shall be removed at applicant's expense. The owner, firm or company requesting the permit for temporary or permanent line(s) shall be responsible for all damages to county roads or right-of-way caused by such installation. Temporary installation permits are for a period of thirty (30) days. A new permit will be required for each thirty (30) day time period.

Initial: BB

16. Any pipe or tin horns to be installed shall be a beveled end at a 45° angle with concrete end treatments. The commissioner shall approve proper diameter of pipe.

Initial: BB

FEE SCHEDULE
(Check must accompany permit)

Floodplain Inspection Fee (if necessary).....	\$50.00 each
Floodplain Oil & Gas Pipeline Burial Permit Fee	\$300.00 each
Floodplain Permit extension	1/2 of permit fee each
(all floodplain permits expire 6 months for original permit date)	
Road Bore – Permanent	\$1,000.00 each
Domestic or livestock water 3" diameter or less	N/C
Cut or trenched permanent.....	\$1,500.00 each
Temporary lines through culverts/bridges	\$1,500.00 each
Temporary buried line, cut or trenched	\$1,500.00 each
Temporary Road Crossing Bridge	\$1,500.00 each

NOTE: FAILURE TO NOTIFY COMMISSIONERS OF HEAVY LOAD MOVEMENT OR IF A LINE OR SERVICE ENTRANCE IS PLACED IN COUNTY RIGHT-OF-WAY WITHOUT THE PROPER PERMIT(S) MAY RESULT IN A FINE UP TO \$5,000 PLUS COURT COSTS

PETITIONER/CONTRACTOR'S ATTESTMENT

I hereby attest to the accuracy of the information contained on this application. I further certify that, in my professional opinion, the facility line is installed; the drawings, plans and specifications therefore comply in all respects with the requirement of said permit.

Petitioner/Contractor Signature

7/19/2022
Date

Project Coordinator
Title

405-562-9434
Phone Number

PERMIT APPROVAL

The undersigned Board of County Commissioners, Pittsburg County, do hereby grant the crossing described in the application hereinabove set forth; provided that, the same shall be subject to the terms and conditions of the application incorporated herein by this reference.

Approved on the 8th day of August, 20 22.

Pittsburg County District # 3

Company Check# 1197 Date of Check 7/19/2022 Amount of Check \$1,000.00

COMMISSIONERS COMMENTS/CHANGES:

BOARD OF COUNTY COMMISSIONERS
PITTSBURG COUNTY, OKLAHOMA

ATTEST:



[Signature]
District 1 Commissioner

[Signature]
District 2 Commissioner

[Signature]
District 3 Commissioner

[Signature]
County Clerk

Exhibit A



Bore Profile

SECTIONS 4 & 5,
T 07 N - R 13 E, I.M.,
PITTSBURG COUNTY, OKLAHOMA

BEARINGS ARE GRID
SFC. NAD 83, OKLAHOMA SOUTH

N35°06'38.71"
W95°56'52.95"

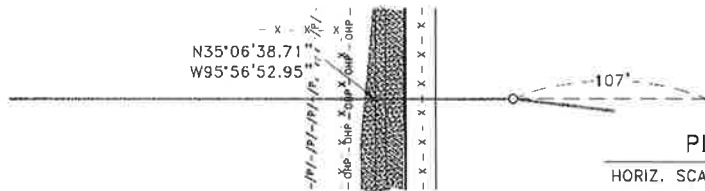

PLAN

HORIZ. SCALE: 1" = 75'

VICINITY MAP: N.T.S.

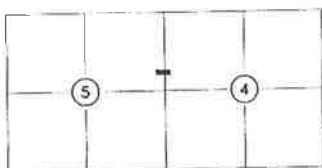

PLAN AND PROFILE SHOWING A PROPOSED TALL OAK MIDSTREAM PIPELINE CROSSING BYINGTON SCHOOL RD. BEING APPROX. 695 FEET NORTHWEST OF BYINGTON SCHOOL RD. AND RAGAN RD. JCT. AND 2017 FEET SOUTH OF THE APPROX. NE COR. SEC. 5, BETWEEN SECTIONS 4 AND 5, TWP 7N, RNG 13E, PITTSBURG COUNTY, OKLAHOMA

PROFILE

HORIZ. SCALE: 1" = 75'
VERT. SCALE: 1" = 15'

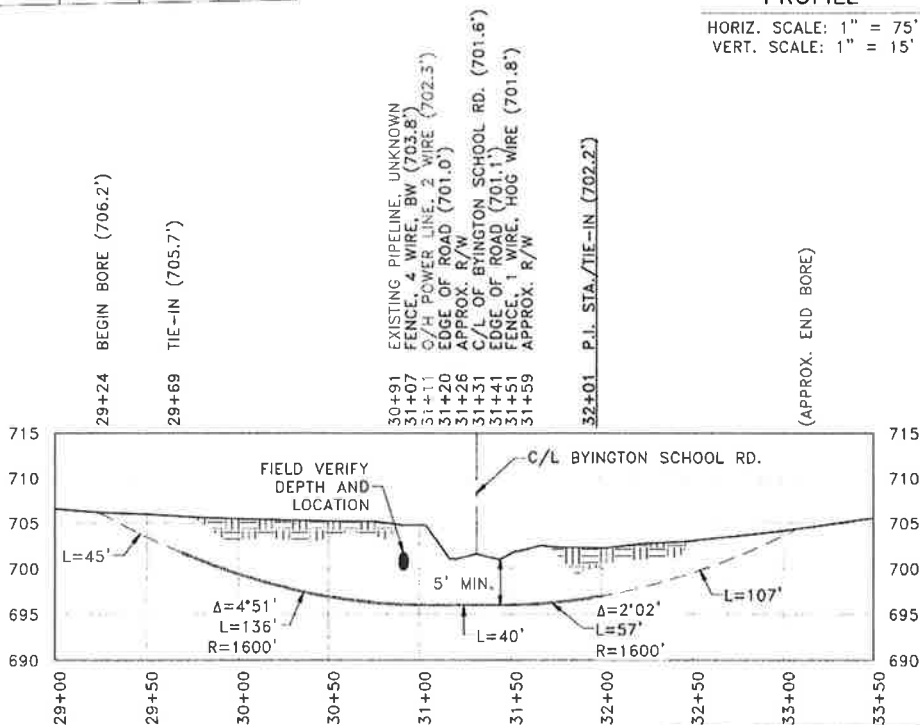

FAIRWAY LATERAL PHASE II

16" O.D. X 0.312 W.T.

ENTRY TO EXIT = 385' TIE-IN TO TIE-IN = 232'

NOTE:

This exhibit represents a proposed pipeline route for eventual easement acquisition. The footages and ties shown hereon are from lines of occupation and do not reflect actual property lines. This exhibit does not comply with the O.B.P.E.L.S. minimum standards for land boundary surveys. Any monumentation shown hereon has not been verified as being actual section, quarter section or property corners. All ownership and title information shown hereon has been provided and/or verified by others.

The location of pipeline facilities as shown hereon must be considered as approximate only. Before digging or for an exact location, please contact your state's underground utility location service.



LEGEND

C/L PROPOSED R/W	- - - - -
EXISTING PIPELINE	- P - P - P - P -
U/G POWER	- E - E - E - E -
OVERHEAD POWER	- OHP - OHP - OHP - OHP -
FENCE	- X - X - X - X -

Tall Oak Midstream
2575 Kelley Pointe Parkway, Suite 340
Edmond, OK 73013

TALL OAK
MIDSTREAM

Gateway
Gateway Services Group, LLC

80 E. 3TH ST., STE 400
EDMOND, OK 73034
OFF: (405) 283-5884
FAX: (405) 283-5886
C.A. NO. 4051 (LS)
EXP. DATE 6-30-2024

EXHIBIT "A" PRELIMINARY
FAIRWAY LATERAL PHASE II
SECTIONS 4 & 5,
T 07 N - R 13 E, I.M.,
PITTSBURG COUNTY, OKLAHOMA
BYINGTON SCHOOL RD. (31+31) CROSSING

DRAWN BY: ALC DATE: 7/12/22 CHK'D: CLC
GATEWAY NO.: 22-0078-P01 SCALE: AS NOTED
LINE NO.: AFE: 6097

REV.	DATE	DESCRIPTION	DATE