



NOTICE AND AGENDA OF REGULAR MEETING

Pursuant to the Oklahoma Open Meeting Act (25 O.S. Sec. 30), et seq.), notice is hereby given that the Board of County Commissioners, Pittsburg County, will hold a regular meeting as follows

FILED

DATE: November 18, 2024

TIME: 9:00 A.M.

PLACE: COUNTY COMMISSIONERS CONFERENCE ROOM
PITTSBURG COUNTY COURTHOUSE
115 EAST CARL ALBERT PARKWAY, ROOM 100B
MCALESTER, OKLAHOMA

NOV 15 2024

TIME 8:27

AM
PM

HOPE TRAMMELL, COUNTY CLERK

PITTSBURG COUNTY

BY _____ DEPUTY

***CONSIDERATION, DISCUSSION AND POSSIBLE ACTION TO BE TAKEN ON THE
FOLLOWING LISTED ITEMS ON THE AGENDA***

AGENDA

1. CALL MEETING TO ORDER
2. ROLL CALL: ROSS SELMAN - CHAIRMAN
CHARLIE ROGERS - VICE-CHAIRMAN
MIKE HAYNES - MEMBER
3. APPROVAL OF AGENDA
4. APPROVE/DISAPPROVE MEETING MINUTES
 - A. Regular Meeting from November 12, 2024
5. RECOGNITION OF GUESTS/PUBLIC COMMENTS

PERSONS ADDRESSING THE BOARD SHOULD STATE THEIR NAME AND ADDRESS FOR THE RECORD AND WILL BE LIMITED IN DURATION TO THREE (3) MINUTES. COMMENTS ARE LIMITED TO ITEMS ON THE AGENDA. ANY COMMENTS BY THE PUBLIC ON ITEMS NOT ON THE AGENDA CANNOT BE ACKNOWLEDGED OR DISCUSSED BUT CAN BE PLACED ON AN UPCOMING AGENDA FOR DISCUSSION AND POSSIBLE ACTION.

6. OFFICIALS – DEPARTMENT REPORT

A. COUNTY CLERK

- i. Exceeded Purchase Order

7. FISCAL TRANSACTIONS

- A. Claims and Purchase Orders
- B. Transfers
- C. Monthly Reports
- D. Blanket Purchase Orders

8. UNFINISHED BUSINESS

None

9. AGENDA ITEMS

- A. Discussion Only, Concerned Citizens to Address the Board regarding the installation of wind farms in Pittsburg County
- B. Discussion, Consideration and Possible Action to Approve Payment Application to Garland/DBS for Repairs at OSU Extension Center
- C. Discussion, Consideration and Possible Action to Approve Maintenance Renewal Contract between Miller Office Equipment and District 3
- D. Discussion, Consideration and Possible Action to Approve Subdivision Plat for Staton Landing- District 1
- E. Resolution 25-139 to Accept Donation- Sheriff's Office
- F. Resolution 25-140 to Accept Donation- Animal Shelter
- G. Resolution 25-141 to Advertise for Six Month Bids
- H. Resolution 25-142 to Declare Items Junk – Sheriff
- I. Resolution 25-143 to Declare Items Junk – Emergency Management
- J. Resolution 25-144 to Remove Items from Inventory – Emergency Management
- K. Resolution 25-145 to Deposit Check- Pittsburg County General Fund
- L. Award/Reject Bid No. 4, Southeast Expo Center Camera System

10. ROAD CROSSING PERMITS

None.

11. NEW BUSINESS

CONSIDERATION AND POSSIBLE ACTION WITH RESPECT TO ANY OTHER MATTERS NOT KNOWN ABOUT OR WHICH COULD NOT HAVE BEEN FORESEEN PRIOR TO THE POSTING OF THIS AGENDA.

12. 10:00 A.M. – PUBLIC HEARINGS

None.

13. 10:00 A.M. – BID OPENINGS

None.

14. RECESS/ADJOURNMENT

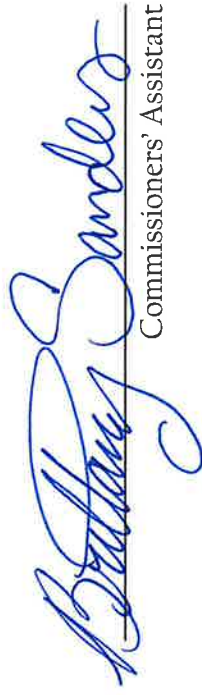
Commissioners' Assistant

**PITTSBURG COUNTY COMMISSIONER
NOVEMBER 18, 2024
MINUTES**

The Board of County Commissioners, Pittsburg County, met in regular session on November 18, 2024 at 9:00 A.M., Meeting held in County Commissioners Conference Room, after proper notice and agenda were posted indicating time and date. Agenda was posted at 8:27 A.M., November 15, 2024.

1. CALL THE MEETING TO ORDER: The meeting was called to order by Chairman Selman.

2. ROLL CALL: Ross Selman Present
 Charlie Rogers Present
 Mike Haynes Present

3. APPROVAL OF AGENDA: Rogers made a motion to approve the agenda; seconded by Haynes.

AYE: Ross Selman
 Charlie Rogers
 Mike Haynes

NAY: None.

Motion Passed.

4. APPROVE/DISAPPROVE MEETING MINUTES:

A. REGULAR MEETING FROM NOVEMBER 12, 2024: The minutes from the previous meeting, November 12, 2024 regular meeting were read. Rogers made a motion to approve the minutes; seconded by Haynes.

AYE: Ross Selman
 Charlie Rogers
 Mike Haynes

NAY: None.

Motion Passed.

5. RECOGNITION OF GUESTS/PUBLIC COMMENTS: None.

6. OFFICIALS – DEPARTMENT REPORTS:

A. COUNTY CLERK:

i. EXCEEDED PURCHASE ORDER REPORT: Selman read the exceeded purchase order report.

7. FISCAL TRANSACTIONS:

A. CLAIMS AND PURCHASE ORDERS: Selman made a motion to approve the purchase orders for payment after review and signature; seconded by Rogers.

AYE: Ross Selman
Charlie Rogers
Mike Haynes

NAY: None.

Motion Passed.

B. TRANSFERS: Selman made a motion to approve all transfers; seconded by Rogers.

AYE: Ross Selman
Charlie Rogers
Mike Haynes

NAY: None.

Motion Passed.

C. MONTHLY REPORTS: None.

D. BLANKET PURCHASE ORDERS:

DEPT	PO	AMOUNT	VENDOR
Jail	4539	\$ 500.00	Jet Tire
Jail	4540	\$ 250.00	Cintas 1 st Aid
District 2	4541	\$ 1,500.00	Kiamichi Automotive
District 2	4542	\$10,000.00	Michael A Price
District 2	4543	\$ 5,000.00	Terry Williams
District 2	4544	\$ 1,200.00	Unifirst
District 3	4545	\$ 1,500.00	Kiamichi Automotive

Selman made a motion to approve the blanket purchase orders; seconded by Rogers.

AYE: Ross Selman
Charlie Rogers
Mike Haynes

NAY: None.

Motion Passed.

8. UNFINISHED BUSINESS: None.

9. AGENDA ITEMS:

A. DISCUSSION ONLY, CONCERNED CITIZENS TO ADDRESS THE BOARD REGARDING THE INSTALLATION OF WIND FARMS IN PITTSBURG COUNTY:

Robin Brown stated that the wind farms are bad for the economy and bad for the ground and that they do not want them where they live. Brown stated that they will destroy what they have and the farm land should be preserved as farm land for their children.

Pittsburg County Commissioners Minutes
November 18, 2024
Page 3

Kevin Moss asked if the commissioners are for the windfarms. Selman stated that the Commissioners have previously signed letters of support and that he is not for or against them since they will be on private property and explained that they will bring more tax dollars into the county. Moss asked if the commissioners have lease any of their property for the wind farms. Haynes stated that he was approached but did not lease. Rogers stated that he has not spoken to anyone about leasing. Josh Mandeville stated that the has a degree in environmental safety and wants nothing to do with renewable energy they are bad for the environment. Mandeville explained a clean way for renewable energy instead of the wind mills as they have to be buried, they are not recyclable. Selman stated that he has heard pros and cons too and that he was asked to place this item on the agenda to hear from the public. Mandeville stated natural gas and petroleum products are renewable as they are finding more than is being used. Ray Alexander asked about where the substation and transmission lines. Selman stated that the company would need to answer those questions. Alexander stated that they can't all be located on private property they would also be going on county land. Selman and Rogers explained the properties that the county owns. Selman stated that it would be up to the land owners if they would be placed on their private property. Alexander stated that they will have to cross county roads and state roads. Rogers explained the county road crossing permits. Selman stated that they would have to have permission from the state to cross a state road. Alexander asked if they have already permitted these. Rogers stated no that the county hasn't even seen a map of locations. Rogers explained the board letters in 2021 for the Blanco area and 2023 in near Scipio there was no maps of the area. Rogers stated that he has spoken to some District 1 residents and that no one he has spoken to have been in contact with the companies. Loggan Winn stated that they will not increase the money for the schools that the property tax increase will lower the amount that the state will give the schools. Winn also stated that the companies do not upkeep them properly. Winn stated that the property values decrease and insurance increase in the areas where they are located. Winn also stated that they will affect people who are on the autism spectrum. Barbara Countz presented the board with picture and articles of abandoned wind farms and stated that the companies build them then move on and gave examples of the panhandle, Wetherford and Enid. R. Brown stated that they built in the Enid area and have abandoned them and that he is concerned for the wildlife in the area. Selman asked when they quit working, they don't ever fix them. Countz stated that they build them and then abandon them and there is not anyone to pay for the damages. Selman stated that he doesn't know how to legally stop them.

Senator Hamilton thanked the board for allowing the public to speak on the issue. Hamilton stated that they look like a good idea in the beginning but stated who is going to repair the roads and bridges that they damage. Hamilton said to get to the private properties where they will be placed, they have to use the state and county roads and that they will exceed the weight limits. Hamilton explained the subsidies that the companies receive federally. Hamilton stated that under the new presidency the subsidies will dry up. Hamilton asked where the electricity produces will go and why they would build here when the electricity is somewhere else. Selman stated that the county has to deal with exceeded weight limits with the oil and gas industry. Selman stated that they will have to look at what they can do legally to stop this. Winn stated that Hughes County has placed a moratorium. Chuck Sullivan stated that he has not seen what Hughes County issued and that he would need to review it. Sullivan also stated that the citizens present need to also share their information with the public. Rogers asked the Senator if he knows of a way that the county can stop this from happening. Hamilton stated that the moratorium has to do with roads and bridges to prevent the infrastructure from being damaged. Selman asked if the legislature can do anything to prevent this. Hamilton stated that the Senator from Lincoln County is working on a bill and that the bill filing deadline is December 6th. Hamilton stated that he would like a permitting process like with mining and rock quarries. Robin Brown asked about foreigners owning land. Hamilton explained the new ownership affidavit that has to accompany deeds. Daniel Dobson a former science teacher that works in the oil and gas industry the renewable energy has been driven by the government incentives and makes the electrical grid less stable. Dobson explained how they affect the power grid. Barbara Countz asked if the companies can force immanent domain. Selman stated that he is glad the legislature is looking into the issue.

Representative David Smith stated that he is against the issue as it harms the environment. Smith stated that they injure birds which allows the rodent and snake populations to increase. Smith stated that the environmental affect needs to be studied. Smith also stated that they can also affect flight paths which could cause harm to life flights. Smith stated that the companies never show up to answer any questions at these meetings. Ed Evans asked Sullivan about what McIntosh County is doing about the issue. Sullivan stated that he can't state a position as nothing has been requested of the board. Sullivan stated that the nature of government tends to be reactive not proactive. Sullivan stated that any request to the board the board will ask him to review it. Barbara Countz asked how to be proactive. Sullivan stated for them to keep doing what they are doing by presenting information. Countz asked if the public can request a moratorium. Sullivan stated that they can request an item for the agenda. Selman stated that the something at the state level would help as state law is over the county. Representative Smith stated that Rogers County made it illegal to bring wind turbines into the county and were sued and they lost the lawsuit. Smith said that most of the lease were put into place during covid but were misinformed. Loggan Winn asked if the board would be willing to come out against them. Selman said the board and the DA will need to do more studying on the issue as to what they can and can't legally do. Winn asked if the next meeting if the location could be moved to have more room for the public Sullivan explained how the meeting can be moved. Selman thanked everyone for their input.

**B. DISCUSSION, CONSIDERATION AND POSSIBLE ACTION TO APPROVE
PAYMENT TO GARLAND/DBS FOR REPAIRS AT OSU EXTENSION CENTER:**

Selman stated that the payment application is in the amount of \$60,940.00. Selman made a motion to approve the payment application; seconded by Rogers.

AYE: Ross Selman
Charlie Rogers
Mike Haynes

NAY: None.

Motion Passed.

**C. DISCUSSION, CONSIDERATION AND POSSIBLE ACTION TO APPROVE
MAINTENANCE CONTRACT BETWEEN MILLER OFFICE EQUIPMENT AND
DISTRICT 3:** Selman made a motion to approve the maintenance contract; seconded by Rogers.

AYE: Ross Selman
Charlie Rogers
Mike Haynes

NAY: None.

Motion Passed.

**D. DISCUSSION, CONSIDERATION AND POSSIBLE ACTION TO APPROVE
SUBDIVISION PLAT FOR STATION LANDING – DISTRICT 1:** Rogers made a motion to approve the plat without accepting the roads; seconded by Selman.

AYE: Ross Selman
Charlie Rogers
Mike Haynes

NAY: None.

Motion Passed.

E. RESOLUTION 25-139 TO ACCEPT DONATION – SHERIFF’S OFFICE: Selman read the resolution. Selman made a motion to approve the resolution; seconded by Rogers.

AYE: Ross Selman
Charlie Rogers
Mike Haynes

NAY: None.

Motion Passed.

F. RESOLUTION 25-140 TO ACCEPT DONATION – ANIMAL SHELTER: Selman read the resolution. Selman made a motion to approve the resolution; seconded by Rogers.

AYE: Ross Selman
Charlie Rogers
Mike Haynes

NAY: None.

Motion Passed.

G. RESOLUTION 25-141 TO ADVERTISE FOR SIX MONTH BIDS: Selman read the resolution. Selman made a motion to approve the resolution; seconded by Rogers.

AYE: Ross Selman
Charlie Rogers
Mike Haynes

NAY: None.

Motion Passed.

H. RESOLUTION 25-142 TO DECLARE ITEMS JUNK – SHERIFF: Selman read the resolution stating the following items.

DESCRIPTION	ITEM#	SERIAL/VIN#
Motorola Radio	B-533	922THS7523
Motorola Radio	B-534	922TGN1485
Motorola Radio	B-531	922THN6873
Motorola Radio	N/A	922TQQ9578
Motorola Radio	B-530	922TGO9555
Motorola Radio	B-532	922THU6519

Selman made a motion to approve the resolution; seconded by Rogers.

AYE: Ross Selman
Charlie Rogers
Mike Haynes

NAY: None.

Motion Passed.

**I. RESOLUTION 25-143 TO DECLARE ITEMS JUNK – EMERGENCY
MANAGEMENT:** Selman read the resolution stating the following items.

DESCRIPTION	ITEM#	SERIAL/VIN#
Tent	EM-634.01	N/A
Tent	EM-634.02	N/A
Tent	EM-634.03	N/A
Tent	EM-634.04	N/A
Tent	EM-634.05	N/A
Tent	EM-634.06	N/A
Tent	EM-634.07	N/A
Tent	EM-634.08	N/A
Tent	EM-634.09	N/A

Selman made a motion to approve the resolution; seconded by Rogers.

AYE: Ross Selman
Charlie Rogers
Mike Haynes

NAY: None.

Motion Passed.

**J. RESOLUTION 25-144 TO REMOVE ITEMS FROM INVENTORY – EMERGENCY
MANAGEMENT:** Rogers made a motion to table the item from the agenda; seconded by Haynes.

AYE: Ross Selman
Charlie Rogers
Mike Haynes

NAY: None.

Motion Passed.

**K. RESOLUTION 25-145 TO DEPOSIT CHECK – PITTSBURG COUNTY GENERAL
FUND:** Selman read the resolution. Selman made a motion to approve the resolution; seconded by Rogers.

AYE: Ross Selman
Charlie Rogers
Mike Haynes

NAY: None.

Motion Passed.

L. AWARD/REJECT BID NO. 4, SOUTHEAST EXPO CENTER CAMERA SYSTEM:

Selman read a letter requesting that the bids be rejected as the cost of the system is greater than expected. Selman made a motion to reject the bids; seconded by Rogers.

AYE: Ross Selman
Charlie Rogers
Mike Haynes

NAY: None.

Motion Passed.

10. ROAD CROSSING PERMITS: None.

11. NEW BUSINESS:

CONSIDERATION AND POSSIBLE ACTION WITH RESPECT TO ANY OTHER MATTERS NOT KNOWN ABOUT OR WHICH COULD NOT HAVE BEEN FORESEEN PRIOR TO THE POSTING OF THIS AGENDA: None.

12. 10:00 A.M. – PUBLIC HEARINGS: None.

13. 10:00 A.M. – BID OPENINGS: None.

14. ADJOURNMENT/RECESS: There being no further business brought before the board; Selman made a motion to sign all approve claims and adjourn; seconded by Rogers.

AYE: Ross Selman
Charlie Rogers
Mike Haynes

NAY: None.

Motion Passed. Meeting Adjourned.

Purchase Orders By Account

Fiscal Year : 2024-2025

Date Range: 11/18/2024 to 11/18/2024

PO	Warrant No.	Vendor Name	Purpose	Amount
----	-------------	-------------	---------	--------

Animal Shelter

PO	Warrant No.	Vendor Name	Purpose	Amount
1316-1-8020-2005				
004168	000256	ECOLAB INC.	KENNEL SUPPLIES	\$ 82.47
004354	000257	LOWES	MAINTENANCE SUPPLIE	\$ 109.27
004377	000258	CANON FINANCIAL SERVICES	COPIER LEASE	\$ 110.00
004442	000259	PUBLIC SERVICE CO. OF OKLAHOMA	MONTHLY SERVICE	\$ 920.80
004460	000260	MWI VET SUPPLY	VET SUPPLIES	\$ 1,409.06
004461	000261	CENTER, EWELL	VET SERVICES	\$ 700.00

Total: \$ 3,331.60

CBRI

1103-6-4200-2075				
003094	000025	DOLESE	3/4" #1 COVER CHIPS	\$ 16,459.17
003095	000026	DOLESE	5/8" #3 COVER CHIPS	\$ 14,558.32
003647	000027	DOLESE	5/8" #3 COVER CHIPS	\$ 262.50

Total: \$ 31,279.99

Econ Dev Trust

7603-4-0500-2005				
004345	000182	HERRINGSHAW WASTE MANAGEMEN	MONTHLY SERVICE	\$ 130.00
004520	000183	SHRINER CIRCUS	SECURITY DEPOSIT RET	\$ 500.00
004521	000184	BRISTOW, ALIENE	SECURITY DEPOSIT RET	\$ 100.00
004523	000185	MCCOLLOUGH, LORI	SECURITY DEPOSIT RET	\$ 100.00
004524	000186	INDIAN TERRITORY COIN CLUB	SECURITY DEPOSIT RET	\$ 100.00
004525	000187	TURGEON, GRANT	SECURITY DEPOSIT RET	\$ 50.00
004526	000188	CHOCTAW NATION CAREER DEVELOP	SECURITY DEPOSIT RET	\$ 500.00
004527	000189	MENDOZA, IGNACIA	SECURITY DEPOSIT RET	\$ 800.00
002737	000190	BANK OF AMERICA	CEILING TILES	\$ 1,883.50
003591	000191	BANK OF AMERICA	POST OFFICE BOX	\$ 364.00

Total: \$ 4,527.50

Emergency Mgmt

1212-2-2700-2005				
004369	000097	COMMUNITY EMS LLC	TRAINING	\$ 600.00
004450	000098	VYVE BROADBAND	MONTHLY SERVICE	\$ 187.38

PO Warrant No. Vendor Name Purpose Amount

Emergency Mgmt

1212-2-2700-2005

004451	000099	CANON FINANCIAL SERVICES	COPIER LEASE	\$ 225.00
004485	000100	PUBLIC SERVICE CO. OF OKLAHOMA	MONTHLY SERVICE	\$ 11.62
002982	000101	BANK OF AMERICA	SUBSCRIPTION	\$ 700.00
003167	000102	BANK OF AMERICA	LODGING	\$ 220.00
003905	000103	BANK OF AMERICA	DOOR HANDLE ETC	\$ 623.67
		Total:	\$ 2,567.67	

General

0001-1-0100-2005

004496	001646	IMAGENET CONSULTING LLC	SOFTWARE RENEWAL	\$ 4,730.25
003229	001663	BANK OF AMERICA	OFFICE SUPPLIES	\$ 110.24
003510	001664	BANK OF AMERICA	RIBBONS	\$ 11.69
		Total:	\$ 4,852.18	

0001-1-1600-2005

004429	001647	PITNEY BOWES GLOBAL FINANCIAL S	POSTAGE METER LEASE	\$ 478.29
		Total:	\$ 478.29	

0001-1-1700-2005

003703	001648	COMDATA	FUEL	\$ 36.73
		Total:	\$ 36.73	

0001-1-2200-2005

004456	001649	UNIFIRST FIRST AID CORP	FIRST AID SUPPLIES	\$ 67.61
004457	001650	AT&T MOBILITY	MONTHLY SERVICE	\$ 140.43
003516	001665	BANK OF AMERICA	OFFICE SUPPLIES	\$ 243.36
003755	001666	BANK OF AMERICA	OFFICE SUPPLIES ETC.	\$ 628.85
		Total:	\$ 1,080.25	

0001-1-3300-2005

003765	001651	WAV 11	CARD READER	\$ 1,500.00
004204	001652	ADA PAPER COMPANY	JANITORIAL SUPPLIES	\$ 123.50
004350	001653	ADA PAPER COMPANY	JANITORIAL SUPPLIES	\$ 27.95
004483	001654	VYVE BROADBAND	MONTHLY SERVICE	\$ 81.90
004516	001655	TISSDAL & O HARA	LEGAL SERVICES	\$ 123.00
004517	001656	TISSDAL & O HARA	LEGAL SERVICES	\$ 145.50
004518	001657	TISSDAL & O HARA	LEGAL SERVICES	\$ 270.00
004519	001658	TISSDAL & O HARA	LEGAL SERVICES	\$ 508.24
004528	001659	PUBLIC SERVICE CO. OF OKLAHOMA	MONTHLY SERVICE	\$ 233.85
004529	001660	UNIFIRST CORP.	JANITORIAL SUPPLIES	\$ 40.40

PO	Warrant No.	Vendor Name	Purpose	Amount
General				
	0001-1-3300-2005			
	003421	BANK OF AMERICA	MEMBERSHIP	\$ 110.00
	003917	BANK OF AMERICA	MAINTENANCE SUPPLIE	\$ 147.44
	004310	BANK OF AMERICA	ADAPTERS ETC.	\$ 119.97
			Total:	\$ 3,431.75
	0001-2-1800-2005			
	004437	EASTERN OK YOUTH SERVICES INC	JUVENILE DETENTION	\$ 1,324.98
			Total:	\$ 1,324.98
	0001-2-2700-1310			
	004452	BAUGHMAN, LEONARD C.	TRAVEL	\$ 238.00
			Total:	\$ 238.00
Health				
	1216-3-5000-1310			
	002874	KELL, NICOLE	TRAVEL	\$ 170.00
			Total:	\$ 170.00
	1216-3-5000-2005			
	004215	LOWES	LADDER ETC.	\$ 419.48
	004261	WALMART COMMUNITY CARD	HOOKS	\$ 79.38
	004370	LOWES	SCREWS ETC.	\$ 40.73
	004454	CITY OF MCALESTER	MONTHLY SERVICE	\$ 666.22
			Total:	\$ 1,205.81
Highway				
	1102-6-4100-2005			
	002678	BANK OF AMERICA	LODGING	\$ 428.00
			Total:	\$ 428.00
	1102-6-4200-2005			
	003071	BANK OF AMERICA	FRAMES	\$ 33.98
			Total:	\$ 33.98
	1102-6-6520-2005			
	002114	DOLESE	1 1/2" CRUSHER RUN	\$ 11,046.27
	002756	YELLOW HOUSE MACHINE	FILTERS	\$ 204.78

PO	Warrant No.	Vendor Name	Purpose	Amount
----	-------------	-------------	---------	--------

Highway

1102-6-6520-2005

002864	001247	YELLOW HOUSE MACHINE	FILTERS	\$ 1,558.80
003306	001248	OTA PIKEPASS CUSTOMER SERVICE C	TOLL	\$ 25.50
Total:				\$ 12,833.35

Hwy-ST

1313-6-6103-2005

003121	001071	DOLESE	5/8" #3 COVER CHIPS	\$ 5,809.85
Total:				\$ 5,809.85

1313-6-8040-2005

002638	001072	DOLESE	#4 SCREENINGS	\$ 5,558.44
002844	001073	DOLESE	#4 SCREENINGS	\$ 5,593.63
004289	001074	ASPHALT & FUEL SUPPLY	ROAD OIL	\$ 15,406.25
004346	001075	HERRINGSHAW WASTE MANAGEMEN	MONTHLY SERVICE	\$ 90.00
004378	001076	PUBLIC SERVICE CO. OF OKLAHOMA	MONTHLY SERVICE	\$ 1,176.32
004477	001077	ASPHALT & FUEL SUPPLY	ROAD OIL	\$ 15,425.00
Total:				\$ 43,249.64

1313-6-8041-2005

003285	001078	OTA PIKEPASS CUSTOMER SERVICE C	TOLL CHARGES	\$ 9.95
003366	001079	STIGLER STONE	1 1/2" ODOT BASE TYPE	\$ 6,138.65
004036	001080	YELLOW HOUSE MACHINE	BATTERY ETC	\$ 610.61
004158	001081	DOLESE	1 1/2 CRUSHER RUN	\$ 5,450.65
004301	001082	RAM INC	FUEL	\$ 1,819.90
004306	001083	UNIFIRST FIRST AID CORP	FIRST AID SUPPLIES	\$ 302.14
004374	001084	O REILLY AUTO PARTS	FILTERS	\$ 636.89
004375	001085	GOODWIN, BRENNEN	ANTIFREEZE ECT	\$ 1,093.40
004384	001086	CANON FINANCIAL SERVICES	COPIER LEASE	\$ 102.00
004385	001087	PUBLIC SERVICE CO. OF OKLAHOMA	MONTHLY SERVICE	\$ 168.84
004387	001088	PUBLIC SERVICE CO. OF OKLAHOMA	MONTHLY SERVICE	\$ 217.23
004388	001089	PUBLIC SERVICE CO. OF OKLAHOMA	MONTHLY SERVICE	\$ 92.78
004424	001090	OKLA. NATURAL GAS COMPANY	MONTHLY SERVICE	\$ 35.08
004425	001091	OKLA. NATURAL GAS COMPANY	MONTHLY SERVICE	\$ 44.58
004444	001092	AIRGAS	OXYGEN/ACETYLENE	\$ 329.79
004445	001093	RAM INC	FUEL	\$ 3,794.66
Total:				\$ 20,847.15

1313-6-8042-2005

003524	001094	PRICE, MICHAEL A	RED GRAVEL	\$ 2,540.00
003629	001095	DOLESE	5/8" #3 COVER CHIPS	\$ 3,927.47

PO	Warrant No.	Vendor Name	Purpose	Amount
Hwy-ST				
1313-6-8042-2005				
003630	001096	WARREN POWER & MACHINERY INC.	INJECTOR REPAIR	\$ 1,534.07
003993	001097	WELDON PARTS INC.	FILTERS	\$ 182.68
004020	001098	WARREN POWER & MACHINERY INC.	DOOR GLASS	\$ 869.70
004111	001099	PRICE, MICHAEL A	RED GRAVEL	\$ 2,040.00
004293	001100	WELDON PARTS INC.	CABLE	\$ 289.96
004339	001101	WELDON PARTS INC.	ALUMINUM CLEANER	\$ 101.68
004427	001102	RAM INC	DIESEL	\$ 5,355.51
004473	001103	STANDARD MACHINE & WELDING	HYDRAULIC HOSE	\$ 140.59
			Total:	\$ 16,981.66
1313-6-8043-2005				
003490	001104	DOLESE	1 1/2" CRUSHER RUN	\$ 5,450.78
004381	001105	PUBLIC SERVICE CO. OF OKLAHOMA	MONTHLY SERVICE	\$ 90.31
004382	001106	PUBLIC SERVICE CO. OF OKLAHOMA	MONTHLY SERVICE	\$ 39.42
004383	001107	PUBLIC SERVICE CO. OF OKLAHOMA	MONTHLY SERVICE	\$ 561.87
003356	001108	BANK OF AMERICA	PHONE ACCESSORIES	\$ 211.89
			Total:	\$ 6,354.27
Jail-ST				
1315-2-8034-2005				
004484	000335	PUBLIC SERVICE CO. OF OKLAHOMA	MONTHLY SERVICE	\$ 5,076.77
			Total:	\$ 5,076.77
1315-2-8034-2011				
002146	000336	CHRISTOPHER BEEENE M.D.	INMATE MEDICAL	\$ 2,000.00
004356	000337	CHRISTOPHER BEEENE M.D.	INMATE MEDICAL	\$ 2,000.00
			Total:	\$ 4,000.00
Rural Fire-ST				
1321-2-8201-2005				
003015	000397	COMDATA	FUEL	\$ 90.43
004503	000398	ADT SECURITY SERVICES	MONTHLY SERVICE	\$ 105.77
004505	000399	B & H TRUCK SERVICE LLC	FIRE TRUCK REPAIR	\$ 1,073.21
			Total:	\$ 1,269.41
1321-2-8204-2005				
004431	000400	KIAMICHI ELECTRIC COOPERATIVE	MONTHLY SERVICE	\$ 197.51
			Total:	\$ 197.51

PO	Warrant No.	Vendor Name	Purpose	Amount
Rural Fire-ST				
1321-2-8205-2005				
000311	000401	KIAMICHI AUTOMOTIVE WAREHOUSE	AUTO PARTS ETC.	\$ 520.27
002073	000402	COMDATA	FUEL	\$ 132.70
004441	000403	JAMES SUPPLIES	WELDING SUPPLIES	\$ 106.00
			Total:	\$ 758.97
1321-2-8208-2005				
004498	000404	OKLATEL COMMUNICATIONS INC	MONTHLY SERVICE	\$ 47.81
004499	000405	KIAMICHI ELECTRIC COOPERATIVE	MONTHLY SERVICE	\$ 77.00
004500	000406	RURAL WATER DIST #18	MONTHLY SERVICE	\$ 200.00
004501	000407	MIKES PEST CONTROL	PEST CONTROL	\$ 150.00
			Total:	\$ 474.81
1321-2-8212-2005				
000923	000408	PRO KILL INC.	PEST CONTROL	\$ 216.00
002972	000426	BANK OF AMERICA	CAMERA DATA PLAN	\$ 240.00
			Total:	\$ 456.00
1321-2-8216-2005				
003182	000409	REDLINE FIRE EQUIPMENT & SUPPLY	NOZZLES ETC	\$ 6,298.13
004506	000410	OKLA. STATE FIREFIGHTERS ASSOCIA	DUES	\$ 1,672.00
004508	000411	PUBLIC SERVICE CO. OF OKLAHOMA	MONTHLY SERVICE	\$ 102.41
			Total:	\$ 8,072.54
1321-2-8216-4110				
003181	000412	REDLINE FIRE EQUIPMENT & SUPPLY	PUMP ETC.	\$ 7,982.23
			Total:	\$ 7,982.23
1321-2-8218-2005				
004530	000413	OKLA. NATURAL GAS COMPANY	MONTHLY SERVICE	\$ 30.97
			Total:	\$ 30.97
1321-2-8225-2005				
004468	000414	COMMUNITY EMS LLC	TRAINING	\$ 1,200.00
004469	000415	OKLA. NATURAL GAS COMPANY	MONTHLY SERVICE	\$ 47.19
004470	000416	KIAMICHI ELECTRIC COOPERATIVE	MONTHLY SERVICE	\$ 87.20
			Total:	\$ 1,334.39
1321-2-8226-2005				
004486	000417	COMMUNITY EMS LLC	TRAINING	\$ 2,700.00
			Total:	\$ 2,700.00

PO	Warrant No.	Vendor Name	Purpose	Amount
Rural Fire-ST				
1321-2-8227-2005				
004533	000418	AT&T MOBILITY	MONTHLY SERVICE	\$ 251.81
004534	000419	AT&T MOBILITY	MONTHLY SERVICE	\$ 252.05
004535	000420	KIAMICHI ELECTRIC COOPERATIVE	MONTHLY SERVICE	\$ 293.35
004536	000421	COMMUNITY EMS LLC	TRAINING	\$ 1,500.00
			Total:	\$ 2,297.21
1321-2-8228-2005				
002263	000422	QFS LLC	HYDROSTATIC TESTING	\$ 593.28
003008	000423	KIAMICHI AUTOMOTIVE WAREHOUSE	AUTO PARTS ETC.	\$ 162.47
003031	000424	COMIDATA	FUEL	\$ 317.28
003636	000425	MILLER GARAGE DOORS	GARAGE DOOR REPAIR	\$ 1,945.00
			Total:	\$ 3,018.03
SH Commissary				
1223-2-0400-2005				
004061	000079	CUSTOM TECHNOLOGIES LLC	INHOUSE COMMISSARY	\$ 1,402.39
004174	000080	COMMISSARY EXPRESS	INHOUSE COMMISSARY	\$ 2,960.06
004368	000081	COMMISSARY EXPRESS	KIOSK FEES	\$ 130.00
			Total:	\$ 4,492.45
SH Svc Fee				
1226-2-0400-2012				
004446	000724	BEN E. KEITH OKLAHOMA	INMATE GROCERIES	\$ 3,756.36
			Total:	\$ 3,756.36
1226-2-3400-2005				
000554	000725	AIRGAS	CYLINDER LEASE	\$ 25.09
002102	000726	OK TIRE	TIRES & REPAIRS	\$ 60.00
002104	000727	O REILLY AUTO PARTS	PARTS & SHOP SUPPLIE	\$ 496.42
002115	000728	PEPSI-COLA BOTTLING CO.	INMATE WORK CREW	\$ 652.38
003046	000729	HOLMANS FAST LUBE	OIL CHANGES	\$ 797.29
003051	000730	WALMART COMMUNITY CARD	K-9 SUPPLIES	\$ 166.39
004026	000731	BOB BARKER COMPANY	MATTRESSES	\$ 2,238.60
004361	000732	AMERICAN SOLUTIONS	CAR DETAIL SUPPLIES	\$ 209.30
004364	000733	BEMAC SUPPLY	JAIL MAINTENANCE SUP	\$ 162.85
004366	000734	LOCKE HEATING & COOLING SUPPLY	JAIL MAINTENANCE WOR	\$ 199.84
004386	000735	BEN E. KEITH OKLAHOMA	JAIL KITCHEN SUPPLIES	\$ 579.26
004432	000736	T & W TIRE	TIRE ETC.	\$ 318.75
004463	000737	PUBLIC SERVICE CO. OF OKLAHOMA	MONTHLY SERVICE	\$ 46.48

SH Svc Fee

1226-2-3400-2005

004464	000738	DISCOUNT STEEL	FLAT STRAP	\$ 57.20
004465	000739	PUBLIC SERVICE CO. OF OKLAHOMA	MONTHLY SERVICE	\$ 103.51
004466	000740	CANON FINANCIAL SERVICES	COPIER LEASE	\$ 150.00
004467	000741	VYVE BROADBAND	MONTHLY SERVICE	\$ 380.61
004478	000742	ELM POINT CERAKOTE LASER	ENGRAVING	\$ 325.00
004489	000743	SERVICE OKLAHOMA	TAG & TITLE	\$ 32.00
004490	000744	T & W TIRE	TIRES ETC.	\$ 304.75
004495	000745	PRUETTS FOOD	INMATE WORK CREW ET	\$ 265.12
002823	000748	BANK OF AMERICA	OTC MEDS	\$ 274.45
003123	000749	BANK OF AMERICA	MIRROR	\$ 40.98
003157	000750	BANK OF AMERICA	HANDCUFF KEYS ETC	\$ 357.26
003235	000751	BANK OF AMERICA	UNIFORMS ETC	\$ 6.99
003322	000752	BANK OF AMERICA	FLOOR MATS	\$ 74.99
003649	000753	BANK OF AMERICA	CHAIR PARTS	\$ 26.59
			Total:	\$ 8,352.10

1226-2-3400-2030

004360	000746	COMMISSARY EXPRESS	DEBIT PHONE TIME FEE	\$ 170.00
004488	000747	PUBLIC SERVICE CO. OF OKLAHOMA	MONTHLY SERVICE	\$ 144.03
004532	000754	BANK OF AMERICA	ANNUAL SERVICE	\$ 199.99
			Total:	\$ 514.02

Grand Total: \$ 215,846.42

PITTSBURG COUNTY CLERK'S OFFICE

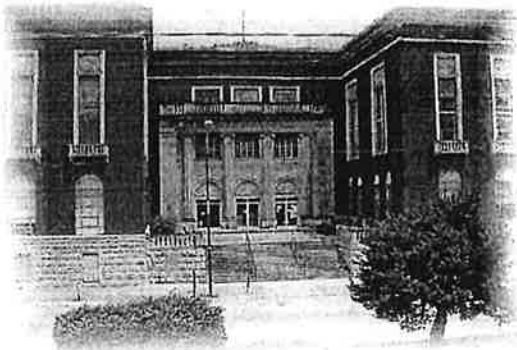

HOPE TRAMMELL, COUNTY CLERK
 PITTSBURG COUNTY COURTHOUSE, ROOM 103
 P.O. BOX 3304
 MCALESTER, OK 74502
 OFFICE 918-423-6865 FAX 918-423-7304

DEPUTIES
 BOBBI HARTSFIELD
 MONICA SENNETT
 VIRGINIA O'DELL
 GLADYS BLANSETT

DEPUTIES
 LAUREN GUTHRIE
 MIRANDA BEDFORD
 SYDNEY TARRON
 JEREMY KENNEDY
 BLAKE WILLIAMSON

Exceeded Purchase Order: As of NOVEMBER 18, 2024

PO #	AMOUNT	EXCEEDED AMOUNT	VENDOR	FUND	DEPARTMENT
311	\$500.00	\$20.27	KIAMICHI AUTOMOTIVE	FIRE SALES TAX	BLANCO FIRE DEPT.

Hope Trammell
 Pittsburg County Clerk

APPLICATION AND CERTIFICATE FOR PAYMENT

TO OWNER Pittsburg County
 115 E Carl Albert
 Parkway #1A
 McAlester, OK 74501

PROJECT: 25-OK-240837
 Pittsburg OSU Ext Center

CONTRACT FOR:

Draw: 1
APPLICATION DATE: 10/31/2024
PERIOD TO: 10/31/2024
CONTRACT DATE

FROM CONTRACTOR:
 GARLAND/DBS, INC.
 3800 E 91st Street
 Cleveland, OH 44105

PO # 000600

Invoice: 42785249035

CONTRACTOR'S APPLICATION FOR PAYMENT

Application is made for payment as shown below, in connection with the Contract. Continuation Sheet is attached.

- 1 Original Contract Sum..... \$60,940.00
- 2 Net change by Change Order..... \$0.00
- 3 Contract Sum to Date (Line 1+2)..... \$60,940.00
- 4 Total Completed & Stored Date..... \$60,940.00
- 5 Retainage..... \$0.00
- 6 Total Earned Less Retainage..... \$60,940.00
- 7 Less Previous Certification for Payment..... \$0.00
- 8 Current Payment Due..... \$60,940.00
- 9 Balance to Finish. Including Retainage..... \$0.00

CHANGE ORDER SUMMARY	Additions:	Deductions:
Total changes approved in previous months by Owner		
Total approved this Month		
TOTALS		
Net Changes by C.O.		

The undersigned Contractor certifies that to the best of the Contractor's knowledge, information and belief the Work covered by this Application for Payment has been completed in accordance with the Contract Documents, that all amounts have been paid by the Contractor for Work for which previous Certificates for Payment were issued and payments received from the Owner, and that current payment shown herein is due.

CONTRACTOR:

BY: Ren Saitz
 State of: OHIO
 County of: Cuyahoga

Date: 10/31/2024

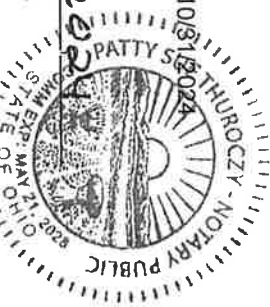

Subscribed and sworn to before me this 31 day of 10-2024
 Notary Public: Patty Saitz
 My commission expires: 5-21-2028

Owner's Certificate for Payment

In accordance with the Contract Documents, based on on-site observations and data comprising this application the Owner's Representative certifies to the Owner that to the best of the Representative's knowledge information and belief, the Work has progressed as indicated, the quality of the Work is in accordance with the Contract Documents, and the Contractor is entitled to payment of the Amount Certified.

Scope:

AMOUNT CERTIFIED:..... \$60,940.00

(Attached explanation if amount certified differs from the amount applied for. Initial all figures on this Application and on the Continuation Sheet that are changed to conform to the amount certified.)

OWNER'S REPRESENTATIVE:
 BY: [Signature]

Date: 11-18-2024

This Certificate is not negotiable. The Amount Certified is payable only to the Contractor Named herein. Issuance, payment and acceptance of payment are without prejudice to any rights of the Owner or Contractor under this Contract.

REQUEST FOR PAYMENT DETAIL

Project: 25-OK-240837 / Pittsburg OSU Ext Center Invoice: 42785249035 Draw: 1 Period Ending Date: 10/31/2024 Detail Page 2 of 2 Pages

Item ID	Description	Total Contract Amount	Previously Completed Work	Work Completed This Period	Presently Stored Materials	Completed And Stored To Date	% Comp	Balance To Finish	Retainage Balance
1-00	Labor and Materials	60,940.00		60,940.00		60,940.00	100.00		

Totals		60,940.00		60,940.00		60,940.00	100.00		
--------	--	-----------	--	-----------	--	-----------	--------	--	--



since 1895



Statement of Account

00-8943 Pittsburg County
 115 E Carl Albert
 Parkway #1A
 McAlester, OK 74501

GARLAND/DBS, INC.
 3800 E 91st Street
 Cleveland, OH 44105
 800-762-8225

Statement of Account as of 11/7/2024

Invoice	Description	Date	Charges	Credits	Retainage	Finance Charge
25-OK-240837 Pittsburg OSU Ext Center						
42785249035	Invoice	10/31/2024	60,940.00			
25-OK-240837 Pittsburg OSU Ext Center Totals:			60,940.00	0.00	0.00	0.00
Statement Totals:			60,940.00	0.00	0.00	0.00
Current	Over 30	Over 60	Over 90	Over 120	Outstanding Amount	Retainage Balance
60,940.00	0.00	0.00	0.00	0.00	60,940.00	0.00

407 E. Main
Antlers, OK 74523
(800) 522-3889 Phone
(580) 298-3335 Fax

"Serving Our Customers Since 1975"



600 N. Broadway Ave
Ada, OK 74820
(580) 332-6300 Phone
(580) 332-0107 Fax

Remit To: 900 E. Wyandotte Ave
McAlester, OK 74501
(888) 332-3431 Phone
(918) 426-3626 Fax

Pittsburg County District #3 Shop
115 E Carl Albert Pkwy Rm 100
McAlester, OK 74501

Pittsburg County District #3 Shop
1906 N 15th St
McAlester, OK 74501

Renewal Maintenance Contract Proposal
Contract # MOEC100081-08
Renewal Date Range 1/15/2025 - 1/14/2026

11/14/2024

Dear Valued Customer:

The maintenance contract for your office equipment(s) is/are scheduled for renewal. Please review the attached Renewal Maintenance Contract Proposal, fill in all blanks in the spaces below, and initial the reverse side of this agreement. If your contract needs have changed or you have any questions or concerns, please contact our Contract Department so that we may address them and better serve you. An unreturned Renewal Maintenance Contract Proposal will constitute agreement on your part.

Your Contract Renewal Rate will be \$40.13 billing Annual
Maint-Supply Incl Excl Paper/Networking

Equipment covered under this contract agreement include:

C9024	IMR-4925i	4PL00841			
Meter	Meter Group	Meter Group	Covered Copies	Overage Rate	Overage Cycle
BW-109	B/W		3,000.00	0.0095	Monthly

Miller Office Equipment thanks you for the opportunity to provide service for all of your office needs.

This is not a bill
Please Sign and Return.
Invoice to follow.

Sincerely,

Rachel McPherson
Contract Administrator
rmcpherson@milleroffice.com
Phone

Contract# MOEC100081-08

Printed Name: ROSS Selman

Signature: Ross Selman

Title: BOCC, Chairman

Date: 11/18/2024

New Purchase Order# _____

* This agreement includes and is subject to the terms and conditions on the reverse side of this document.

Miller Office Equipment

MAINTENANCE AGREEMENT

This Maintenance Agreement shall become effective upon its acceptance by MOE Systems, LLC (hereinafter referred to as Miller) on the date indicated on the face hereof.

1. Maintenance Agreement base rate charges, if applicable, are payable in advance. The payment due date for a coverage period is the first day of the coverage period specified on the face hereof. Anything herein contained to the contrary notwithstanding, Miller shall have no obligation to provide any of the services called for hereunder to customer unless customer is current in all payments made to Miller on all billings on any equipment provided by or serviced by Miller or its affiliates or subsidiaries, including but not limited to service, supply, maintenance and maintenance related billings, and equipment lease billings. Miller may charge interest at the rate of one and one-half percent (1.5%) per month on all payments overdue, and in the event of failure of payment, to pursue any available remedies at law or in equity for breach of this Agreement. In the event collection of any amount due hereunder is turned over to an attorney, buyer agrees to be responsible for all fees and expenses incurred in said effort.
2. Miller shall provide inspections as required, which may be made in conjunction with regular or emergency service calls. Inspections, as well as all service calls, shall be made during normal business hours.
3. During the terms of the Agreement, Miller will provide, depending on contract type chosen, parts which have been broken or worn through normal use, labor which is necessary for servicing and maintenance adjustments, and equipment supplies (not including paper), with no charge. This agreement shall not apply to network connectivity as it is not provided under our maintenance agreements, but rather as separate chargeable service provided at Miller's established rates.
4. All service calls under this Agreement will be made by Miller during normal business hours on the equipment described on the face hereof. Should the equipment be moved to an alternate location, there will be an adjustment to the normal maintenance base and/or copy rate as set forth by Miller. The move of equipment is not included in maintenance agreement and will be done by Miller at a rate determined by Miller based on distance from Miller's service office to new customer location via most convenient route determined by Miller. If service at a time other than during Miller's normal business hours is furnished upon customer's request, it will not be included in customer maintenance agreement and customer will be charged at Miller's established rates for labor and travel then in effect.
5. This Agreement shall not apply to service or repairs made necessary by accident, misuse, abuse, neglect, theft, riot, vandalism, lightning, electrical power failure, fire, water, or other casualty, or to repairs made necessary as a result of either service by personnel other than Miller personnel or repeated use of supplies other than supplies meeting Miller's published supply specifications for the equipment. Separate charges for repairs or replacements due to the foregoing shall be borne by the customer, at Miller's established rate for parts and labor from time to time in effect.
6. This Agreement covers only the equipment described on the face hereof and does not include any accessories listed thereon.
7. This Agreement may not be assigned by the customer.
8. This Agreement does not include applicable taxes. All taxes levied or imposed, now or hereafter, by any governmental authority shall be paid by the customer in accordance with law.
9. Standard Freight and Fuel Surcharge items are included in established Miller's maintenance price rates for contracts types that include parts and supplies. Any contracts excluding parts and/or supplies will be subject to Freight and Fuel Surcharge charges being added to supply order and service call invoices. Rush orders are not considered standard and will result in an extra fee.
10. This Agreement (consisting of the face and reverse side of this page) supersedes any and all prior oral or written maintenance agreements between the parties, and constitutes the entire agreement between the customer and Miller with respect to the service to be provided hereunder.
11. If, during the term of this Agreement or any subsequent terms, Miller is unable to obtain parts for the equipment covered under this Agreement, Miller may, at its sole discretion, terminate this Agreement and refund to the customer the prorated unused portion.
12. This Agreement shall remain in full force and effect for the coverage period noted on the face hereof. Customer's obligation to pay all charges which have accrued shall survive any termination of this Agreement. Pricing is for the first year only unless otherwise stated on the face of this Agreement contract. Changes to this contract may only be made with the consent of the customer and Miller. At the expiration of the original or any renewal term, this Agreement, with all of its terms, covenants and conditions, including this paragraph, shall be deemed to have been automatically renewed for a term of twelve (12) months and at a rate established by Miller, unless either party has given thirty (30) days prior written notice to the other of its intention to terminate this agreement as of the end of such term.

(Initial) _____

STATE OF OKLAHOMA
PITTSBURG COUNTY
RECORDED OR FILED

NOV 18 2024

PLAT OF STATON LANDING

BEING A PART OF THE W1/2 OF
SW1/4 OF SECTION 29, T-9-N, R-17-E,

BY Hope Trammell DEPUTY OF THE I.B.M., PITTSBURG COUNTY, STATE OF OKLAHOMA

THE ROADS IN STATON LANDING WILL NOT
BE MAINTAINED BY PITTSBURG COUNTY.

STATE of OKLAHOMA)
COUNTY of PITTSBURG)

Know all men by these presents:
That RICHARD STATON is the owner and the only entity to have any right, title or
interest in the land shown and described as STATON LANDING and it has caused this
plat to be prepared along with the dedication attached hereto, and is described as
follows, to-wit:

A tract of land situated in the W1/2 of the SW1/4 of Section 29, T-9-N, R-17-E,
of the I.B.M., Pittsburg County, State of Oklahoma, more particularly described as
follows: Commencing at the Northwest Corner of said W1/2 SW1/4; thence
N88°39'27"E along the North line thereof a distance of 175.00 feet to the Point of
Beginning; thence N88°34'53"E along said North line a distance of 560.92 feet;
thence S01°48'01"E a distance of 493.21 feet; thence S88°37'00"W a distance of
529.91 feet; thence N01°55'06"W parallel to the West line of said W1/2 SW1/4 a
distance of 317.85 feet; thence S89°26'01"W a distance of 29.85 feet; thence
N01°58'06"W a distance of 174.60 feet to the Point of Beginning. Said tract
contains 6.12 acres, more or less.

Witness my hands and seal this 18 day of November, 2024.
Richard Staton
RICHARD STATON, Trustee

STATE of OKLAHOMA)
COUNTY of PITTSBURG)

Before me, the undersigned, a Notary Public in and for said County and State, on
this the 18 day of November, 2024, personally appeared RICHARD
STATON, Trustee, to me known to be the identical person who executed the within
and foregoing instrument, and acknowledged to me that he executed the same as
his free hand and voluntary act and deed, for the uses and purposes therein set
forth.

Given under my hand and seal this day and year last above written.

8/14/2027
My commission expires 8/14/2027
Laura Hudson
Notary Public



STATE of OKLAHOMA)
COUNTY of PITTSBURG)

I, KEVIN E. SINGLETON, a Registered Land Surveyor in the State of Oklahoma, do
hereby certify that the plat of STATON LANDING, a subdivision in PITTSBURG County,
State of Oklahoma, represents a careful survey made under my supervision and that
all monuments shown actually exist and their positions are correctly shown. This Plat
of Survey meets Oklahoma Minimum Standards for the Practice of Land Surveying as
adopted by the Oklahoma State Board of Registration for Professional Engineers and
Land Surveyors. Executed this 14 day of November, 2024.

Kevin E. Singleton
Kevin E. Singleton, L.S. 1461
C.A. No. 7726 (expires 06/30/25)

STATE of OKLAHOMA)
COUNTY of PITTSBURG)

Before me, the undersigned, a Notary Public in and for said County and State, on
this the 14 day of Nov, 2024, personally appeared KEVIN E.
SINGLETON, Registered Land Surveyor, to me known to be the identical person who
executed the within and foregoing instrument, and acknowledged to me that he
executed the same as his free hand and voluntary act and deed, for the uses and
purposes therein set forth. Given under my hand and seal this day and year last
above written.

9-11-28
My commission expires 9-11-28
Katharine Spill
Notary Public

COUNTY TREASURER CERTIFICATE

I, Jeanie Harker do hereby certify that I am the Duly Elected, Qualified
and Acting County Treasurer of PITTSBURG County, State of Oklahoma; that the tax
records of said County shows all taxes are paid for the year of 2024 and prior
years on the land shown of the plat of STATON LANDING, a subdivision of the
County of PITTSBURG, that the required statutory security has been deposited in
office of the County Treasurer Guaranteeing payment of the current year's taxes
witness whereof: said County Treasurer has caused this instrument to be executed
this 14 day of November, 2024.

Jeanie Harker
County Treasurer

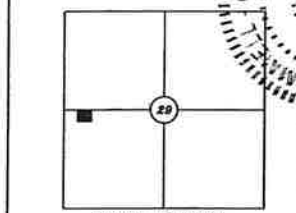
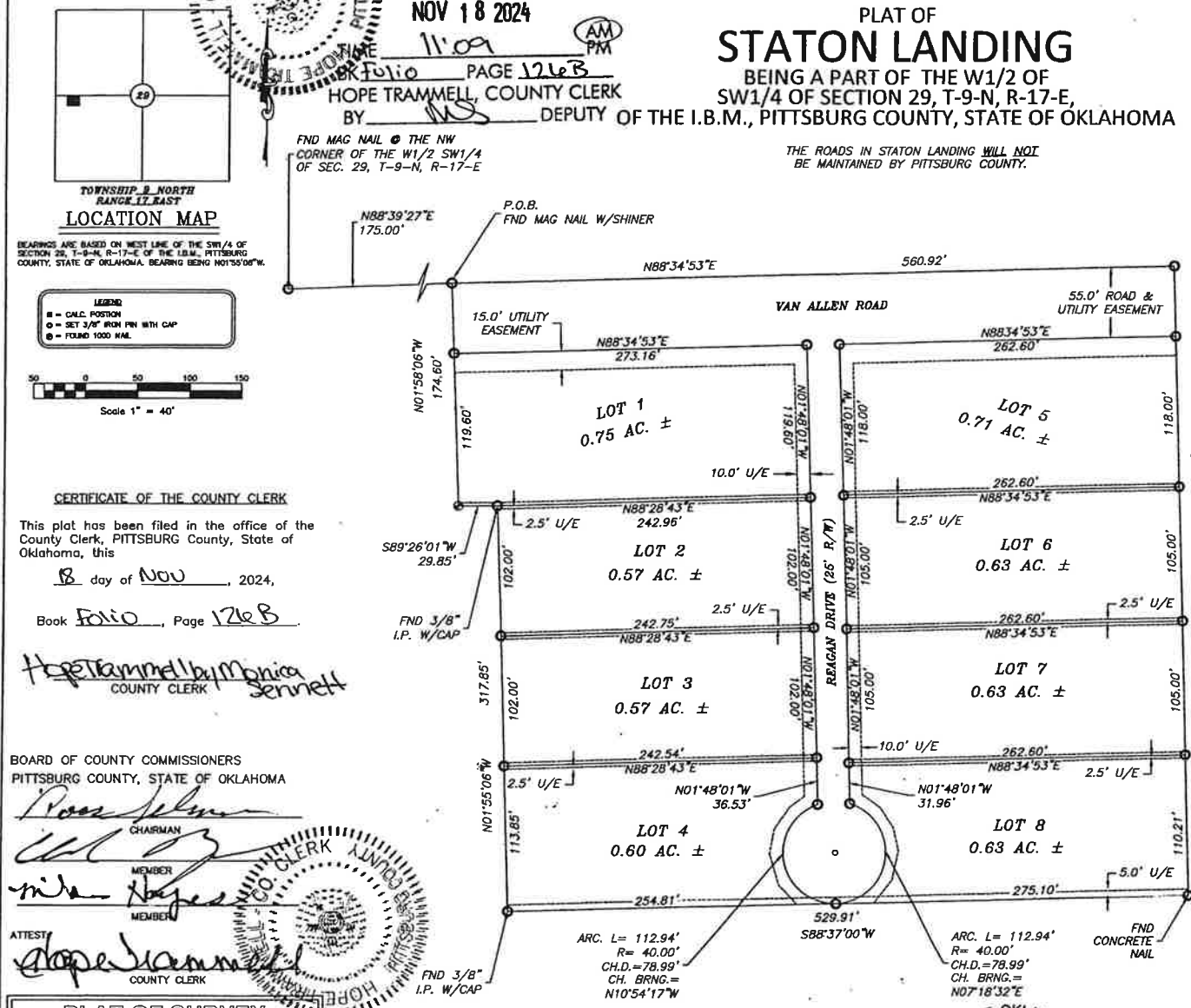

BEARINGS ARE BASED ON WEST LINE OF THE SW1/4 OF
SECTION 29, T-9-N, R-17-E OF THE I.B.M., PITTSBURG
COUNTY, STATE OF OKLAHOMA. BEARING BEING N01°55'06"W.

LEGEND
■ = CALC. POSITION
○ = SET 3/8" IRON PIN WITH CAP
● = FOUND 1000 NAIL

Scale 1" = 40'

CERTIFICATE OF THE COUNTY CLERK
This plat has been filed in the office of the
County Clerk, PITTSBURG County, State of
Oklahoma, this
18 day of Nov, 2024,
Book folio, Page 126B.

BOARD OF COUNTY COMMISSIONERS
PITTSBURG COUNTY, STATE OF OKLAHOMA
Pross Selman CHAIRMAN
Walt MEMBER
Mira Hayes MEMBER
ATTEST
Hope Trammell
COUNTY CLERK

PLAT OF SURVEY
SINGLETON SURVEYING, LLC.
418925 TEXANNA RD EUPAULA, OK 74432
(L.S. 1461, C.A. 7726, EXPIRES 06/30/25)
JOB NO.: 042420B DATE: 10/01/24

OKLAHOMA DEPARTMENT OF ENVIRONMENTAL QUALITY CERTIFICATE
The MCALAB Office of Department of Environmental Quality has
approved this plat for the use of Public water systems and On-site sewer
systems on the 18 day of Nov, 2024.
Amelia R. Spivey
Environmental Program Specialist Oklahoma Department of Environmental Quality



RESOLUTION
25-139

The Board of County Commissioners, Pittsburg County, met in regular session on Monday, November 18, 2024.

WHEREAS, the Pittsburg County Sheriff has received a donation from the Choctaw Nation of Oklahoma in the amount of \$5,000.00 to be used for Equipment for the Sheriff's Office.

WHEREAS, the Board of County Commissioners hereby accepts the donation from the Choctaw Nation of Oklahoma on behalf of the Pittsburg County Sheriff, to be deposited into the Sheriff's Office account 1235-2-0400-2208.

THEREFORE, BE IT RESOLVED, that the Board of County Commissioners, Pittsburg County, do hereby accept the donation, to be deposited into the Sheriff's Office account.

BOARD OF COUNTY COMMISSIONERS
PITTSBURG COUNTY, OKLAHOMA

ATTEST:

CHAIRMAN



VICE-CHAIRMAN



MEMBER

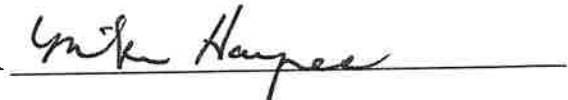

COUNTY CLERK

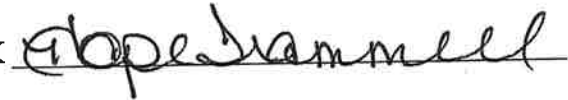

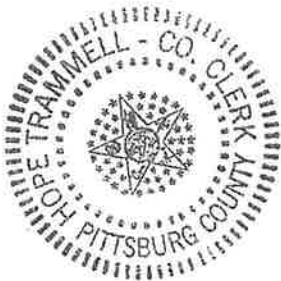

Vendor #
8701

Vendor Name
PITTSBURG COUNTY

Check #
4100292128

Check Date
10/21/2024

Check Amt
\$****5,000.00

Stub 1 of 2

CHOCTAW NATION OF OKLAHOMA

Invoice No	Invoice Date	Description	Gross	Discount	Net
AB87011101824	10/18/2024	POLICE DONATIONS	5,000.00		5,000.00

1235-2-0400-2208

DETACH AT PERFORATION BEFORE DEPOSITING CHECK

THIS CHECK IS VOID WITHOUT A RED & BLUE BORDER AND BACKGROUND PLUS A KNIGHT & FINGERPRINT WATERMARK ON THE BACK. HOLD AT ANGLE TO VIEW



CHOCTAW NATION OF OKLAHOMA
P.O. BOX 1550
DURANT, OK 74702
A/P Dept. (580) 924-8280 Ext:
2358/2359

FIRST UNITED BANK
DURANT, OK 74701
86-88/0881

NO. 4100292128

DATE
10/21/2024

PAY EXACTLY
\$****5,000.00

VOID AFTER 90 DAYS

PAY FIVE THOUSAND DOLLARS AND ZERO CENTS*****

TWO SIGNATURES REQUIRED

TO PITTSBURG COUNTY

THE
ORDER
OF

Jay Bottom
[Signature]

⑈4100292128⑈ ⑈103100881⑈ ⑈3965880⑈

RECORDER RECD U.S. PATENTS 555226, 567981A, 584114, 596403, 596404, 596405, 596406, 596407, 596408, 596409, 596410, 596411, 596412, 596413, 596414, 596415, 596416, 596417, 596418, 596419, 596420, 596421, 596422, 596423, 596424, 596425, 596426, 596427, 596428, 596429, 596430, 596431, 596432, 596433, 596434, 596435, 596436, 596437, 596438, 596439, 596440, 596441, 596442, 596443, 596444, 596445, 596446, 596447, 596448, 596449, 596450, 596451, 596452, 596453, 596454, 596455, 596456, 596457, 596458, 596459, 596460, 596461, 596462, 596463, 596464, 596465, 596466, 596467, 596468, 596469, 596470, 596471, 596472, 596473, 596474, 596475, 596476, 596477, 596478, 596479, 596480, 596481, 596482, 596483, 596484, 596485, 596486, 596487, 596488, 596489, 596490, 596491, 596492, 596493, 596494, 596495, 596496, 596497, 596498, 596499, 596500, 596501, 596502, 596503, 596504, 596505, 596506, 596507, 596508, 596509, 596510, 596511, 596512, 596513, 596514, 596515, 596516, 596517, 596518, 596519, 596520, 596521, 596522, 596523, 596524, 596525, 596526, 596527, 596528, 596529, 596530, 596531, 596532, 596533, 596534, 596535, 596536, 596537, 596538, 596539, 596540, 596541, 596542, 596543, 596544, 596545, 596546, 596547, 596548, 596549, 596550, 596551, 596552, 596553, 596554, 596555, 596556, 596557, 596558, 596559, 596560, 596561, 596562, 596563, 596564, 596565, 596566, 596567, 596568, 596569, 596570, 596571, 596572, 596573, 596574, 596575, 596576, 596577, 596578, 596579, 596580, 596581, 596582, 596583, 596584, 596585, 596586, 596587, 596588, 596589, 596590, 596591, 596592, 596593, 596594, 596595, 596596, 596597, 596598, 596599, 596600, 596601, 596602, 596603, 596604, 596605, 596606, 596607, 596608, 596609, 596610, 596611, 596612, 596613, 596614, 596615, 596616, 596617, 596618, 596619, 596620, 596621, 596622, 596623, 596624, 596625, 596626, 596627, 596628, 596629, 596630, 596631, 596632, 596633, 596634, 596635, 596636, 596637, 596638, 596639, 596640, 596641, 596642, 596643, 596644, 596645, 596646, 596647, 596648, 596649, 596650, 596651, 596652, 596653, 596654, 596655, 596656, 596657, 596658, 596659, 596660, 596661, 596662, 596663, 596664, 596665, 596666, 596667, 596668, 596669, 596670, 596671, 596672, 596673, 596674, 596675, 596676, 596677, 596678, 596679, 596680, 596681, 596682, 596683, 596684, 596685, 596686, 596687, 596688, 596689, 596690, 596691, 596692, 596693, 596694, 596695, 596696, 596697, 596698, 596699, 596700, 596701, 596702, 596703, 596704, 596705, 596706, 596707, 596708, 596709, 596710, 596711, 596712, 596713, 596714, 596715, 596716, 596717, 596718, 596719, 596720, 596721, 596722, 596723, 596724, 596725, 596726, 596727, 596728, 596729, 596730, 596731, 596732, 596733, 596734, 596735, 596736, 596737, 596738, 596739, 596740, 596741, 596742, 596743, 596744, 596745, 596746, 596747, 596748, 596749, 596750, 596751, 596752, 596753, 596754, 596755, 596756, 596757, 596758, 596759, 596760, 596761, 596762, 596763, 596764, 596765, 596766, 596767, 596768, 596769, 596770, 596771, 596772, 596773, 596774, 596775, 596776, 596777, 596778, 596779, 596780, 596781, 596782, 596783, 596784, 596785, 596786, 596787, 596788, 596789, 596790, 596791, 596792, 596793, 596794, 596795, 596796, 596797, 596798, 596799, 596800, 596801, 596802, 596803, 596804, 596805, 596806, 596807, 596808, 596809, 596810, 596811, 596812, 596813, 596814, 596815, 596816, 596817, 596818, 596819, 596820, 596821, 596822, 596823, 596824, 596825, 596826, 596827, 596828, 596829, 596830, 596831, 596832, 596833, 596834, 596835, 596836, 596837, 596838, 596839, 596840, 596841, 596842, 596843, 596844, 596845, 596846, 596847, 596848, 596849, 596850, 596851, 596852, 596853, 596854, 596855, 596856, 596857, 596858, 596859, 596860, 596861, 596862, 596863, 596864, 596865, 596866, 596867, 596868, 596869, 596870, 596871, 596872, 596873, 596874, 596875, 596876, 596877, 596878, 596879, 596880, 596881, 596882, 596883, 596884, 596885, 596886, 596887, 596888, 596889, 596890, 596891, 596892, 596893, 596894, 596895, 596896, 596897, 596898, 596899, 596900, 596901, 596902, 596903, 596904, 596905, 596906, 596907, 596908, 596909, 596910, 596911, 596912, 596913, 596914, 596915, 596916, 596917, 596918, 596919, 596920, 596921, 596922, 596923, 596924, 596925, 596926, 596927, 596928, 596929, 596930, 596931, 596932, 596933, 596934, 596935, 596936, 596937, 596938, 596939, 596940, 596941, 596942, 596943, 596944, 596945, 596946, 596947, 596948, 596949, 596950, 596951, 596952, 596953, 596954, 596955, 596956, 596957, 596958, 596959, 596960, 596961, 596962, 596963, 596964, 596965, 596966, 596967, 596968, 596969, 596970, 596971, 596972, 596973, 596974, 596975, 596976, 596977, 596978, 596979, 596980, 596981, 596982, 596983, 596984, 596985, 596986, 596987, 596988, 596989, 596990, 596991, 596992, 596993, 596994, 596995, 596996, 596997, 596998, 596999, 597000, 597001, 597002, 597003, 597004, 597005, 597006, 597007, 597008, 597009, 597010, 597011, 597012, 597013, 597014, 597015, 597016, 597017, 597018, 597019, 597020, 597021, 597022, 597023, 597024, 597025, 597026, 597027, 597028, 597029, 597030, 597031, 597032, 597033, 597034, 597035, 597036, 597037, 597038, 597039, 597040, 597041, 597042, 597043, 597044, 597045, 597046, 597047, 597048, 597049, 597050, 597051, 597052, 597053, 597054, 597055, 597056, 597057, 597058, 597059, 597060, 597061, 597062, 597063, 597064, 597065, 597066, 597067, 597068, 597069, 597070, 597071, 597072, 597073, 597074, 597075, 597076, 597077, 597078, 597079, 597080, 597081, 597082, 597083, 597084, 597085, 597086, 597087, 597088, 597089, 597090, 597091, 597092, 597093, 597094, 597095, 597096, 597097, 597098, 597099, 597100, 597101, 597102, 597103, 597104, 597105, 597106, 597107, 597108, 597109, 597110, 597111, 597112, 597113, 597114, 597115, 597116, 597117, 597118, 597119, 597120, 597121, 597122, 597123, 597124, 597125, 597126, 597127, 597128, 597129, 597130, 597131, 597132, 597133, 597134, 597135, 597136, 597137, 597138, 597139, 597140, 597141, 597142, 597143, 597144, 597145, 597146, 597147, 597148, 597149, 597150, 597151, 597152, 597153, 597154, 597155, 597156, 597157, 597158, 597159, 597160, 597161, 597162, 597163, 597164, 597165, 597166, 597167, 597168, 597169, 597170, 597171, 597172, 597173, 597174, 597175, 597176, 597177, 597178, 597179, 597180, 597181, 597182, 597183, 597184, 597185, 597186, 597187, 597188, 597189, 597190, 597191, 597192, 597193, 597194, 597195, 597196, 597197, 597198, 597199, 597200, 597201, 597202, 597203, 597204, 597205, 597206, 597207, 597208, 597209, 597210, 597211, 597212, 597213, 597214, 597215, 597216, 597217, 597218, 597219, 597220, 597221, 597222, 597223, 597224, 597225, 597226, 597227, 597228, 597229, 597230, 597231, 597232, 597233, 597234, 597235, 597236, 597237, 597238, 597239, 597240, 597241, 597242, 597243, 597244, 597245, 597246, 597247, 597248, 597249, 597250, 597251, 597252, 597253, 597254, 597255, 597256, 597257, 597258, 597259, 597260, 597261, 597262, 597263, 597264, 597265, 597266, 597267, 597268, 597269, 597270, 597271, 597272, 597273, 597274, 597275, 597276, 597277, 597278, 597279, 597280, 597281, 597282, 597283, 597284, 597285, 597286, 597287, 597288, 597289, 597290, 597291, 597292, 597293, 597294, 597295, 597296, 597297, 597298, 597299, 597300, 597301, 597302, 597303, 597304, 597305, 597306, 597307, 597308, 597309, 597310, 597311, 597312, 597313, 597314, 597315, 597316, 597317, 597318, 597319, 597320, 597321, 597322, 597323, 597324, 597325, 597326, 597327, 597328, 597329, 597330, 597331, 597332, 597333, 597334, 597335, 597336, 597337, 597338, 597339, 597340, 597341, 597342, 597343, 597344, 597345, 597346, 597347, 597348, 597349, 597350, 597351, 597352, 597353, 597354, 597355, 597356, 597357, 597358, 597359, 597360, 597361, 597362, 597363, 597364, 597365, 597366, 597367, 597368, 597369, 597370, 597371, 597372, 597373, 597374, 597375, 597376, 597377, 597378, 597379, 597380, 597381, 597382, 597383, 597384, 597385, 597386, 597387, 597388, 597389, 597390, 597391, 597392, 597393, 597394, 597395, 597396, 597397, 597398, 597399, 597400, 597401, 597402, 597403, 597404, 597405, 597406, 597407, 597408, 597409, 597410, 597411, 597412, 597413, 597414, 597415, 597416, 597417, 597418, 597419, 597420, 597421, 597422, 597423, 597424, 597425, 597426, 597427, 597428, 597429, 597430, 597431, 597432, 597433, 597434, 597435, 597436, 597437, 597438, 597439, 597440, 597441, 597442, 597443, 597444, 597445, 597446, 597447, 597448, 597449, 597450, 597451, 597452, 597453, 597454, 597455, 597456, 597457, 597458, 597459, 597460, 597461, 597462, 597463, 597464, 597465, 597466, 597467, 597468, 597469, 597470, 597471, 597472, 597473, 597474, 597475, 597476, 597477, 597478, 597479, 597480, 597481, 597482, 597483, 597484, 597485, 597486, 597487, 597488, 597489, 597490, 597491, 597492, 597493, 597494, 597495, 597496, 597497, 597498, 597499, 597500, 597501, 597502, 597503, 597504, 597505, 597506, 597507, 597508, 597509, 597510, 597511, 597512, 597513, 597514, 597515, 597516, 597517, 597518, 597519, 597520, 597521, 597522, 597523, 597524, 597525, 597526, 597527, 597528, 597529, 597530, 597531, 597532, 597533, 597534, 597535, 597536, 597537, 597538, 597539, 597540, 597541, 597542, 597543, 597544, 597545, 597546, 597547, 597548, 597549, 597550, 597551, 597552, 597553, 597554, 597555, 597556, 597557, 597558, 597559, 597560, 597561, 597562, 597563, 597564, 597565, 597566, 597567, 597568, 597569, 597570, 597571, 597572, 597573, 597574, 597575, 597576, 597577, 597578, 597579, 597580, 597581, 597582, 597583, 597584, 597585, 597586, 597587, 597588, 597589, 597590, 597591, 597592, 597593, 597594, 597595, 597596, 597597, 597598, 597599, 597600, 597601, 597602, 597603, 597604, 597605, 597606, 597607, 597608, 597609, 597610, 597611, 597612, 597613, 597614, 597615, 597616, 597617, 597618, 597619, 597620, 597621, 597622, 597623, 597624, 597625, 597626, 597627, 597628, 597629, 597630, 597631, 597632, 597633, 597634, 597635, 597636, 597637, 597638, 597639, 597640, 597641, 597642, 597643, 597644, 597645, 597646, 597647, 597648, 597649, 597650, 597651, 597652, 597653, 597654, 597655, 597656, 597657, 597658, 597659, 597660, 597661, 597662, 597663, 597664, 597665, 597666, 597667, 597668, 597669, 597670, 597671, 597672, 597673, 597674, 597675, 597676, 597677, 597678, 597679, 597680, 597681, 597682, 597683, 597684, 597685, 597686, 597687, 597688, 597689, 597690, 597691, 597692, 597693, 597694, 597695, 597696, 597697, 597698, 597699, 597700, 597701, 597702, 597703, 597704, 597705, 597706, 597707, 597708, 597709, 597710, 597711, 597712, 597713, 597714, 597715, 597716, 597717, 597718, 597719, 597720, 597721, 597722, 597723, 597724, 597725, 597726, 597727, 597728, 597729, 597730, 597731, 597732, 597733, 597734, 597735, 597736, 597737, 597738, 597739, 597740, 597741, 597742, 597743, 597744, 597745, 597746, 597747, 597748, 597749, 597750, 597751, 597752, 597753, 597754, 597755, 597756, 597757, 597758, 597759, 597760, 597761, 597762, 597763, 597764, 597765, 597766, 597767, 597768, 597769, 597770, 597771, 597772, 597773, 597774, 597775, 597776, 5

RESOLUTION
25-140

The Board of County Commissioners, Pittsburg County met in regular session on November 18, 2024.

WHEREAS, the following individual wishes to make a donation to the Pittsburg County Animal Shelter Donation Account (1235-1-8020-2202)

P.A.W.S - \$150.00

WHEREAS, the Board of County Commissioners accepts this donation on behalf of the Pittsburg County Animal Shelter, to be deposited into the Pittsburg County Animal Shelter's Donation account (1235-1-8020-2202), to be used for the items that cannot be purchased through the Maintenance & Operations accounts.

THEREFORE, BE IT RESOLVED, the Board of County Commissioners, Pittsburg County, do hereby approves this donation, to be deposited into the Pittsburg County Animal Shelter's Donation Account.

BOARD OF COUNTY COMMISSIONERS
PITTSBURG COUNTY, OKLAHOMA

ATTEST:

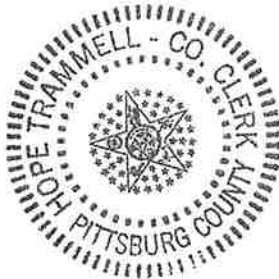

CHAIRMAN *Ben Schum*

VICE-CHAIRMAN *Chad*

MEMBER *Mike Harper*

COUNTY CLERK *Lope Trammell*

RESOLUTION #25-141
TO ADVERTISE FOR
SIX MONTH BIDS

The Board of County Commissioners, Pittsburg County, met in regular session on November 18, 2024.

WHEREAS, Pittsburg County wishes to advertise for the following materials for six-month bids:

- CRUSHED STONE
- ASPHALT SAND
- MANUFACTURED SAND
- ROAD OILS
- NEW & USED STEEL
- USED STEEL PIPE
- PLASTIC PIPE
- GRADER BLADES
- TIRES (NEW, MAJOR BRANDS ONLY) & TIRE SERVICES
- HAULING

A bid package containing complete specifications and an "Invitation to Bid" with an affidavit of non-collusion may be picked up at the County Clerk's Office, Pittsburg County Courthouse, 115 E. Carl Albert Parkway, Room 103, McAlester, OK 74501. All bids must state price of the aforesaid materials and said materials must be delivered in quantities ordered when and as needed by the Board of County Commissioners, within a six-month period, beginning January 1, 2025 and ending June 30, 2025. Each competitive bid submitted to the county must be accompanied with an affidavit for filing with competitive bid form, as required by 19 O.S. § 1501(3). No bid will be considered unless submitted on this form with affidavit completed and notarized. Place you bids in an envelope and mark it "Six Month Bids".

Sealed bids will be received by the Pittsburg County Clerk until 4:00 p.m. Friday, December 6, 2024. Bids received after 4:00 p.m. on Friday, December 6, 2024 WILL NOT BE OPENED. Bids will be opened on Monday, December 9, 2024 at 10:00 a.m. in the Board of County Commissioners Conference Room, Pittsburg County Courthouse, 115 E. Carl Albert Pkwy, McAlester, OK 74501. Contract will be awarded to the lowest or best bidder. The Board of County Commissioners, Pittsburg County, reserves the right to reject any and all bids and re-advertise.

ATTEST:



CHAIRMAN

VICE-CHAIRMAN

MEMBER

COUNTY CLERK

BOARD OF COUNTY COMMISSIONERS
PITTSBURG COUNTY, OKLAHOMA

RESOLUTION
25-142

The Board of County Commissioners of Pittsburg County met in regular session on Monday, November 18, 2024.

WHEREAS, the Sheriff's Office wishes to declare the following items junk:

ITEM#	DESCRIPTION	SERIAL/VIN#
B-533	MOTOROLA RADIO	922THS7523
B-534	MOTOROLA RADIO	922TGN1485
B-531	MOTOROLA RADIO	922THN6873
	MOTOROLA RADIO	922TGQ9578
B-530	MOTOROLA RADIO	922TGQ9555
B-532	MOTOROLA RADIO	922THU6519

WHEREAS, the above-mentioned item is no longer operable and shall be taken to the Alderson Regional Landfill for disposal.

THEREFORE, BE IT RESOLVED, the Board of County Commissioners of Pittsburg County do hereby declare the above-mentioned item junk, and disposed of at the Alderson Regional Landfill.

BOARD OF COUNTY COMMISSIONERS
PITTSBURG COUNTY, OKLAHOMA

ATTEST:

CHAIRMAN *Don Selman*

VICE-CHAIRMAN *Chad J...*

MEMBER *Mike Hayes*

COUNTY CLERK *Hope Trammell*

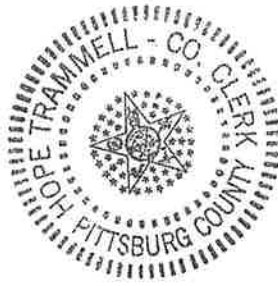

RESOLUTION
25-143

The Board of County Commissioners of Pittsburg County met in regular session on Monday, November 18, 2024.

WHEREAS, the Emergency Management wishes to declare the following items junk:

ITEM#	DESCRIPTION	SERIAL/VIN#
EM-634.01	TENT	N/A
EM-634.02	TENT	N/A
EM-634.03	TENT	N/A
EM-634.04	TENT	N/A
EM-634.05	TENT	N/A
EM-634.06	TENT	N/A
EM-634.07	TENT	N/A
EM-634.08	TENT	N/A
EM-634.09	TENT	N/A

WHEREAS, the above-mentioned items are obsolete or inoperable and shall be disposed of at the scrap metal supplier with the highest bid for the week. All other pieces that cannot be scraped shall be taken to the Alderson Regional Landfill.

THEREFORE, BE IT RESOLVED, the Board of County Commissioners of Pittsburg County do hereby declare the above-mentioned items junk, and disposed of as listed above.

BOARD OF COUNTY COMMISSIONERS
PITTSBURG COUNTY, OKLAHOMA

ATTEST:

CHAIRMAN *Ron Selman*

VICE-CHAIRMAN *Chad J...*

MEMBER *Ynk Hayes*

COUNTY CLERK *Hope Trammell*



RESOLUTION
NO. 25-145

The Board of County Commissioners, Pittsburg County, met in regular session on November 18, 2024.

WHEREAS, Pittsburg County has been issued a check from Wendy Knight as reimbursement for overpayment. The check is to be deposited into the following account as the payroll expenses came from this account.

FUND	ACCOUNT	AMOUNT
General Fund	0001-1-1400-1110	\$970.65

WHEREAS, Pittsburg County Court Clerk requests that the Board of County Commissioners approve this transaction of the deposit into the respective account.

THEREFORE BE IT RESOLVED, that the Board of County Commissioners of Pittsburg County do hereby approve the deposit of \$970.65 from Wendy Knight.

ATTEST:

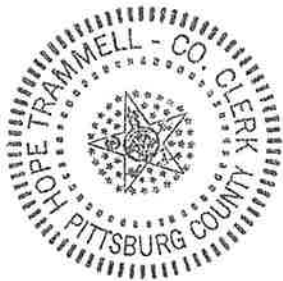

A handwritten signature in cursive script, appearing to read "Ronald...", written over a horizontal line.

CHAIRMAN

A handwritten signature in cursive script, appearing to read "Carl...", written over a horizontal line.

VICE-CHAIRMAN

A handwritten signature in cursive script, appearing to read "Mike Hayes", written over a horizontal line.

MEMBER

A handwritten signature in cursive script, appearing to read "Hope Trammell", written over a horizontal line.

COUNTY CLERK

RANDY L KNIGHT 06/04
WENDY A KNIGHT
PO BOX 2434
CLAREMORE, OK 74018-2434

86-1211/1031

2786

DATE 11/13/24

PAY TO Pittsburg County \$ 970.65
THE ORDER OF Nine hundred seventy & 65/100 DOLLARS  Security Feature
Number
Check on Back.
ADVANTAGE PLUS

 **MabreyBank**

www.mabreybank.com

MEMO Paycheck Disbursement Wendy Knight MP

⑆ 103112112⑆ ⑆449801⑆ 2786

SPECIALTY MINT



Board of County Commissioners, Pittsburg County

*Charlie Rogers
District #1*

*Mike Haynes
District #2*

*Ross Selman
District #3*

November 12, 2024

RE: Bid No. 4, Southeast Expo Center Security Camera System

The Board of County Commissioners of Pittsburg County have decided to reject all bids for the Southeast Expo Center Camera System.

While all bids met the requested specifications, our concern is that the cost of this system is too great for us to expend at this time.

At a later date this Board may decide to slim down the size of this project and re-advertise, however, at this time it is not being considered and this project shall be on hold indefinitely. Should this Board decide to re-bid, all current bidders will be sent new bid plans and specifications.

We would like to thank all those who took the time to submit bids.

Respectfully,

A handwritten signature in black ink, appearing to read "Ross Selman", with a long horizontal flourish extending to the right.

Ross Selman
Chairman